

LOCATION MAP  
SCALE: 1" = 2,000'

**DRAINAGE LEGEND**

DRAINAGE AREA BOUNDARY	
TO PATH	
LIMIT OF DISTURBANCE	
DRAINAGE AREA LABEL	

**LEGEND**

BOUNDARY LINE	
ADJOINING LOT LINE	
RIGHT-OF-WAY	
IRON PIN/CONCRETE MONUMENT	
FENCE	
SIGN	
CURBING	
BUILDING	
STORM PIPE/INLET/MANHOLE	
SANITARY PIPE/MANHOLE/CLEAN OUT	
WATER LINE/HYDRANT/VALVE	
GAS LINE & VALVE	
OVERHEAD ELECTRIC	
UNDERGROUND ELECTRIC	
UNDERGROUND COMMUNICATION	
UTILITY POLE	
LIGHT POLE	
TREES/SHRUBS	
TREE LINE	
SOILS	
WELL	

**SOIL CLASSIFICATIONS**

- BwA** BUCKINGHAM SILT LOAM  
0% - 1% SLOPES  
HYDROLOGIC SOIL GROUP: B/D
- LaB** LANSDALE LOAM  
3% - 8% SLOPES  
HYDROLOGIC SOIL GROUP: B
- UdtB** UDDERTHENTS, SHALE AND SANDSTONE  
0% - 8% SLOPES  
HYDROLOGIC SOIL GROUP: C
- UgB** URBAN LAND  
0% - 8% SLOPES  
HYDROLOGIC SOIL GROUP: C
- UusB** URBAN LAND - UDDERTHENTS, SHALE AND SANDSTONE COMPLEX  
0% - 8% SLOPES  
HYDROLOGIC SOIL GROUP: A

**NOTE:**  
\*PURSUANT TO THE REQUIREMENTS OF ACT 287 OF 1974 AND AS LAST AMENDED BY ACT 181 OF 2006 THE LOCATIONS OF ALL EXISTING UTILITIES SHOWN ON THESE PLANS HAVE BEEN DEVELOPED FROM EXISTING UTILITY RECORDS AND/OR ABOVE-GROUND EXAMINATIONS OF THE SITE. COMPLETENESS, ACCURACY, LOCATION AND DEPTH OF UNDERGROUND UTILITIES OR STRUCTURES CANNOT BE GUARANTEED. THE CONTRACTORS, AT LEAST THREE (3) DAYS PRIOR TO PERFORMING ANY EXCAVATIONS, SHALL BE RESPONSIBLE FOR VERIFYING THE LOCATIONS AND DEPTHS OF ALL UNDERGROUND FACILITIES LOCATED WITHIN THE VICINITY OF THE WORK SITE IN ACCORDANCE WITH ACT 181. (PA ONE CALL SYSTEM, INC. 1-800-242-1776)

**CALL BEFORE YOU DIG!**  
PENNSYLVANIA LAW REQUIRES 3 WORKING DAYS NOTICE FOR CONSTRUCTION PHASE AND 10 WORKING DAYS IN DESIGN STAGE - STOP CALL PENNSYLVANIA ONE CALL SYSTEM, INC.  
1-800-242-1776

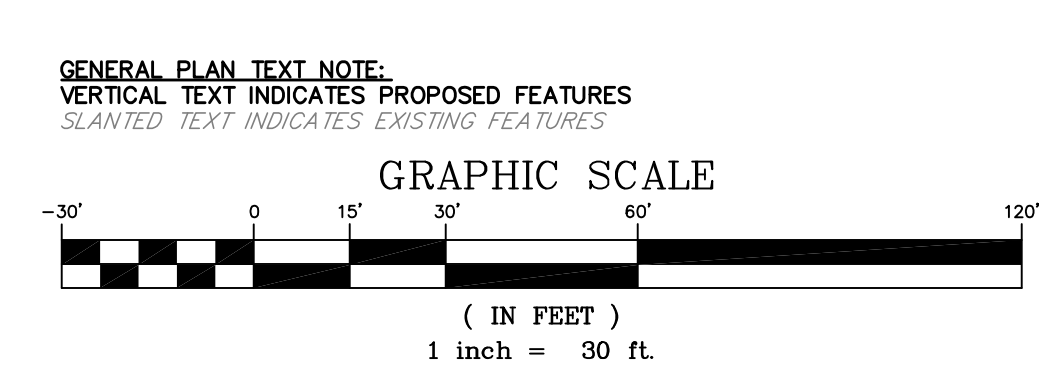

PRELIMINARY/FINAL

UPPER DUBLIN TOWNSHIP  
MUNICIPAL BUILDING

PRE-DEVELOPMENT DRAINAGE MAP

DM-1

LAND DEVELOPMENT

JOB #	2539
SCALE	1" = 30'
DATE	05/25/2023

**Terraform Engineering, LLC**  
ONE EAST BROAD STREET, SUITE 200  
BETHLEHEM, PA 18018  
PHONE: 610-666-8622  
WWW.TERRAFORMENGINEERING.COM

**GKO ARCHITECTS**  
GODSHALL KANE OROURKE ARCHITECTS, LLC  
300 BROOKSIDE AVENUE, BUILDING 18 - SUITE 150  
AMBLER, PA 19002  
W: GKOARCHITECTS.COM  
T: 215.646.2003

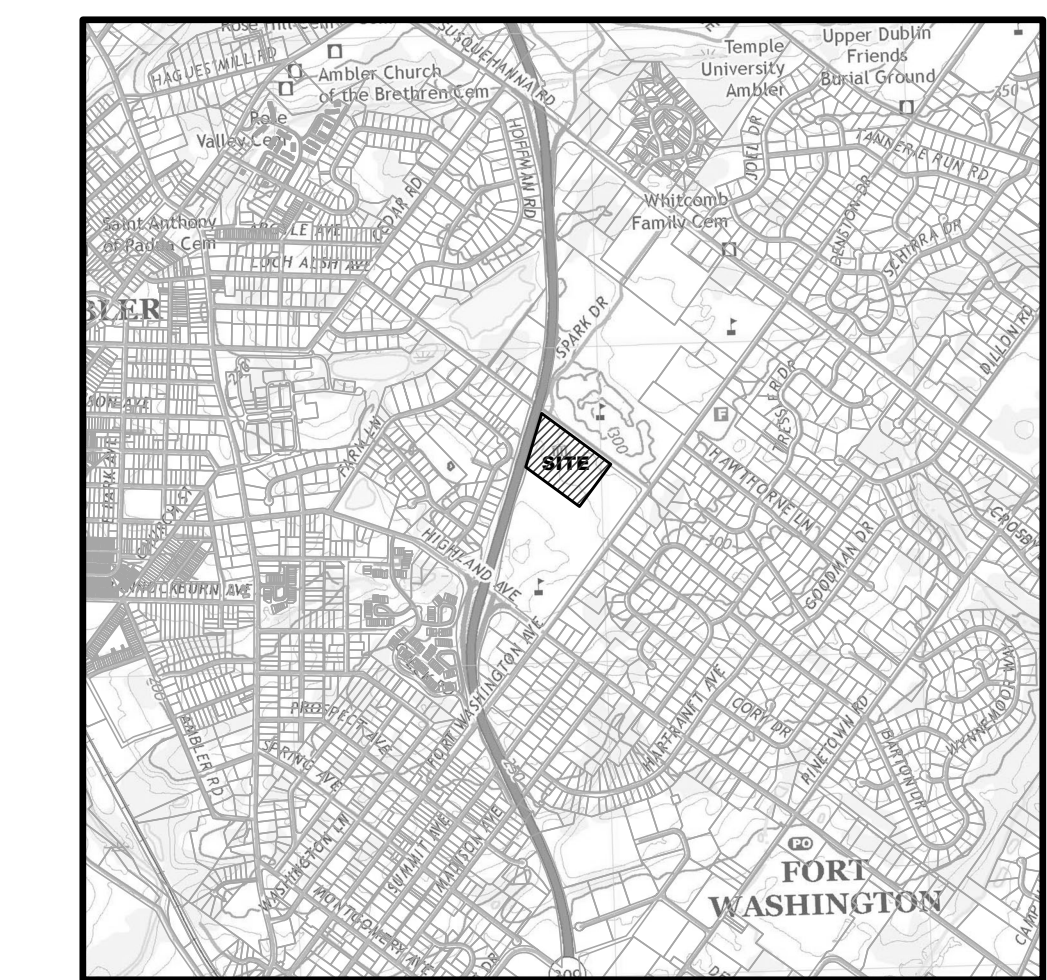
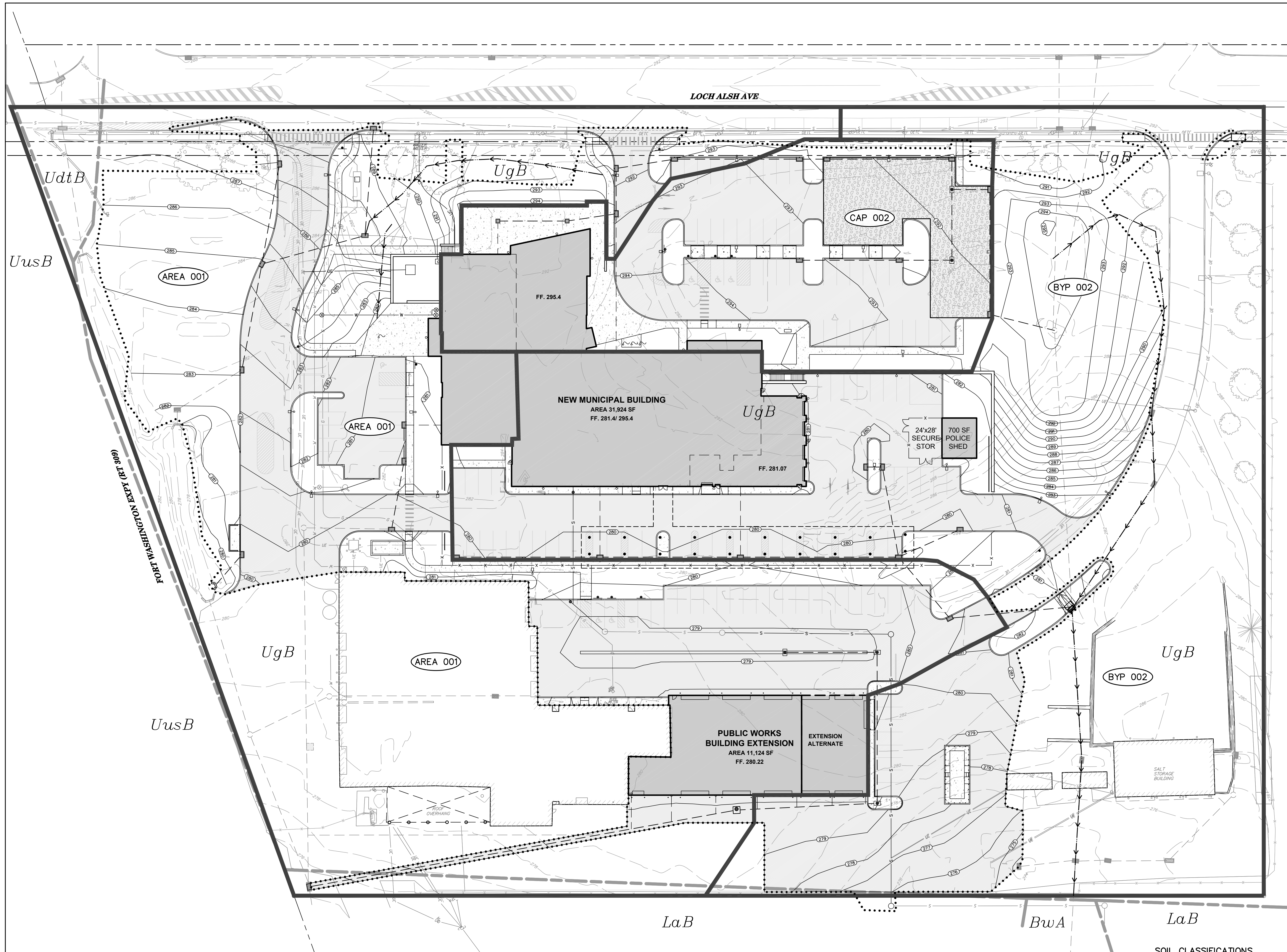

LOCATION MAP  
SCALE: 1" = 2,000'

**DRAINAGE LEGEND**

DRAINAGE AREA BOUNDARY	
Tc PATH	
LIMIT OF DISTURBANCE	
DRAINAGE AREA LABEL	

**LEGEND**

	EXISTING	PROPOSED
BOUNDARY LINE		
ADJOINING LOT LINE		
RIGHT-OF-WAY		
IRON PIN/CONCRETE MONUMENT		
FENCE		
SIGNS		
CURBING		
CONCRETE		
BUILDING		
STORM PIPE/INLET/MANHOLE		
SANITARY PIPE/MANHOLE/CLEAN OUT		
WATER LINE/HYDRANT/VALVE		
GAS LINE & VALVE		
OVERHEAD ELECTRIC		
UNDERGROUND ELECTRIC		
UNDERGROUND COMMUNICATION		
UTILITY POLE		
LIGHT POLE		
TREES/SHRUBS		
TREE LINE		
SOILS		
WELL		

**SOIL CLASSIFICATIONS**

- BwA** BUCKINGHAM SILT LOAM  
0% - 1% SLOPES  
HYDROLOGIC SOIL GROUP: B/D
- LaB** LANSDALE LOAM  
3% - 8% SLOPES  
HYDROLOGIC SOIL GROUP: B
- UdtB** UDORTHENTS, SHALE AND SANDSTONE  
0% - 8% SLOPES  
HYDROLOGIC SOIL GROUP: C
- UgB** URBAN LAND  
0% - 8% SLOPES  
HYDROLOGIC SOIL GROUP: C
- UusB** URBAN LAND-UDORTHENTS, SHALE AND SANDSTONE COMPLEX  
0% - 8% SLOPES  
HYDROLOGIC SOIL GROUP: A

**NOTE:**  
PURSUANT TO THE REQUIREMENTS OF ACT 287 OF 1974 AND AS LAST AMENDED BY ACT 181 OF 2006 THE LOCATIONS OF ALL EXISTING UTILITIES SHOWN ON THESE PLANS HAVE BEEN DEVELOPED FROM EXISTING UTILITY RECORDS AND/OR ABOVE-GROUND EXAMINATIONS OF THE SITE. COMPLETENESS, ACCURACY, LOCATION AND DEPTH OF UNDERGROUND UTILITIES OR STRUCTURES CANNOT BE GUARANTEED. THE CONTRACTORS, AT LEAST THREE (3) DAYS PRIOR TO PERFORMING ANY EXCAVATIONS, SHALL BE RESPONSIBLE FOR VERIFYING THE LOCATIONS AND DEPTHS OF ALL UNDERGROUND FACILITIES LOCATED WITHIN THE VICINITY OF THE WORK SITE IN ACCORDANCE WITH ACT 181. (PA ONE CALL SYSTEM, INC. 1-800-242-1776)

**CALL BEFORE YOU DIG!**  
PENNSYLVANIA LAW REQUIRES 3 WORKING DAYS NOTICE FOR CONSTRUCTION PHASE AND 10 WORKING DAYS IN DESIGN STAGE - STOP CALL PENNSYLVANIA ONE CALL SYSTEM, INC.  
1-800-242-1776

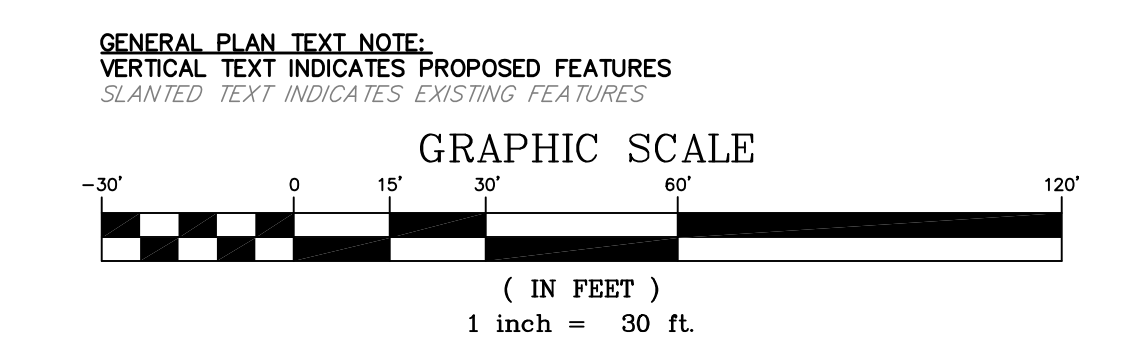

PRELIMINARY/FINAL

UPPER DUBLIN TOWNSHIP

MUNICIPAL BUILDING

REVISIONS

THIS DOCUMENT HAS BEEN PRODUCED BY GKO, BUT MAY BE PREPARED BY AN UNLICENSED PERSON OR FIRM.

SHEET TITLE

**POST-DEVELOPMENT DRAINAGE MAP**

SHEET#

**DM-2**

LAND DEVELOPMENT

JOB # 2539  
SCALE 1" = 30'  
DATE 05/25/2023

**Terraform Engineering, LLC**  
ONE EAST BROAD STREET, SUITE 200  
BETHLEHEM, PA 18018  
PHONE: 610-666-8822  
WWW.TERRAFORMENGINEERING.COM

**GODSHALL KANE OROURKE ARCHITECTS, LLC**  
300 BROOKSIDE AVENUE  
BUILDING 18 - SUITE 150  
AMBLER, PA 19002  
W: GKORCHITECTS.COM  
T: 215.646.2003

**GKO ARCHITECTS**

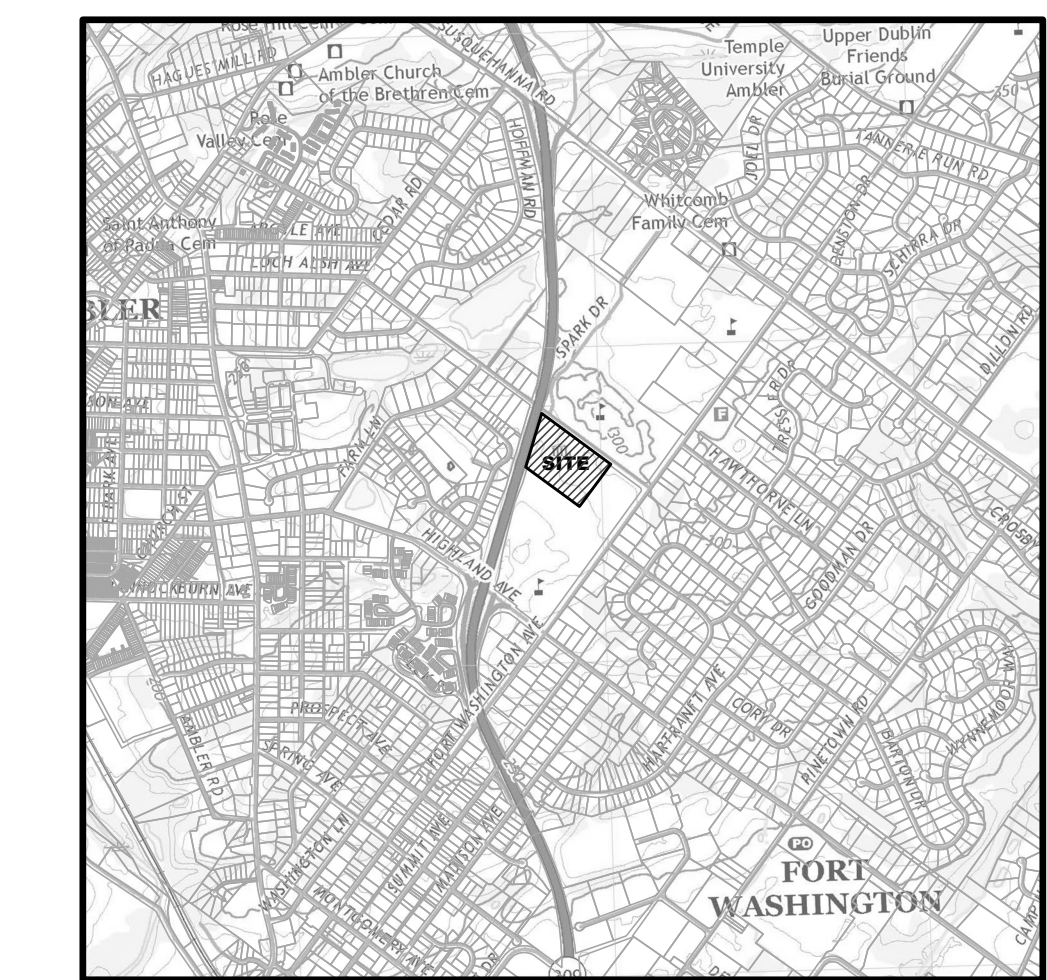
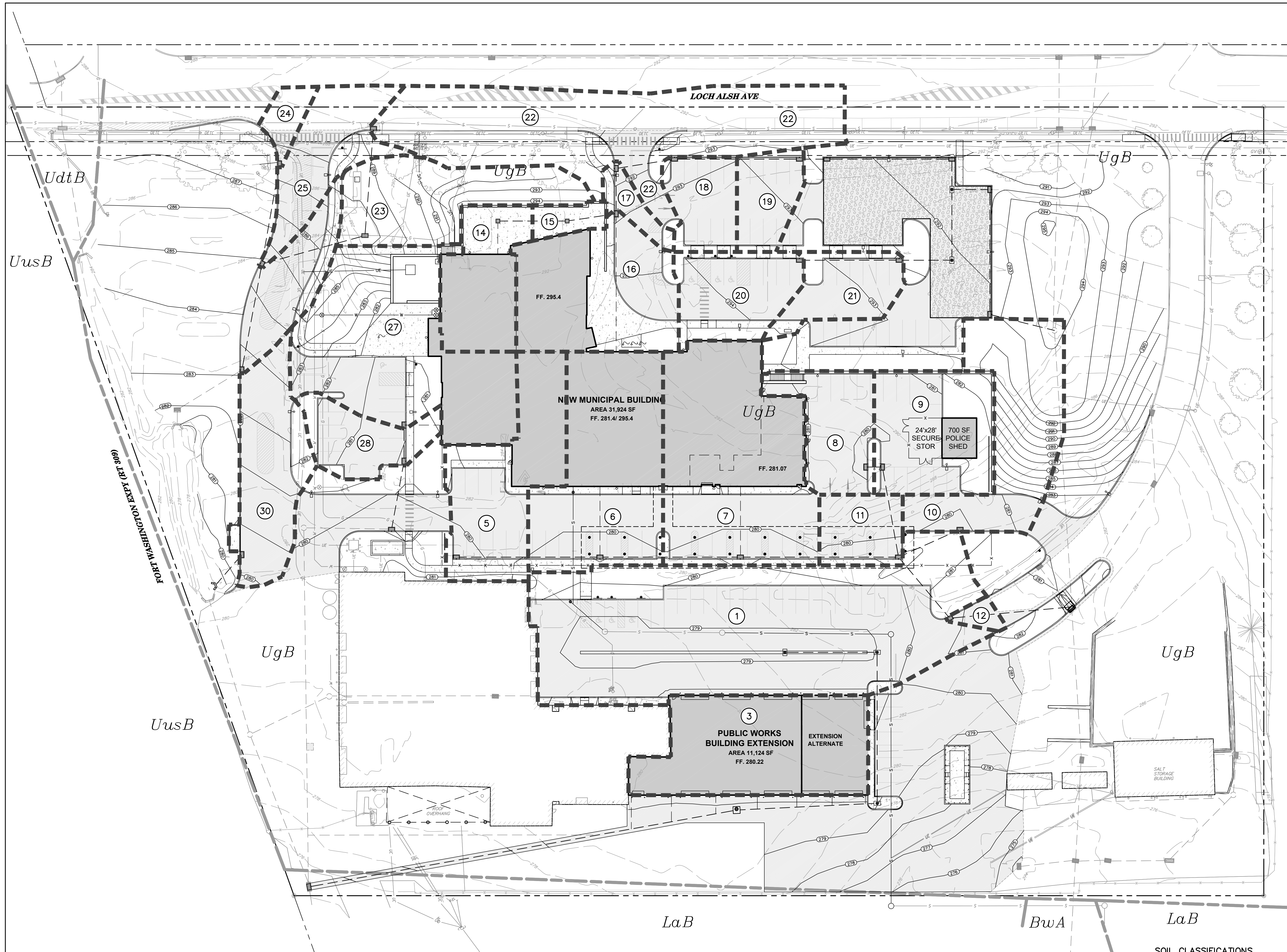

LOCATION MAP  
SCALE: 1" = 2,000'

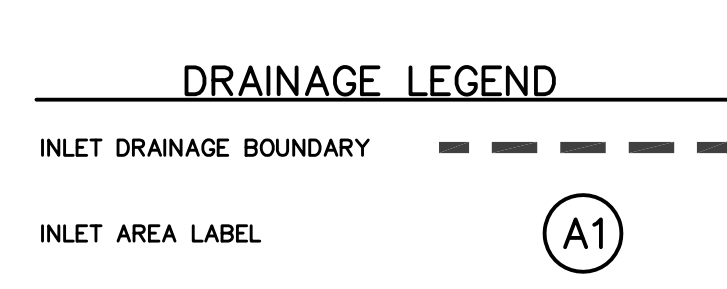

LEGEND	
EXISTING	PROPOSED
BOUNDARY LINE	---
ADJOINING LOT LINE	---
RIGHT-OF-WAY	---
IRON PIN/CONCRETE MONUMENT	IP / CONC MON
FENCE	X / CONC MON
SIGNS	S
CURBING	DEP
CONCRETE	CONC
BUILDING	BLDG
STORM PIPE/INLET/MANHOLE	SP / INLET / MH
SANITARY PIPE/MANHOLE/CLEAN OUT	SP / MH / CO
WATER LINE/HYDRANT/VALVE	WV / HYDRANT / VALVE
GAS LINE & VALVE	G / VALVE
OVERHEAD ELECTRIC	OE
UNDERGROUND ELECTRIC	UE
UNDERGROUND COMMUNICATION	UC
UTILITY POLE	UP
LIGHT POLE	LP
TREES/SHRUBS	TREE / SHRUB
TREE LINE	TL
SOILS	S
WELL	W

**SOIL CLASSIFICATIONS**

- BwA** BUCKINGHAM SILT LOAM  
0% - 1% SLOPES  
HYDROLOGIC SOIL GROUP: B/D
- LaB** LANSDALE LOAM  
3% - 8% SLOPES  
HYDROLOGIC SOIL GROUP: B
- UdtB** UDORTHENTS, SHALE AND SANDSTONE  
0% - 8% SLOPES  
HYDROLOGIC SOIL GROUP: C
- UgB** URBAN LAND  
0% - 8% SLOPES  
HYDROLOGIC SOIL GROUP: C
- UusB** URBAN LAND-UDORTHENTS, SHALE AND SANDSTONE COMPLEX  
0% - 8% SLOPES  
HYDROLOGIC SOIL GROUP: A

**NOTE:**  
PURSUANT TO THE REQUIREMENTS OF ACT 287 OF 1974 AND AS LAST AMENDED BY ACT 181 OF 2006 THE LOCATIONS OF ALL EXISTING UTILITIES SHOWN ON THESE PLANS HAVE BEEN DEVELOPED FROM EXISTING UTILITY RECORDS AND/OR ABOVE-GROUND EXAMINATIONS OF THE SITE. COMPLETENESS, ACCURACY, LOCATION AND DEPTH OF UNDERGROUND UTILITIES OR STRUCTURES CANNOT BE GUARANTEED. THE CONTRACTORS, AT LEAST THREE (3) DAYS PRIOR TO PERFORMING ANY EXCAVATIONS, SHALL BE RESPONSIBLE FOR VERIFYING THE LOCATIONS AND DEPTHS OF ALL UNDERGROUND FACILITIES LOCATED WITHIN THE VICINITY OF THE WORK SITE IN ACCORDANCE WITH ACT 181. (PA ONE CALL SYSTEM, INC. 1-800-242-1776)

CALL BEFORE YOU DIG!  
PENNSYLVANIA LAW REQUIRES 3 WORKING DAYS NOTICE FOR CONSTRUCTION PHASE AND 10 WORKING DAYS IN DESIGN STAGE - STOP CALL PENNSYLVANIA ONE CALL SYSTEM, INC.  
1-800-242-1776

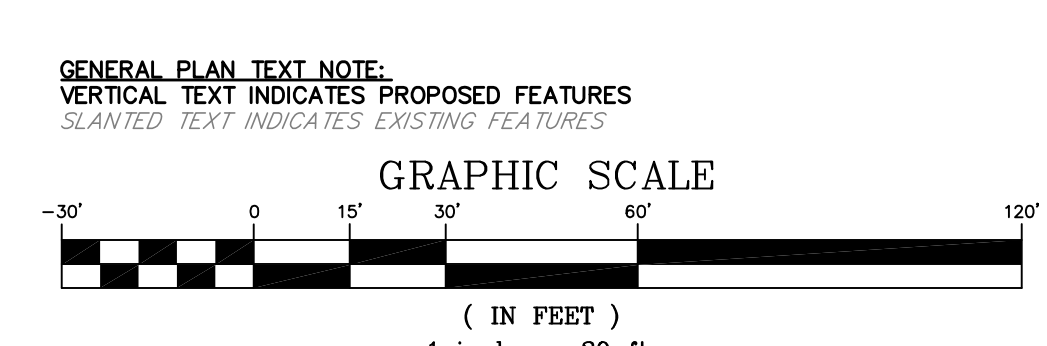

**GENERAL PLAN TEXT NOTE:**  
VERTICAL TEXT INDICATES PROPOSED FEATURES  
SLANTED TEXT INDICATES EXISTING FEATURES

PRELIMINARY/FINAL

UPPER DUBLIN TOWNSHIP

MUNICIPAL BUILDING

REVISIONS

REVISIONS

REVISIONS

REVISIONS

REVISIONS

REVISIONS

REVISIONS

REVISIONS

REVISIONS

REVISIONS

REVISIONS

REVISIONS

REVISIONS

REVISIONS

REVISIONS

REVISIONS

REVISIONS

REVISIONS

REVISIONS

REVISIONS

REVISIONS

REVISIONS

REVISIONS

REVISIONS

REVISIONS

REVISIONS

REVISIONS

REVISIONS

REVISIONS

REVISIONS

REVISIONS

REVISIONS

REVISIONS

REVISIONS

REVISIONS

REVISIONS

REVISIONS

REVISIONS

REVISIONS

REVISIONS

REVISIONS

REVISIONS

REVISIONS

REVISIONS

REVISIONS

REVISIONS

REVISIONS

REVISIONS

REVISIONS

REVISIONS

REVISIONS

REVISIONS

REVISIONS

REVISIONS

REVISIONS

REVISIONS

REVISIONS

REVISIONS

REVISIONS

REVISIONS

REVISIONS

REVISIONS

REVISIONS

REVISIONS

REVISIONS

REVISIONS

REVISIONS

REVISIONS

REVISIONS

REVISIONS

REVISIONS

REVISIONS

REVISIONS

REVISIONS

REVISIONS

REVISIONS

REVISIONS

REVISIONS

REVISIONS

REVISIONS

REVISIONS

REVISIONS

REVISIONS

REVISIONS

REVISIONS

REVISIONS

REVISIONS

REVISIONS

REVISIONS

REVISIONS

REVISIONS

REVISIONS

REVISIONS

REVISIONS

REVISIONS

REVISIONS

REVISIONS

REVISIONS

REVISIONS

REVISIONS

REVISIONS

REVISIONS

REVISIONS

REVISIONS

REVISIONS

REVISIONS

REVISIONS

REVISIONS

REVISIONS

REVISIONS

REVISIONS

REVISIONS

REVISIONS

REVISIONS

REVISIONS

REVISIONS

REVISIONS

REVISIONS

REVISIONS

REVISIONS

REVISIONS

REVISIONS

REVISIONS

REVISIONS

REVISIONS

REVISIONS

REVISIONS

REVISIONS

REVISIONS

REVISIONS

REVISIONS

REVISIONS

REVISIONS

REVISIONS

REVISIONS

REVISIONS

REVISIONS

REVISIONS

REVISIONS

REVISIONS

REVISIONS

REVISIONS

REVISIONS

REVISIONS

REVISIONS

REVISIONS

REVISIONS

REVISIONS

REVISIONS

REVISIONS

REVISIONS

REVISIONS

REVISIONS

REVISIONS

REVISIONS

REVISIONS

REVISIONS

REVISIONS

REVISIONS

REVISIONS

REVISIONS

REVISIONS

REVISIONS

REVISIONS

REVISIONS

REVISIONS

REVISIONS

REVISIONS

REVISIONS

REVISIONS

REVISIONS

REVISIONS

REVISIONS

REVISIONS

REVISIONS

REVISIONS

REVISIONS

REVISIONS

REVISIONS

REVISIONS

REVISIONS

REVISIONS

REVISIONS

REVISIONS

REVISIONS

REVISIONS

REVISIONS

REVISIONS

REVISIONS

REVISIONS

REVISIONS

REVISIONS

REVISIONS

REVISIONS

REVISIONS

REVISIONS

REVISIONS

REVISIONS

REVISIONS

REVISIONS

REVISIONS

REVISIONS

REVISIONS

REVISIONS

REVISIONS

REVISIONS

REVISIONS

REVISIONS

REVISIONS

REVISIONS

REVISIONS

REVISIONS

REVISIONS

REVISIONS

REVISIONS

REVISIONS

REVISIONS

REVISIONS

REVISIONS

REVISIONS

REVISIONS

REVISIONS

REVISIONS

REVISIONS

REVISIONS

REVISIONS

REVISIONS

REVISIONS

REVISIONS

REVISIONS

REVISIONS

REVISIONS

REVISIONS

REVISIONS

REVISIONS

REVISIONS

REVISIONS

REVISIONS

REVISIONS

REVISIONS

REVISIONS

REVISIONS

REVISIONS

REVISIONS

REVISIONS

REVISIONS

REVISIONS

REVISIONS