

SOIL CLASSIFICATIONS

- BwA** BUCKINGHAM SILT LOAM
0% - 1% SLOPES
HYDROLOGIC SOIL GROUP: B/D
- LaB** LANSDALE LOAM
3% - 8% SLOPES
HYDROLOGIC SOIL GROUP: B
- UdtB** UDDERTHENTS, SHALE AND SANDSTONE
0% - 8% SLOPES
HYDROLOGIC SOIL GROUP: C
- UgB** URBAN LAND
0% - 8% SLOPES
HYDROLOGIC SOIL GROUP: C
- UusB** URBAN LAND-UDDERTHENTS, SHALE AND SANDSTONE COMPLEX
0% - 8% SLOPES
HYDROLOGIC SOIL GROUP: A

NOTE:
 *PURSUANT TO THE REQUIREMENTS OF ACT 287 OF 1974 AND AS LAST AMENDED BY ACT 181 OF 2006 THE LOCATIONS OF ALL EXISTING UTILITIES SHOWN ON THESE PLANS HAVE BEEN DEVELOPED FROM EXISTING UTILITY RECORDS AND/OR ABOVE-GROUND EXAMINATIONS OF THE SITE. COMPLETENESS, ACCURACY, LOCATION AND DEPTH OF UNDERGROUND UTILITIES OR STRUCTURES CANNOT BE GUARANTEED. THE CONTRACTORS, AT LEAST THREE (3) DAYS PRIOR TO PERFORMING ANY EXCAVATIONS, SHALL BE RESPONSIBLE FOR VERIFYING THE LOCATIONS AND DEPTHS OF ALL UNDERGROUND FACILITIES LOCATED WITHIN THE VICINITY OF THE WORK SITE IN ACCORDANCE WITH ACT 181. (PA ONE CALL SYSTEM, INC. 1-800-242-1776)

CALL BEFORE YOU DIG!
 PENNSYLVANIA LAW REQUIRES 3 WORKING DAYS NOTICE FOR CONSTRUCTION PHASE AND 10 WORKING DAYS IN DESIGN STAGE - STOP CALL PENNSYLVANIA ONE CALL SYSTEM, INC.
 1-800-242-1776

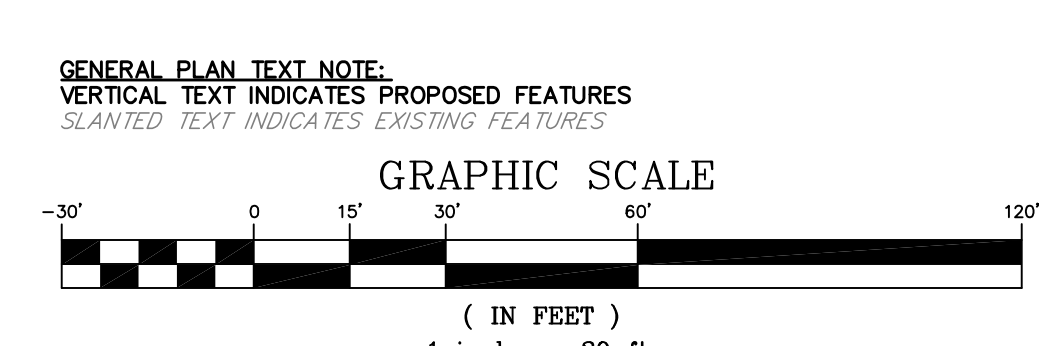

Terraform Engineering, LLC
 ONE EAST BROAD STREET, SUITE 200
 BETHLEHEM, PA 18018
 PHONE: 610-666-8622
 WWW.TERRAFORMENGINEERING.COM

GODSHALL KANE OROURKE ARCHITECTS, LLC
 300 BROOKSIDE AVENUE, BUILDING 18 - SUITE 150
 AMBLER, PA 19002
 T: 215.646.2003
 W: GKORARCHITECTS.COM



PRELIMINARY/FINAL
 UPPER DUBLIN TOWNSHIP
 MUNICIPAL BUILDING

PRE-DEVELOPMENT DRAINAGE MAP

DM-1

LAND DEVELOPMENT
 JOB # 2539
 SCALE 1" = 30'
 DATE 05/25/2023

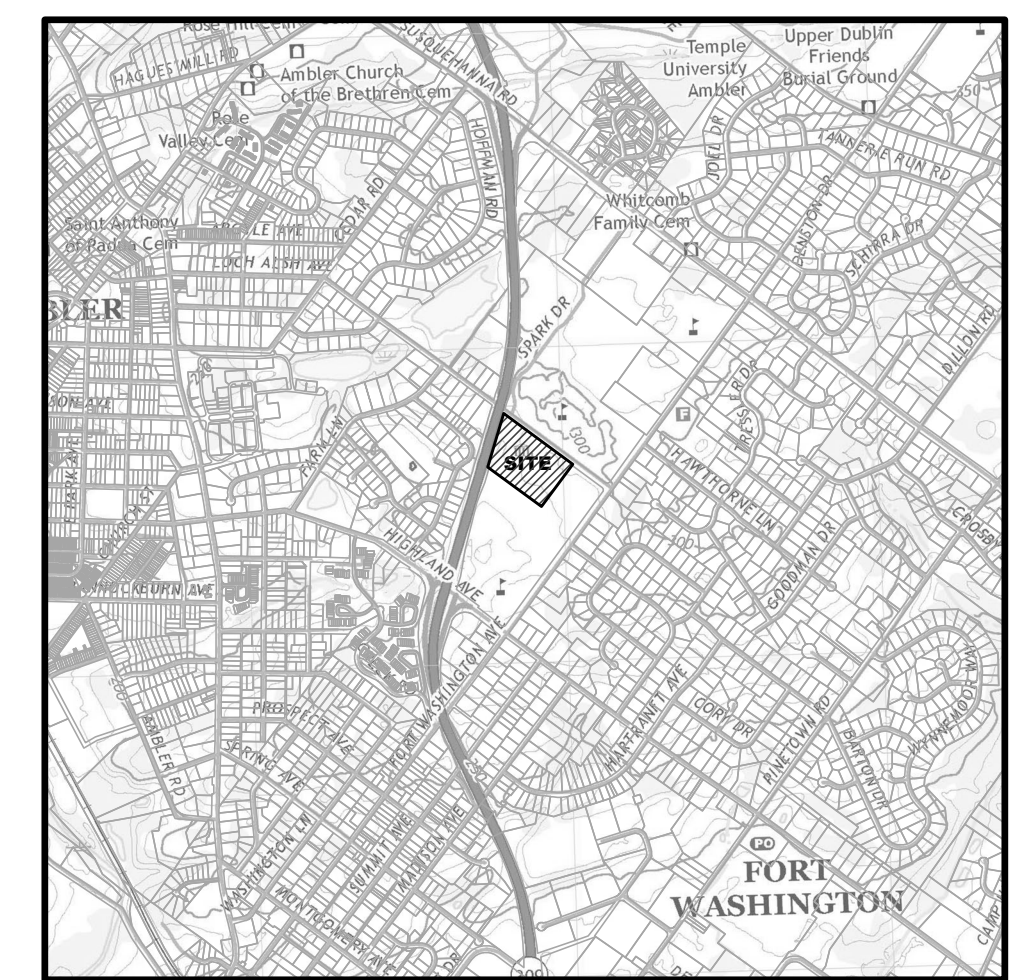
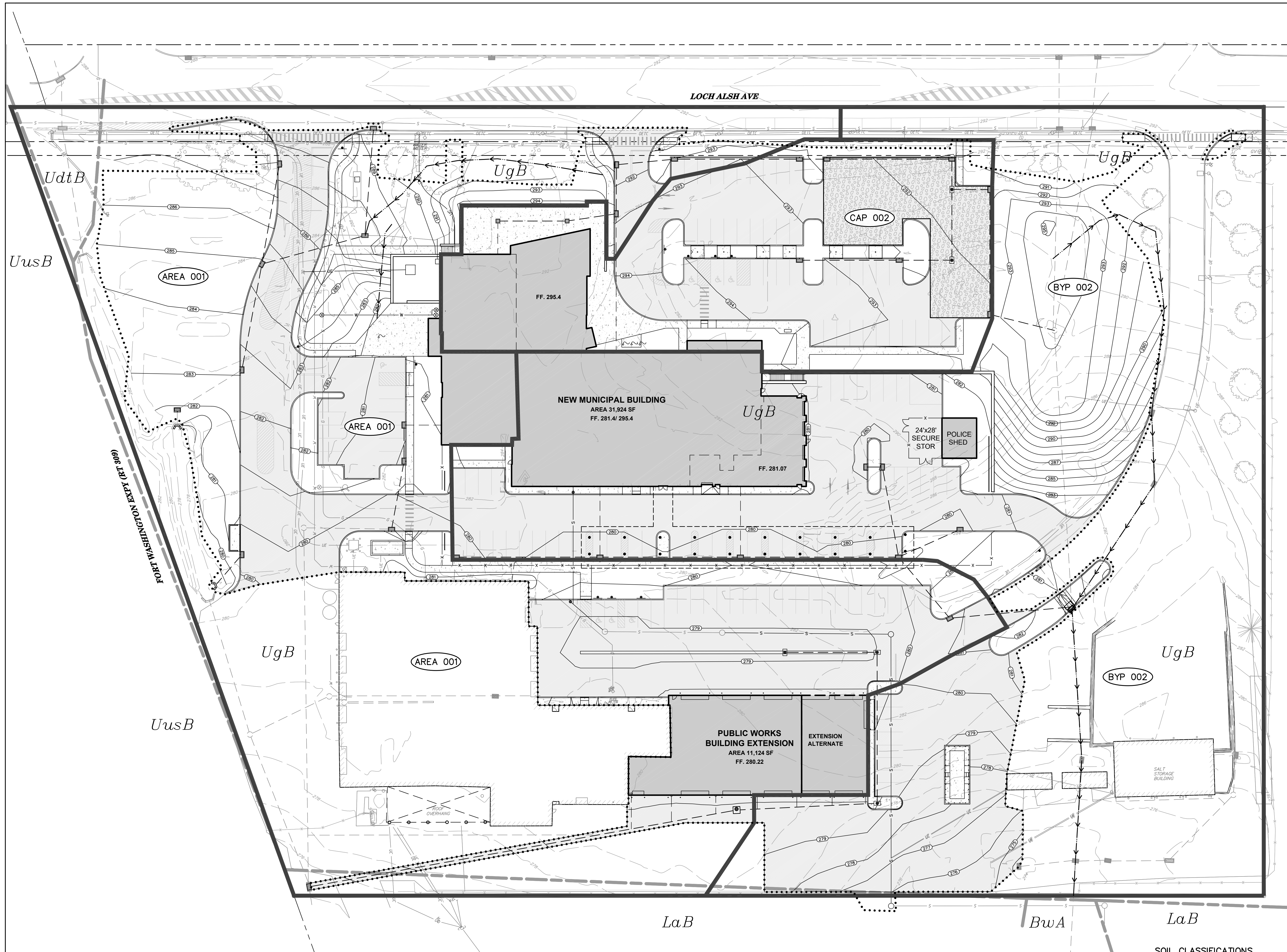

LOCATION MAP
SCALE: 1" = 2,000'

DRAINAGE LEGEND

DRAINAGE AREA BOUNDARY	
Tc PATH	
LIMIT OF DISTURBANCE	
DRAINAGE AREA LABEL	

LEGEND

	EXISTING	PROPOSED
BOUNDARY LINE		
ADJOINING LOT LINE		
RIGHT-OF-WAY		
IRON PIN/CONCRETE MONUMENT		
FENCE		
SIGNS		
CURBING		
CONCRETE		
BUILDING		
STORM PIPE/INLET/MANHOLE		
SANITARY PIPE/MANHOLE/CLEAN OUT		
WATER LINE/HYDRANT/VALVE		
GAS LINE & VALVE		
OVERHEAD ELECTRIC		
UNDERGROUND ELECTRIC		
UNDERGROUND COMMUNICATION		
UTILITY POLE		
LIGHT POLE		
TREES/SHRUBS		
TREE LINE		
SOILS		
WELL		

SOIL CLASSIFICATIONS

- BwA** BUCKINGHAM SILT LOAM
0% - 1% SLOPES
HYDROLOGIC SOIL GROUP: B/D
- LaB** LANSDALE LOAM
3% - 8% SLOPES
HYDROLOGIC SOIL GROUP: B
- UdtB** UDORTHENTS, SHALE AND SANDSTONE
0% - 8% SLOPES
HYDROLOGIC SOIL GROUP: C
- UgB** URBAN LAND
0% - 8% SLOPES
HYDROLOGIC SOIL GROUP: C
- UusB** URBAN LAND - UDORTHENTS, SHALE AND SANDSTONE COMPLEX
0% - 8% SLOPES
HYDROLOGIC SOIL GROUP: A

NOTE:
PURSUANT TO THE REQUIREMENTS OF ACT 287 OF 1974 AND AS LAST AMENDED BY ACT 181 OF 2006 THE LOCATIONS OF ALL EXISTING UTILITIES SHOWN ON THESE PLANS HAVE BEEN DEVELOPED FROM EXISTING UTILITY RECORDS AND/OR ABOVE-GROUND EXAMINATIONS OF THE SITE. COMPLETENESS, ACCURACY, LOCATION AND DEPTH OF UNDERGROUND UTILITIES OR STRUCTURES CANNOT BE GUARANTEED. THE CONTRACTORS, AT LEAST THREE (3) DAYS PRIOR TO PERFORMING ANY EXCAVATIONS, SHALL BE RESPONSIBLE FOR VERIFYING THE LOCATIONS AND DEPTHS OF ALL UNDERGROUND FACILITIES LOCATED WITHIN THE VICINITY OF THE WORK SITE IN ACCORDANCE WITH ACT 181. (PA ONE CALL SYSTEM, INC. 1-800-242-1776)

CALL BEFORE YOU DIG!
PENNSYLVANIA LAW REQUIRES 3 WORKING DAYS NOTICE FOR CONSTRUCTION PHASE AND 10 WORKING DAYS IN DESIGN STAGE - STOP CALL PENNSYLVANIA ONE CALL SYSTEM, INC.
1-800-242-1776

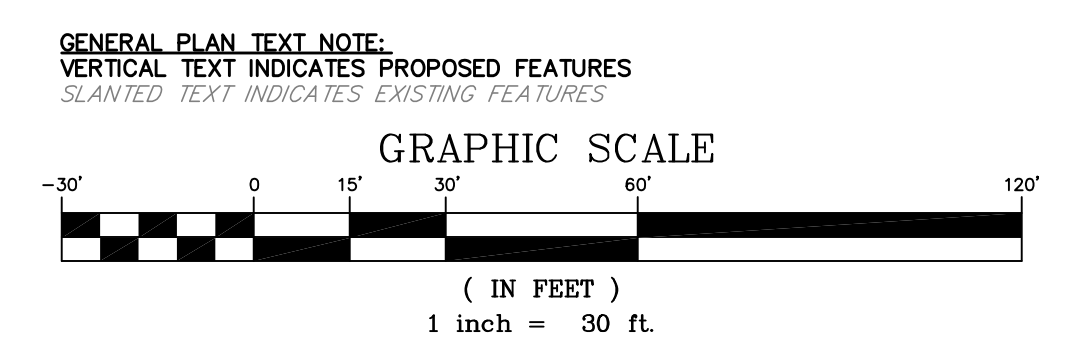

PRELIMINARY/FINAL

UPPER DUBLIN TOWNSHIP
MUNICIPAL BUILDING

POST-DEVELOPMENT DRAINAGE MAP

DM-2

LAND DEVELOPMENT

JOB #	2539
SCALE	1" = 30'
DATE	05/25/2023

Terraform Engineering, LLC
ONE EAST BROAD STREET, SUITE 300
BETHLEHEM, PA 18018
PHONE: 610-666-8822
WWW.TERRAFORMENGINEERING.COM

GODSHALL KANE OROURKE ARCHITECTS, LLC
300 BROOKSIDE AVENUE
BUILDING 18 - SUITE 150
AMBLER, PA 19002
W: GKORARCHITECTS.COM
T: 215.648.2003

GKO ARCHITECTS

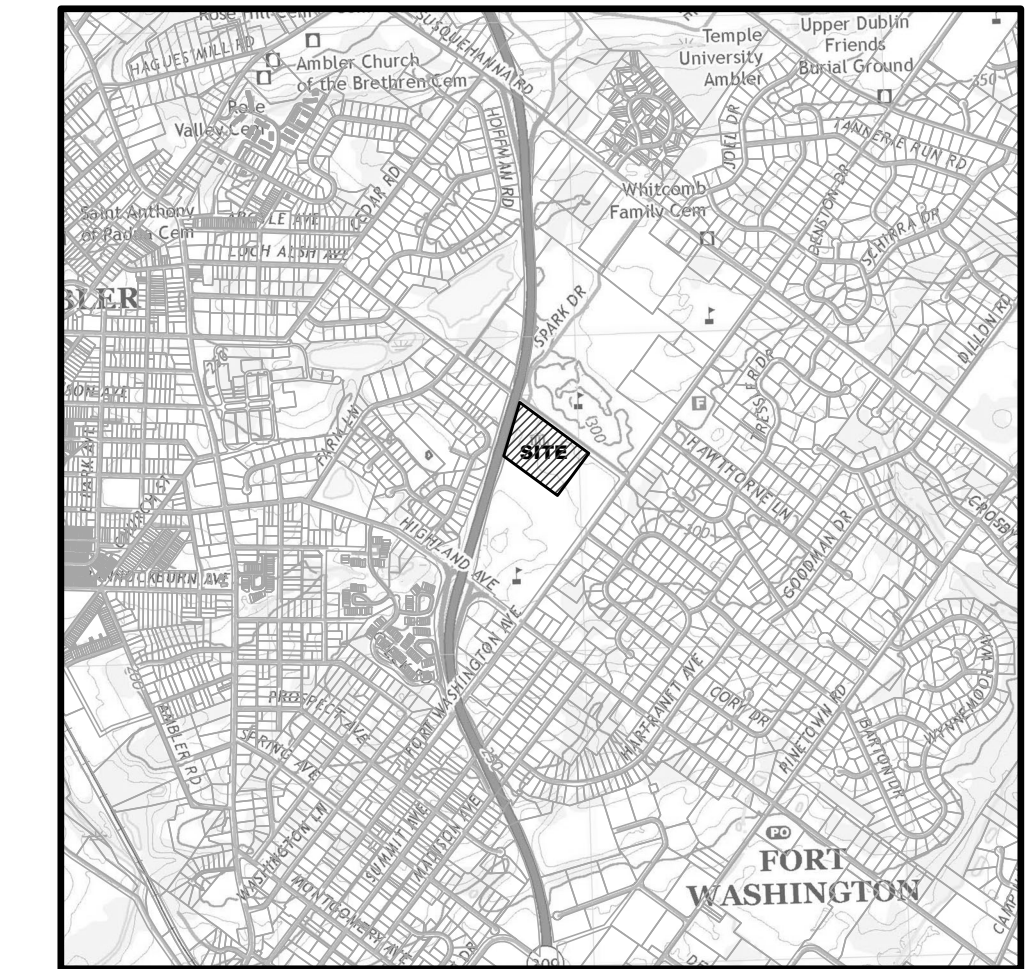
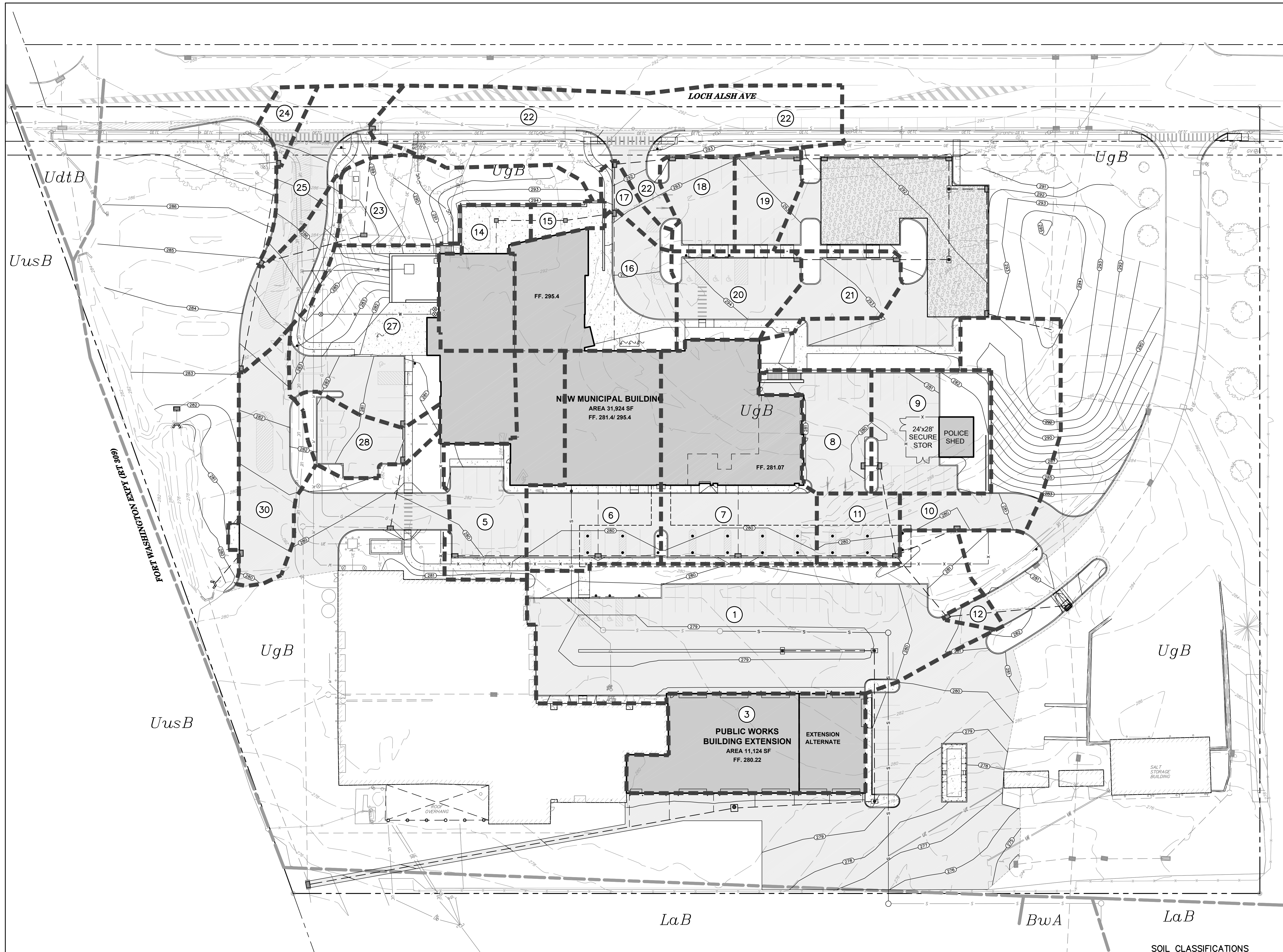

LOCATION MAP
SCALE: 1" = 2,000'

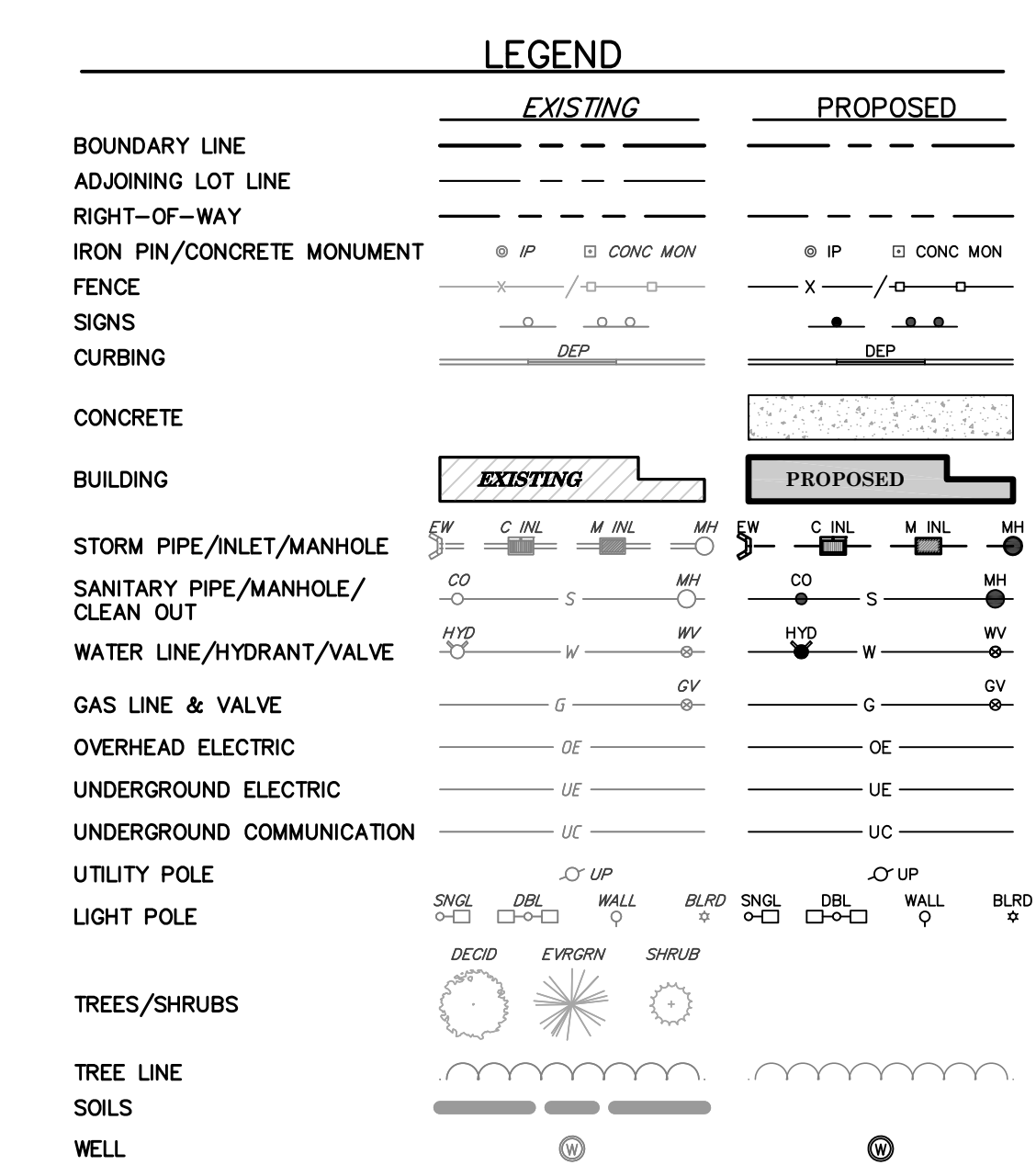
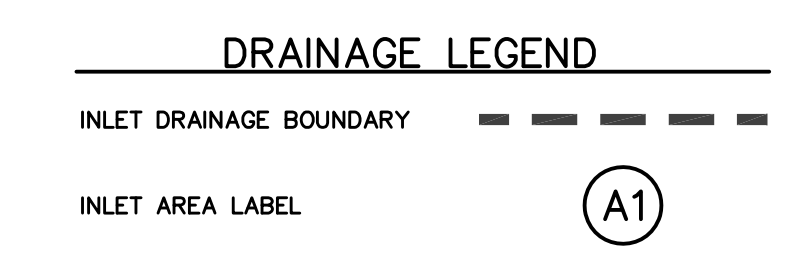

SOIL CLASSIFICATIONS

- BwA** BUCKINGHAM SILT LOAM
0% - 1% SLOPES
HYDROLOGIC SOIL GROUP: B/D
- LaB** LANSDALE LOAM
3% - 8% SLOPES
HYDROLOGIC SOIL GROUP: B
- UdtB** UDORTHENTS, SHALE AND SANDSTONE
0% - 8% SLOPES
HYDROLOGIC SOIL GROUP: C
- UgB** URBAN LAND
0% - 8% SLOPES
HYDROLOGIC SOIL GROUP: C
- UusB** URBAN LAND - UDORTHENTS, SHALE AND SANDSTONE COMPLEX
0% - 8% SLOPES
HYDROLOGIC SOIL GROUP: A

NOTE:
Pursuant to the requirements of Act 287 of 1974 and as last amended by Act 181 of 2006 the locations of all existing utilities shown on these plans have been developed from existing utility records and/or above-ground examinations of the site. Completeness, accuracy, location and depth of underground utilities or structures cannot be guaranteed. The contractor, at least three (3) days prior to performing any excavations, shall be responsible for verifying the locations and depths of all underground facilities located within the vicinity of the work site in accordance with Act 181. (PA ONE CALL SYSTEM, INC. 1-800-242-1776)

CALL BEFORE YOU DIG!
PENNSYLVANIA LAW REQUIRES 3 WORKING DAYS NOTICE FOR CONSTRUCTION PHASE AND 10 WORKING DAYS IN DESIGN STAGE - STOP CALL PENNSYLVANIA ONE CALL SYSTEM, INC.
1-800-242-1776

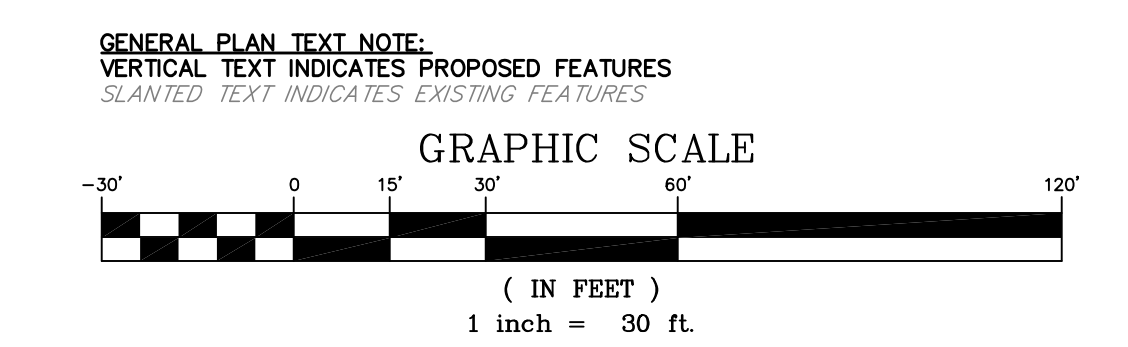

PRELIMINARY/FINAL

UPPER DUBLIN TOWNSHIP
MUNICIPAL BUILDING

INLET DRAINAGE MAP

DM3

LAND DEVELOPMENT

JOB #	2539
SCALE	1" = 30'
DATE	05/25/2023

Terraform Engineering, LLC
ONE EAST BROAD STREET, SUITE 200
BETHLEHEM, PA 18018
PHONE: 610-666-8822
WWW.TERRAFORMENGINEERING.COM

GODSHALL KANE OROURKE ARCHITECTS, LLC
300 BROOKSIDE AVENUE
BUILDING 18 - SUITE 150
AMBLER, PA 19002
W: GKORARCHITECTS.COM
T: 215.648.2003

GKO ARCHITECTS

REVISIONS

NO.	DESCRIPTION

THIS DOCUMENT HAS BEEN PRODUCED BY GKO, BUT MAY BE PREPARED BY AN UNLICENSED PERSON OR FIRM.

SHEET TITLE

SHEET #