



Sky Run II • Suite A1 • 4050 Skyron Drive • Doylestown, PA 18902
Phone 215-345-5545 Fax 215-345-8138

VIA FACSIMILE (610-941-5316) & Email (rpm@mcbridemurphy.com)

The Cutler Group
c/o McBride & Murphy
5 Apollo Road, Suite 2
Plymouth Meeting, PA 19462
(610) 834-1046

February 25, 2008

Attn: Mr. Richard McBride, Esq.

**RE: Supplemental Soil Delineation and Revised Site Conceptual Models for Lead and Arsenic
Former Zieger Rose Nursery Property
1760 & 1756 Dreshertown Road, Dresher 19025
Upper Moreland Township, Montgomery County, PA
TPN: 54-00-054-100-08
DelVal Job # 05-611A**

Dear Mr. McBride:

DelVal Soil & Environmental Consultants, Inc. (DelVal) is pleased to provide you with the following summary of the findings of a supplemental soil delineation/characterization investigation of the soil around the greenhouses and associated commercial structures located at the above referenced site (Figure 1 in Appendix I). This report is a supplementation to the December 2006 report, in which elevated concentrations of lead and arsenic were identified in the soils in and around the greenhouses and associated commercial structures, but had not been fully delineated.

BACKGROUND

DelVal prepared a Phase I Environmental Site Assessment dated October 20, 2005 for the subject site, which revealed several recognized environmental conditions, including impacts to the surface and subsurface soils on the site associated with historic commercial use as a rose nursery.

DelVal prepared a Phase II soil sample investigation report dated November 2005, in which twenty-six (26) soil samples were collected across the subject site. Approximately half of the soil samples collected and analyzed were found to contain concentrations of arsenic and lead in excess of the applicable PADEP Residential Statewide Health Standards. None of the soil samples collected in the agricultural fields were found to contain concentrations in excess of applicable PADEP Residential Statewide Health Standards.

DelVal recommended post-removal characterization/delineation of the soils around and under the "old" soil pile in the central portion of the site, as well as the characterization/delineation of subsurface soils in the vicinity of the former rose nursery and associated buildings in order to determine appropriate method(s) to address the elevated levels of lead and arsenic identified in soil samples.

In July 2006, DelVal collected two hundred and sixty-four (264), near surface and subsurface, characterization soil samples in and around the greenhouses, the vicinity of the “old” soil pile, and from soil sample locations from previous studies. The purpose of this sampling event was to quantify the horizontal and vertical extent (volume) of material which exhibited lead and arsenic concentrations in excess of the applicable PADEP Residential Statewide Health Standards. The December 2006 Soil Characterization / Delineation Report reported ninety-six (96) surface and subsurface soil samples were collected from within the three (3) greenhouses during the November 2005 and July 2006 soil sampling events. Analytical results indicate decreasing lead and arsenic concentrations with depth and exceedences in only the near surface (0-6”) soil horizon, which is indicative of a surface application/condition. A total of one hundred and seventy-two (172) surface and subsurface soil samples were collected during the November 2005 and July 2006 soil sampling events exterior to and in the vicinity of the rose nursery structures. Analytical results indicate lead and/or arsenic concentrations identified in the soils in the vicinity of the nursery buildings has not been delineated completely. A total of thirteen (13) surface and subsurface soil samples were collected during the November 2005 and July 2006 soil sampling events within and in the vicinity of the “old” soil pile. Analytical results indicate concentrations identified in the vicinity of the “old” soil pile have not been delineated completely.

Although the delineation was not complete, the result of the November 2005 and July 2006 sampling events were used to develop a site conceptual model of the lead and arsenic concentrations for the purpose of projecting volumes and appropriate remedial methods. The December 2007 report and conceptual models recommended further refinement of the projected volumes of impacted soil through evaluation of additional characterization soil samples.

Per your letter dated December 4, 2007, DelVal has completed the supplemental delineation soil sampling at the above referenced site. The following is a summary of the supplemental delineation sampling event:

SCOPE OF WORK

At the request of The Cutler Group, DelVal collected one hundred and fifteen (115), near surface and subsurface, characterization soil samples. The purpose of this sampling event was to further quantify the horizontal and vertical extent (volume) of material which exhibited lead and arsenic concentrations in excess of the applicable PADEP Residential Statewide Health Standards in the vicinity of the greenhouses and the “old” soil pile. Soil sampling was limited to the areas immediately surrounding the greenhouses and in the vicinity of the “old” soil pile.

SOIL SAMPLING

Soil Investigation in Vicinity of Former Rose Nursery Structures (Exterior)

Background and Limitations

The horizontal and vertical delineation sampling around the greenhouses was conducted as outlined in the work plan; however, access was limited in various areas due to the presence of subsurface utilities including drains, water lines, electric lines, natural gas lines and underground storage tanks.

During the November 2005 soil sampling event, three (3) soil samples were collected from 24” BGS. Soil samples collected during the July 2006 soil sampling event were collected to a depth of 18” BGS. Several soil samples collected from 18-24” BGS during the November 2005 and July 2006 sampling events were found to contain elevated lead and arsenic concentrations. During the December 2007 soil sampling event, soil samples were collected to a maximum depth of 30” BGS in an effort to define the vertical extent of lead and arsenic impacts.

Sampling Event

On Monday, December 17 and Tuesday, December 18, 2007, one hundred and fifteen (115) soil borings (designated SS83A through SS105E) were installed by DelVal in an effort to further characterize the soil and attempt to delineate the horizontal and vertical extent of lead and arsenic impacts identified during the November 2005 and July 2006 studies. The December 2007 soil borings were installed along the exterior of the greenhouses, associated rose nursery buildings, within/along the access roadways, in the vicinity of the "old" soil pile, in the garden, and in the vicinity of the on-lot septic systems.

Discrete soil samples were collected with a sterilized disposable hand trowel from near surface (0-6 inches BGS). Subsurface soil samples were collected, from borings installed by hand auger, with a sterilized disposable hand trowel from 6-12 inches BGS, 12-18 inches BGS, 18-24 inches BGS, and 24-30 inches BGS. Twenty-three (23) surface soil samples are designated with the letter "A", ninety-two (92) subsurface soil samples (twenty-three [23] per depth) are designated with the letters "B" (6-12 inches BGS), "C" (12-18 inches BGS), "D" (18-24"), and "E" (24-30" BGS), respectively for a total of one hundred and fifteen (115) soil samples. No odors or visual indications of the presence of impacted soils were detected in the soil encountered during the collection of the samples. No groundwater was encountered during the soil sampling event.

The soil sample boring locations were marked in the field with a handheld GPS and are included on Figure 2 in Appendix I of this report.

The soil samples were forwarded to *TestAmerica – Pittsburgh*, PADEP certified and NELAC accredited laboratory and analyzed for the presence of arsenic and lead. Please note that the above analysis does not constitute a comprehensive suite of analytical parameters and is limited to the substances, previously identified in excess of the applicable PADEP Residential Statewide Health Standards.

Analytical Results

Analytical results were received from TestAmerica-Pittsburgh Laboratories and are summarized in Table 1 in Appendix II. A copy of the chain of custody and final laboratory report are included in Appendix III.

Surface (0-6 inches BGS) Soil Samples (SS83A through SS105A)

The analytical results indicate that detectable concentrations of arsenic and lead were identified in all of the soil samples collected. Concentrations above the PADEP Residential Statewide Health Standards for direct contact for residential use for arsenic were identified in six (6) of the twenty-three (23) surface samples. Concentrations above the applicable PADEP standards for lead were identified in seven (7) of the twenty-three (23) surface samples.

Arsenic

The arsenic concentrations identified in the soil samples ranged from 5.2 mg/kg in soil sample SS94A to 38.9 mg/kg in soil sample SS102A. The arsenic concentrations in SS87A (13.2 mg/kg), SS90A (19.3 mg/kg), SS97A (12.1 mg/kg), SS99A (14.2 mg/kg), SS102A (38.9 mg/kg), and SS105A (23.5 mg/kg) exceed the applicable PADEP Direct Contact Residential Statewide Health Standard of 12 mg/kg.

No soil sample exhibited an arsenic concentration in excess of the PADEP Non-Residential Statewide Health Standard or PADEP Soil to Groundwater Standard of 53 mg/kg and 150 mg/kg, respectively.

Lead

The lead concentrations identified in the soil samples ranged from 26.1 mg/kg in soil sample SS97A to 12,000 mg/kg in soil sample SS96A. The lead concentrations in SS83A (1,970 mg/kg), SS86A (1,380 mg/kg), SS87A (10,900 mg/kg), SS96A (12,000 mg/kg), SS99A (1,060 mg/kg), SS100A (3,230 mg/kg), SS103A (2,350 mg/kg), and SS104A (1,030 mg/kg) exceed the applicable PADEP Soil to Groundwater and Direct Contact Residential Statewide Health Standards of 450 mg/kg and 500 mg/kg, respectively.

In addition, soil samples SS83A (1,970 mg/kg), SS86A (1,380 mg/kg), SS87A (10,900 mg/kg), SS96A (12,000 mg/kg), SS99A (1,060 mg/kg), SS100A (3,230 mg/kg), SS103A (2,350 mg/kg), and SS104A (1,030 mg/kg) exhibit concentrations in excess of the applicable PADEP Non-Residential Statewide Health Standard of 1,000 mg/kg for lead.

Subsurface (6-12 inches BGS) Soil Samples (SS83B through SS105B)

The analytical results indicate that detectable concentrations of arsenic and lead were identified in all of the subsurface (6-12" BGS) soil samples collected; however, no concentration were found to exceed the applicable PADEP Residential Statewide Health Standards.

Arsenic

The arsenic concentrations identified in the soil samples ranged from 3.1 mg/kg in soil sample SS103B to 8.6 mg/kg in soil sample SS99B. No arsenic concentrations were found to exceed the applicable PADEP Residential Statewide Health Standard of 12 mg/kg.

In addition, no soil sample exhibited an arsenic concentration in excess of the PADEP Non-Residential Statewide Health Standard or PADEP Soil to Groundwater Standard of 53 mg/kg and 150 mg/kg, respectively.

Lead

The lead concentrations identified in the soil samples ranged from 7.7 mg/kg in soil sample SS105B to 378 mg/kg in soil sample SS86B. No lead concentrations were found to exceed the applicable PADEP Soil to Groundwater or the applicable Direct Contact Residential Statewide Health Standard of 450 mg/kg and 500 mg/kg, respectively.

In addition, no soil sample exhibited a lead concentration in excess of the PADEP Non-Residential Statewide Health Standard of 1,000 mg/kg for lead.

Subsurface (12-18 inches BGS) Soil Samples (SS83C through SS105C)

The analytical results indicate that detectable concentrations of arsenic and lead were identified in all of the subsurface (12-18" BGS) soil samples collected; however, no concentrations were found to exceed the applicable PADEP Residential Statewide Health Standards.

Arsenic

The arsenic concentrations identified in the soil samples ranged from 1.8 mg/kg in soil sample SS105C to 10.2 mg/kg in soil sample SS97C. No arsenic concentrations were found to exceed the applicable PADEP Residential Statewide Health Standard of 12 mg/kg.

In addition, no soil sample exhibited an arsenic concentration in excess of the PADEP Non-Residential Statewide Health Standard or PADEP Soil to Groundwater Standard of 53 mg/kg and 150 mg/kg,

respectively.

Lead

The lead concentrations identified in the soil samples ranged from 9.9 mg/kg in soil sample SS87C to 152 mg/kg in soil sample SS103C. No lead concentrations were found to exceed the applicable PADEP Soil to Groundwater or the applicable Direct Contact Residential Statewide Health Standard of 450 mg/kg and 500 mg/kg, respectively.

In addition, no soil sample exhibited a lead concentration in excess of the PADEP Non-Residential Statewide Health Standard of 1,000 mg/kg for lead.

Subsurface (18-24 inches BGS) Soil Samples (SS83D through SS105D)

The analytical results indicate that detectable concentrations of arsenic and lead were identified in all of the subsurface (18-24" BGS) soil samples collected; however, no concentrations were found to exceed the applicable PADEP Residential Statewide Health Standards.

Arsenic

The arsenic concentrations identified in the soil samples ranged from 1.5 mg/kg in soil sample SS95D to 7.7 mg/kg in soil sample SS83D. No arsenic concentrations were found to exceed the applicable PADEP Residential Statewide Health Standard of 12 mg/kg.

In addition, no soil sample exhibited an arsenic concentration in excess of the PADEP Non-Residential Statewide Health Standard or PADEP Soil to Groundwater Standard of 53 mg/kg and 150 mg/kg, respectively.

Lead

The lead concentrations identified in the soil samples ranged from 3.3 mg/kg in soil sample SS105D to 159 mg/kg in soil sample SS83D. No lead concentrations were found to exceed the applicable PADEP Soil to Groundwater or the applicable Direct Contact Residential Statewide Health Standard of 450 mg/kg and 500 mg/kg, respectively.

In addition, no soil sample exhibited a lead concentration in excess of the PADEP Non-Residential Statewide Health Standard of 1,000 mg/kg for lead.

Subsurface (24-30 inches BGS) Soil Samples (SS83E through SS105E)

The analytical results indicate that detectable concentrations of arsenic and lead were identified in all of the subsurface (24-30" BGS) soil samples collected; however, no concentrations were found to exceed the applicable PADEP Residential Statewide Health Standards.

Arsenic

The arsenic concentrations identified in the soil samples ranged from 1.2 mg/kg in soil sample SS105E to 8.2 mg/kg in soil sample SS99E. No arsenic concentrations were found to exceed the applicable PADEP Residential Statewide Health Standard of 12 mg/kg.

In addition, no soil sample exhibited an arsenic concentration in excess of the PADEP Non-Residential Statewide Health Standard or PADEP Soil to Groundwater Standard of 53 mg/kg and 150 mg/kg, respectively.

Lead

The lead concentrations identified in the soil samples ranged from 6.0 mg/kg in soil sample SS105E to 337 mg/kg in soil sample SS96E. No lead concentrations were found to exceed the applicable PADEP Soil to Groundwater or the applicable Direct Contact Residential Statewide Health Standard of 450 mg/kg and 500 mg/kg, respectively.

In addition, no soil sample exhibited a lead concentration in excess of the PADEP Non-Residential Statewide Health Standard of 1,000 mg/kg for lead.

Analytical results indicate a decreasing trend in arsenic and lead concentrations and frequency of exceedences with depth. The additional results have further refined the horizontal and vertical extent of lead and arsenic impacts.

SITE CONCEPTUAL MODEL

DelVal generated the following maps/models for lead and arsenic concentrations based upon the analytical results obtained during the December 2007, July 2006, and November 2005 soil sampling events. The models are designed as a visual tool to aid in determining appropriate remedial options to address the impacted soils based on interpolations of arsenic and lead concentrations identified at discrete locations. Actual concentrations at other locations may differ from those, which are represented in the models. The models presented in the attached figures (Figures 3 through 7) are DelVal's best approximation of the occurrence of arsenic and lead concentrations in excess of the PADEP Residential Statewide Health Standard in the soil under current site conditions.

When compiling the maps/models for lead and arsenic impact, DelVal assumed the following:

- ❖ The soil sample points were not survey located and are therefore approximated;
- ❖ Models depict lead and arsenic exceedences together;
- ❖ Models were assigned limits based on PADEP Residential Statewide Health Standards for lead (450 mg/kg) and arsenic (12 mg/kg).
- ❖ "Iso-lines" in the models were generated using software and depict anything having a ratio value over 1.00 deemed exceedences areas
- ❖ Models were interpolated using ratio of result over exceedences, using higher of two ratios as "limiting" result, which dictates remediation recommendation.
- ❖ The limit of study area within the greenhouses was defined using the obvious edge of greenhouse.
- ❖ The limit of the study area in the vicinity of the old soil pile was defined by drawing an iso-line similar to the footprint of the pile. Where horizontal delineation was incomplete in the vicinity of the property boundary with Dreshertown Road the model assumed that the impact extends to the property boundary along Dreshertown Road. Where horizontal delineation was incomplete in the vicinity of the southernmost residence the model calculated the extent of impact within the limit of the sample points. The remaining areas of the model, exterior to the greenhouses, were defined by the obvious edge of the greenhouses to a line drawn to encompass the furthest sampling points exterior to the greenhouses.

Impacted Material – Vicinity of Former Rose Nursery Structures

Figure 3: Sampling Points and Interpolated Surface Arsenic and Lead Concentrations in Vicinity of Nursery Structures (0-6")

This plan consists of interpolated arsenic and lead concentrations from eight-two (82) surface samples (0-6" BGS) collected in the vicinity of the nursery structures during the December 2007, July 2006, and November 2005 sampling events. The projected volume of soil with arsenic and/or lead concentrations, which are in excess of the applicable PADEP Residential Statewide Health Standard of 12 mg/kg for arsenic and 450 mg/kg for lead, is approximately 1,515 cubic yards.

Figure 4: Sampling Points and Interpolated Subsurface Arsenic and Lead Concentrations in Vicinity of Nursery Structures (6-12")

This plan consists of interpolated arsenic and lead concentrations from seventy-eight (78) subsurface samples (6-12" BGS) collected in the vicinity of the nursery structures during the December 2007, July 2006, and November 2005 sampling events. The projected volume of soil with arsenic and/or lead concentrations, which are in excess of the applicable PADEP Residential Statewide Health Standard of 12 mg/kg for arsenic and 450 mg/kg for lead, is approximately 375 cubic yards.

Figure 5: Sampling Points and Interpolated Subsurface Arsenic and Lead Concentrations in Vicinity of Nursery Structures (12-18")

This plan consists of interpolated arsenic and lead concentrations from seventy-eight (78) subsurface samples (12-18" BGS) collected in the vicinity of the nursery structures during the December 2007, July 2006, and November 2005 sampling events. The projected volume of soil with arsenic and/or lead concentrations, which are in excess of the applicable PADEP Residential Statewide Health Standard of 12 mg/kg for arsenic and 450 mg/kg for lead, is approximately 419 cubic yards.

Figure 6: Sampling Points and Interpolated Subsurface Arsenic and Lead Concentrations in Vicinity of Nursery Structures (18-24")

This plan consists of interpolated arsenic and lead concentrations from twenty-six (26) subsurface samples (18-24" BGS) collected in the vicinity of the nursery structures during the December 2007 and November 2005 sampling events (no samples were collected from this depth during the July 2006 sampling event). The projected volume of soil with arsenic and/or lead concentrations, which are in excess of the applicable PADEP Residential Statewide Health Standard of 12 mg/kg for arsenic and 450 mg/kg for lead, is approximately 37 cubic yards.

Figure 7: Sampling Points and Interpolated Subsurface Arsenic and Lead Concentrations in Vicinity of Nursery Structures (24-30")

There were no concentrations of arsenic or lead identified in excess of the applicable PADEP Residential Statewide Health Standard of 12 mg/kg for arsenic or 450 mg/kg for lead in the 24-30" BGS soil horizon.

The refined site conceptual model, incorporating the December 2007 supplemental characterization/delineation data, estimates that the volume of impacted material exterior to the nursery structures to be 2,346 cubic yards.

FINDINGS

- ❖ No odors, staining or otherwise suspicious materials were observed in the surface and subsurface during the soil boring installations.
- ❖ Vicinity of former rose nursery structures (February 22, 2008 Revised Site Conceptual Model)
 - On Monday, December 17 and Tuesday, December 18, 2007, one hundred and fifteen (115) soil borings (designated SS83A through SS105E) were installed by DelVal in an effort to further characterize the soil and attempt to delineate the horizontal and vertical extent of lead and arsenic impacts identified during the November 2005 and July 2006 studies. A total of two hundred and eight-seven (287) surface and subsurface soil samples were collected during the December 2007, July 2006, and November 2005 soil sampling events.
 - Forty-nine (49) of the eight-two (82) surface soil sample points exhibited lead or arsenic concentrations in excess of the PADEP Residential Statewide Health Standard. Twenty-two (22) of the surface soil samples exhibiting lead or arsenic concentrations were identified in excess of the PADEP Non-Residential Statewide Health Standard.
 - Thirty-six (36) of the two hundred and five (205) subsurface soil sample points exhibited lead or arsenic concentrations in excess of the PADEP Residential Statewide Health Standard. Ten (10) of the subsurface soil samples exhibiting lead or arsenic concentrations were identified in excess of the PADEP Non-Residential Statewide Health Standard.
 - Analytical results indicate a decreasing trend in arsenic and lead concentrations and frequency of exceedences with depth. The additional delineation sampling results have further refined the horizontal and vertical extent of lead and arsenic impacts. Based on the modeling of the surface and subsurface soil investigation, the projected volume of arsenic and lead impacted soil exterior to the greenhouse and associated structures is estimated to be 2,346 cubic yards.
- ❖ Inside Greenhouses and Old Soil Stockpile (December 1, 2006 Site Conceptual Model)
 - The site conceptual model, included in the December 2006 Soil Characterization/Delineation Report, estimated the volume of lead and arsenic impacted soil within the greenhouses and the old soil pile to be 1,375 cubic yards.

RECOMMENDATIONS

- ❖ Based on the findings, DelVal recommends removal and proper off-site disposal of the lead and arsenic impacted soils in areas identified during the December 2007, July 2006 and November 2005 sampling events and collection of confirmatory post removal soil samples. The total estimated volume of arsenic and lead impacted soils within and exterior to the greenhouse structures and in and within the “old” soil pile is 3,719 cubic yards (5,579 tons).
- ❖ Although DelVal is aware that PADEP does not consider agricultural properties with agricultural impacts eligible under PADEP’s Land Recycling Program (Act 2), DelVal has been advised by Mr. Alex Reyda that

greenhouses are considered for Act 2 release of liability. DelVal recommends pursuit of PADEP Land Recycling Program (Act 2) for release of liability for the area encompassing the former rose nursery activities.

Should you have any questions regarding these test results or need further assistance, please feel free to contact our office during normal business hours (215) 345-5545 ext. 144 or via email, ckulp@delvalsoil.com. Thank you for contacting DelVal Soil and Environmental Consultants, Inc. for your environmental needs.

Respectfully Submitted,
DelVal Soil & Environmental Consultants



Clorece K. Kulp
Environmental Scientist



Mark Fortna
Sr. Environmental Scientist / Project Manager

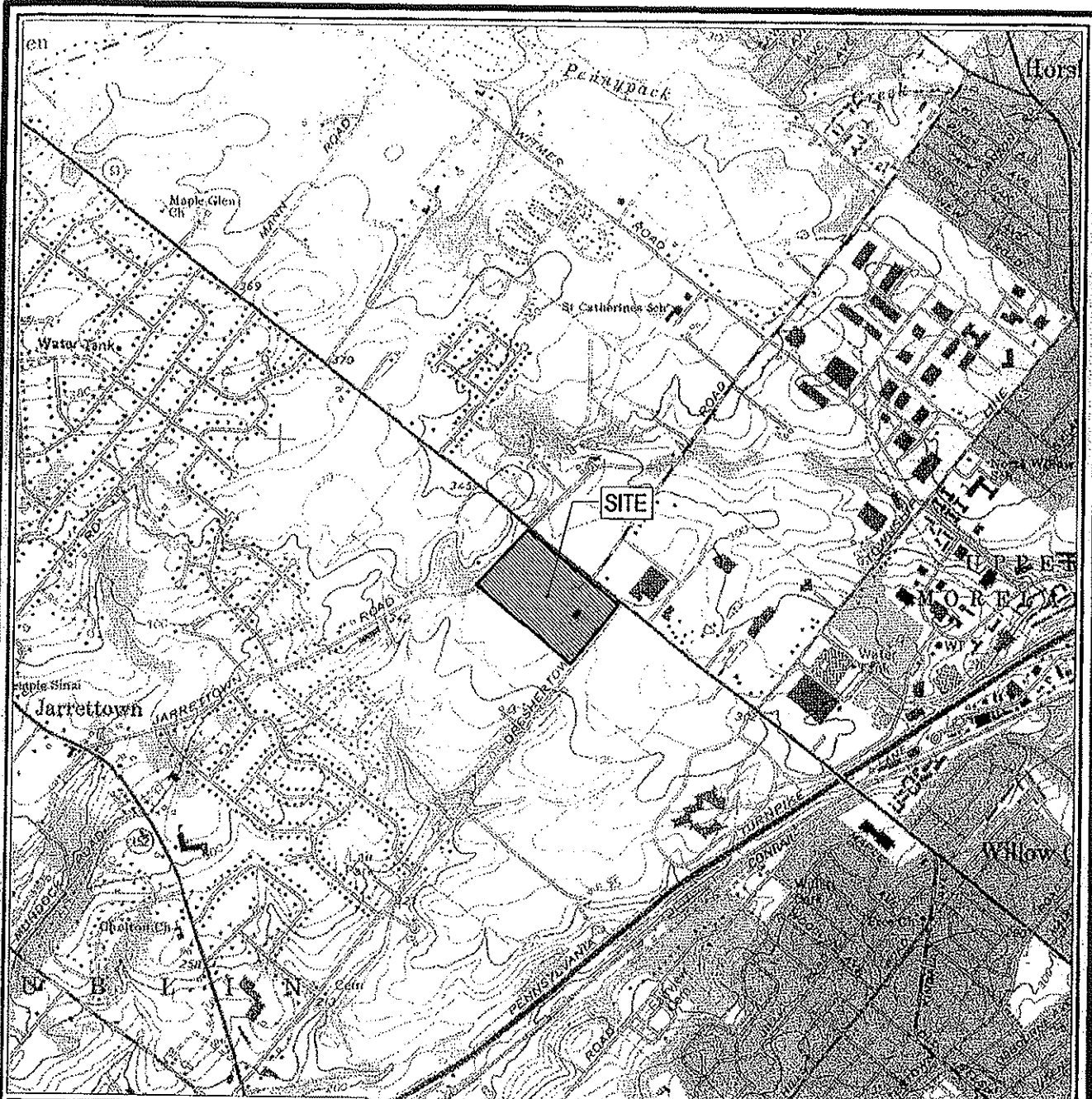

BASE MAP USGS 7.5 MIN.
 AMBLER, PA
 QUADRANGLE

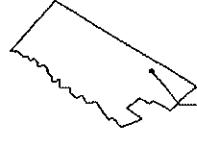

SITE
 (LOCATION
 APPROXIMATE)

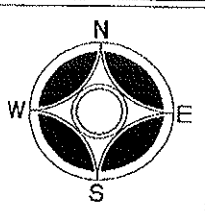

SCALE
 1"=2000'

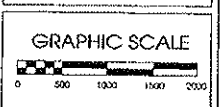

DelVal
 Soil & Val
 Environmental
 Consultants Inc.



Sky Run II • Suite A1 • 4050 Skyro Drive • Doylestown, PA 18901
 Phone (215) 345-5545 Fax (215) 345-8138

**FIGURE 1
 TOPOGRAPHIC MAP**

MADE FOR
**THE CUTLER GROUP:
 ZEIGER PROPERTY**

SITUATE IN
**UPPER DUBLIN TOWNSHIP
 MONTGOMERY COUNTY, PA**

DELVAL#: 05-611A

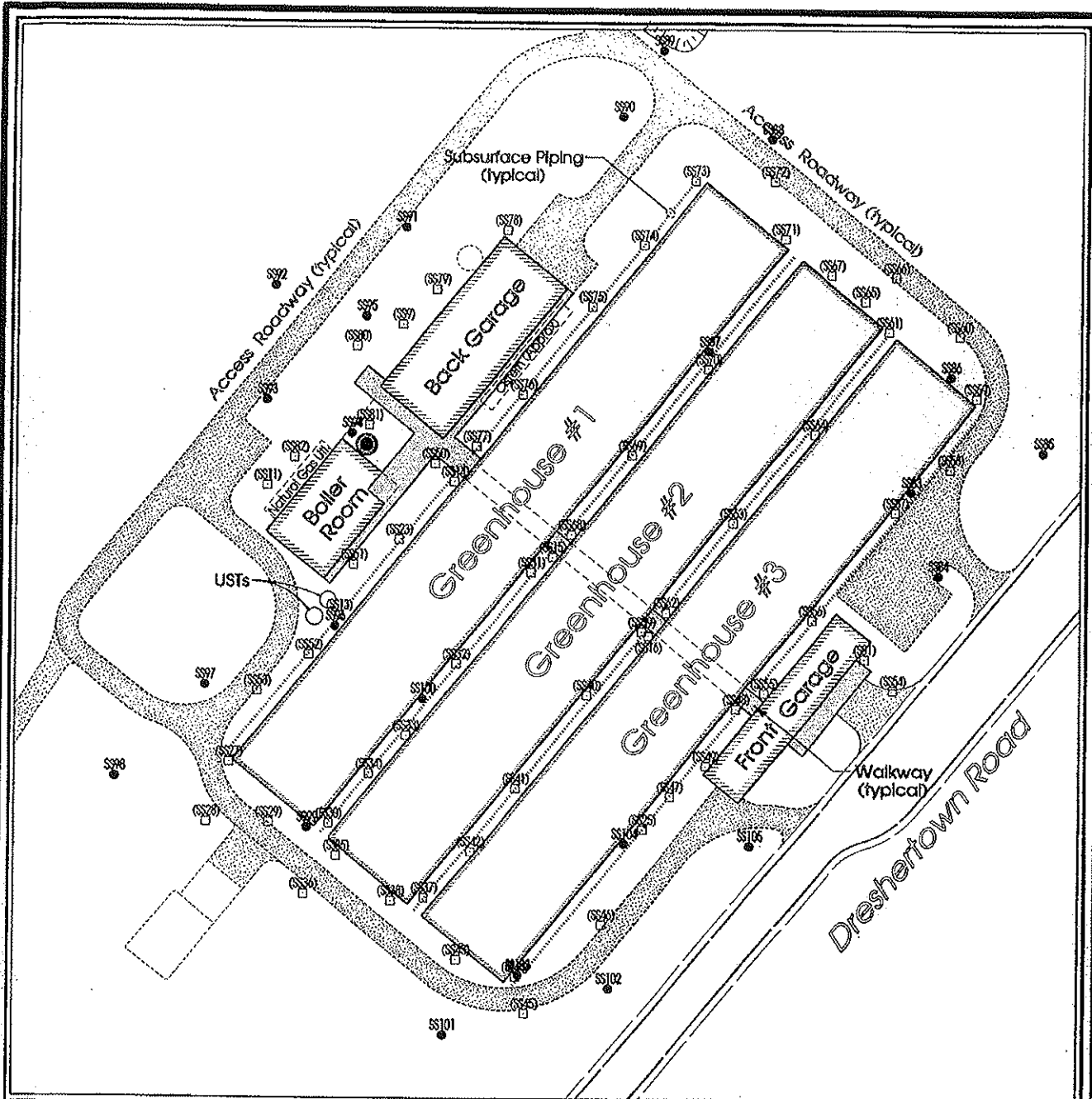

LEGEND

- - SOIL SAMPLE LOCATION & IDENTIFICATION, 2005 - 2006
- - SOIL SAMPLE LOCATION & IDENTIFICATION, 2007

FIGURE 2: VICINITY OF NURSERY STRUCTURES SOIL SAMPLE LOCATIONS

MADE FOR

**THE CUTLER GROUP
ZEIGER PROPERTIES**

SITUATE IN

**UPPER DUBLIN TOWNSHIP
MONTGOMERY COUNTY, PA**

DELVAL# 05-611A

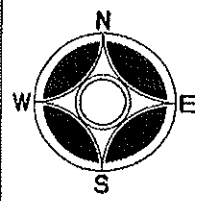

SCALE
1" = 100'



Sky Run II • Suite A1 • 4059 Skyrun Drive • Doylestown, PA 18901
Phone (215) 345-3545 Fax (215) 345-8138

US 2000 Add-Rev 12/08 Job 05-611a DelVal FIGURES 04A P15 2008 FIGURES 04A.crs - 11.01.10.11.A

The exceedence areas depicted in this diagram are based on the interpolation of lead and/or arsenic concentrations which were identified at discrete locations. Actual concentrations at other locations may differ from interpolated values represented in the model. For further detail see accompanying report.

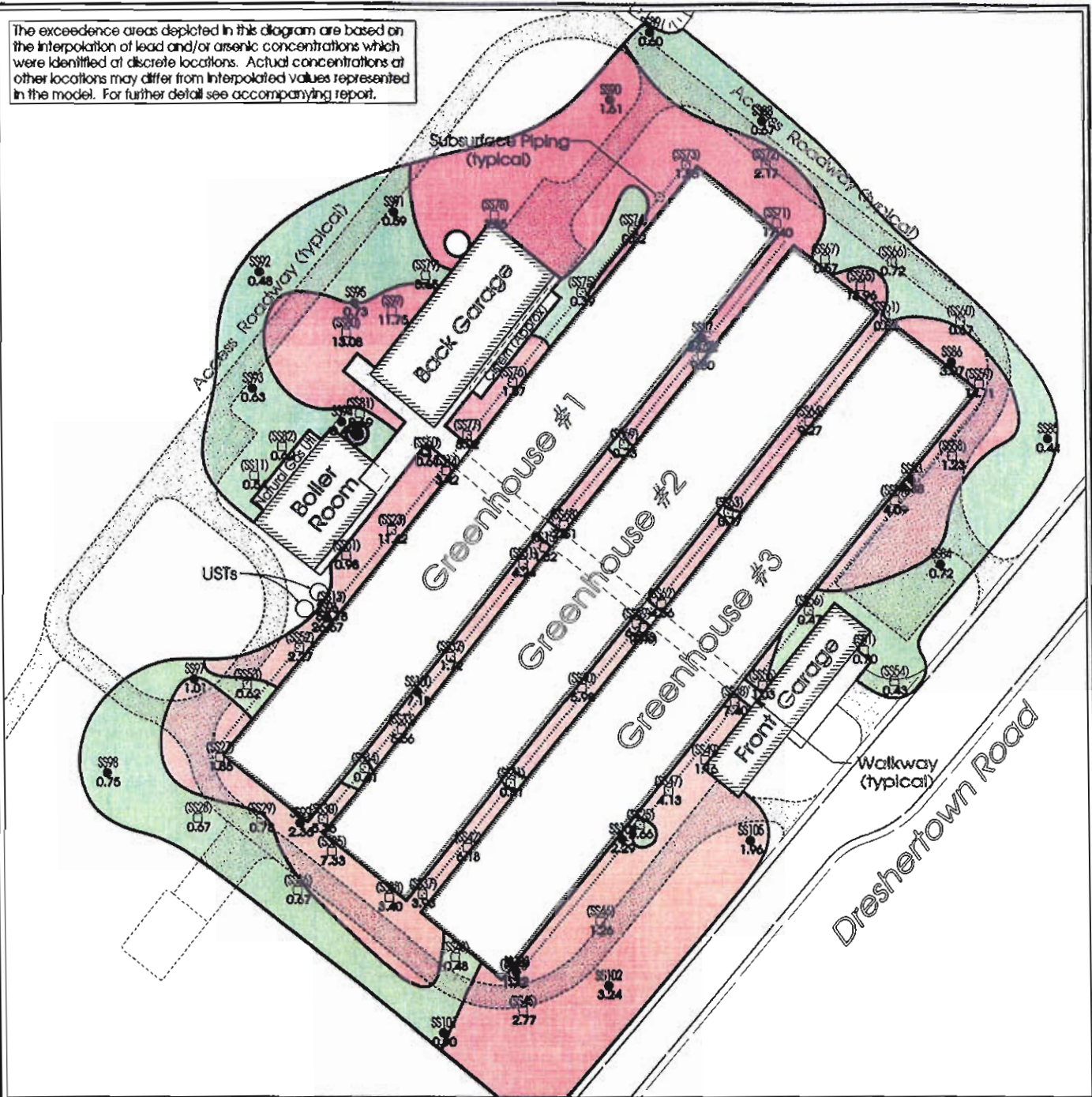

LEGEND

- SS100 - SOIL SAMPLE LOCATION & IDENTIFICATION (W/ EXCEEDENCE FACTOR VALUE) 2006-2006
- SS100 - SOIL SAMPLE LOCATION & IDENTIFICATION (W/ EXCEEDENCE FACTOR VALUE) 2007
- - AREAS EXCEEDING PADEP STANDARDS FOR LEAD AND/OR ARSENIC (SEE NOTE, TOP LEFT)
- - AREAS MEETING PADEP STANDARDS FOR LEAD AND/OR ARSENIC (SEE NOTE, TOP LEFT)

FIGURE 3 : EXTERIOR SOIL SAMPLE AREAS IN EXCEEDENCE OF PADEP STANDARDS FOR LEAD AND/OR ARSENIC (0 - 6" DEPTH)

MADE FOR
**THE CUTLER GROUP
 ZEIGER PROPERTIES**
 SITUATE IN
 UPPER DUBLIN TOWNSHIP
 MONTGOMERY COUNTY, PA
 DELVAL#: 05-611A

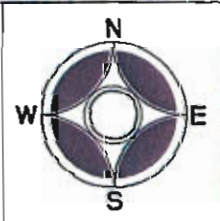

SCALE
 1" = 100'

GRAPHIC SCALE

Delval
 Soil & Environmental Consultants Inc.

Sky Run II - Suite A1 - 4050 Skyron Drive • Doylestown, PA 18041
 Phone (215) 345-5545 Fax (215) 345-8138

The exceedance areas depicted in this diagram are based on the interpolation of lead and/or arsenic concentrations which were identified at discrete locations. Actual concentrations at other locations may differ from interpolated values represented in the model. For further detail see accompanying report.

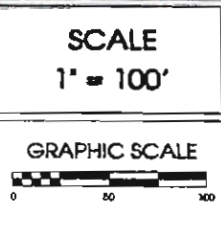
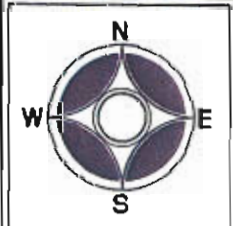
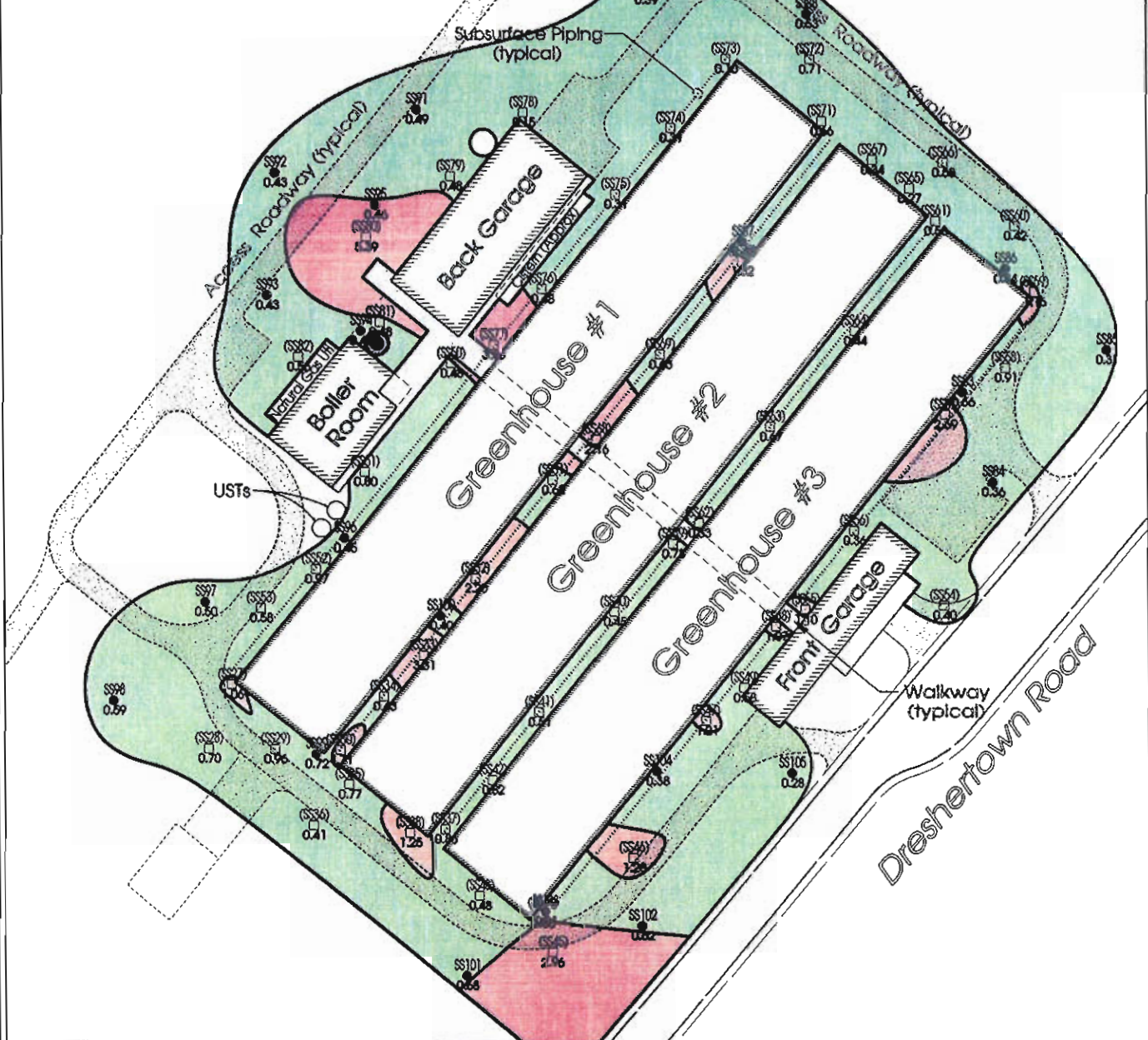

LEGEND

- SS000 - SOIL SAMPLE LOCATION & IDENTIFICATION (W/ EXCEEDANCE FACTOR VALUE) 2005-2006
- SS000 - SOIL SAMPLE LOCATION & IDENTIFICATION (WITH EXCEEDANCE FACTOR VALUE) 2007
- [Red Box] - AREAS EXCEEDING PADEP STANDARDS FOR LEAD AND/OR ARSENIC (SEE NOTE, TOP LEFT)
- [Green Box] - AREAS MEETING PADEP STANDARDS FOR LEAD AND/OR ARSENIC (SEE NOTE, TOP LEFT)

DelVal
Soil & Environmental Consultants Inc.

Sky Run II - Suite A1 • 4050 Skyrun Drive • Doylestown, PA 18901
Phone (215) 345-5545 Fax (215) 345-8138

FIGURE 4 : EXTERIOR SOIL SAMPLE AREAS IN EXCEEDANCE OF PADEP STANDARDS FOR LEAD AND/OR ARSENIC (6 - 12" DEPTH)

MADE FOR
THE CUTLER GROUP
ZEIGER PROPERTIES

SITUATE IN
UPPER DUBLIN TOWNSHIP
MONTGOMERY COUNTY, PA

DELVAL#: 06-611A

U:\2000 Job Files\2005 Jobs\05-61 For Cutl Group\FIGURES DM\FIGS\0005\FIGURES DM.prn - 11-05-0012-A

The exceedence areas depicted in this diagram are based on the interpolation of lead and/or arsenic concentrations which were identified at discrete locations. Actual concentrations at other locations may differ from interpolated values represented in the model. For further detail see accompanying report.

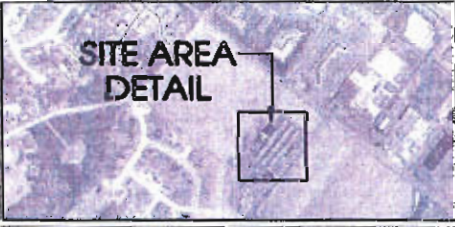
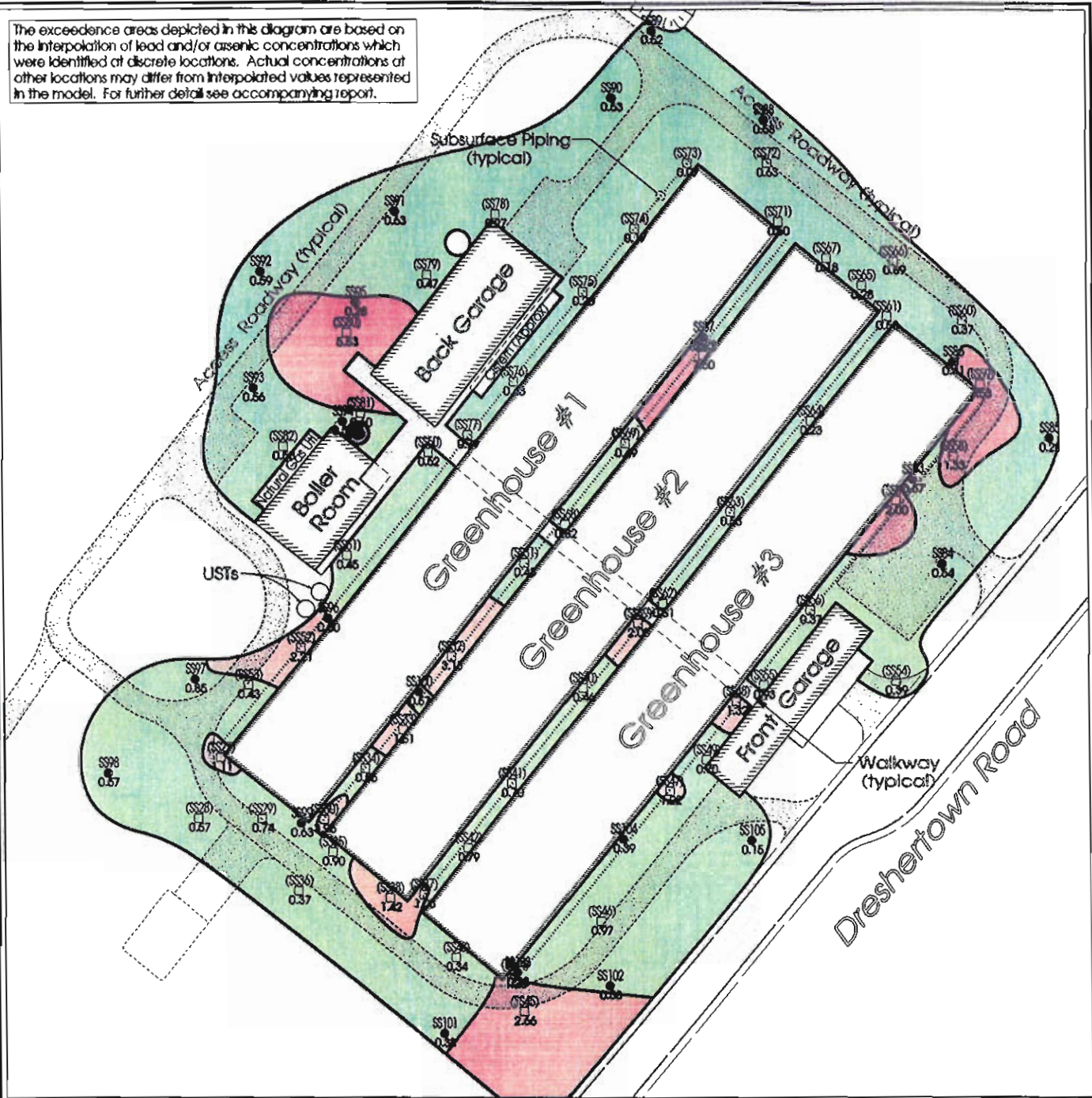

**SITE AREA
DETAIL**

LEGEND

- SS200 - SOIL SAMPLE LOCATION & IDENTIFICATION (W/ EXCEEDENCE FACTOR VALUE) 2006-2006
- SS201 - SOIL SAMPLE LOCATION & IDENTIFICATION (WITH EXCEEDENCE FACTOR VALUE) 2007
- AREAS EXCEEDING PADEP STANDARDS FOR LEAD AND/OR ARSENIC (SEE NOTE, TOP LEFT)
- AREAS MEETING PADEP STANDARDS FOR LEAD AND/OR ARSENIC (SEE NOTE, TOP LEFT)

FIGURE 5 : EXTERIOR SOIL SAMPLE AREAS IN EXCEEDENCE OF PADEP STANDARDS FOR LEAD AND/OR ARSENIC (12 - 18" DEPTH)

MADE FOR
**THE CUTLER GROUP
ZEIGER PROPERTIES**
SITUATE IN
UPPER DUBLIN TOWNSHIP
MONTGOMERY COUNTY, PA
DELVAL#: 05-611A



SCALE
1" = 100'



Sky Run II - Suite A1 • 4050 Skyrun Drive • Doylestown, PA 18041
Phone (215) 345-3545 Fax (215) 345-8138

11/2000 Job Plan 2000 Job 01 01 01 On/Drawn/FIGURES DMI PLS/2000/FIGURES DMI.dwg - 11/02/07-A

The exceedence areas depicted in this diagram are based on the interpolation of lead and/or arsenic concentrations which were identified at discrete locations. Actual concentrations at other locations may differ from interpolated values represented in the model. For further detail see accompanying report.

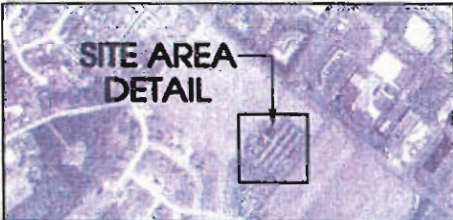
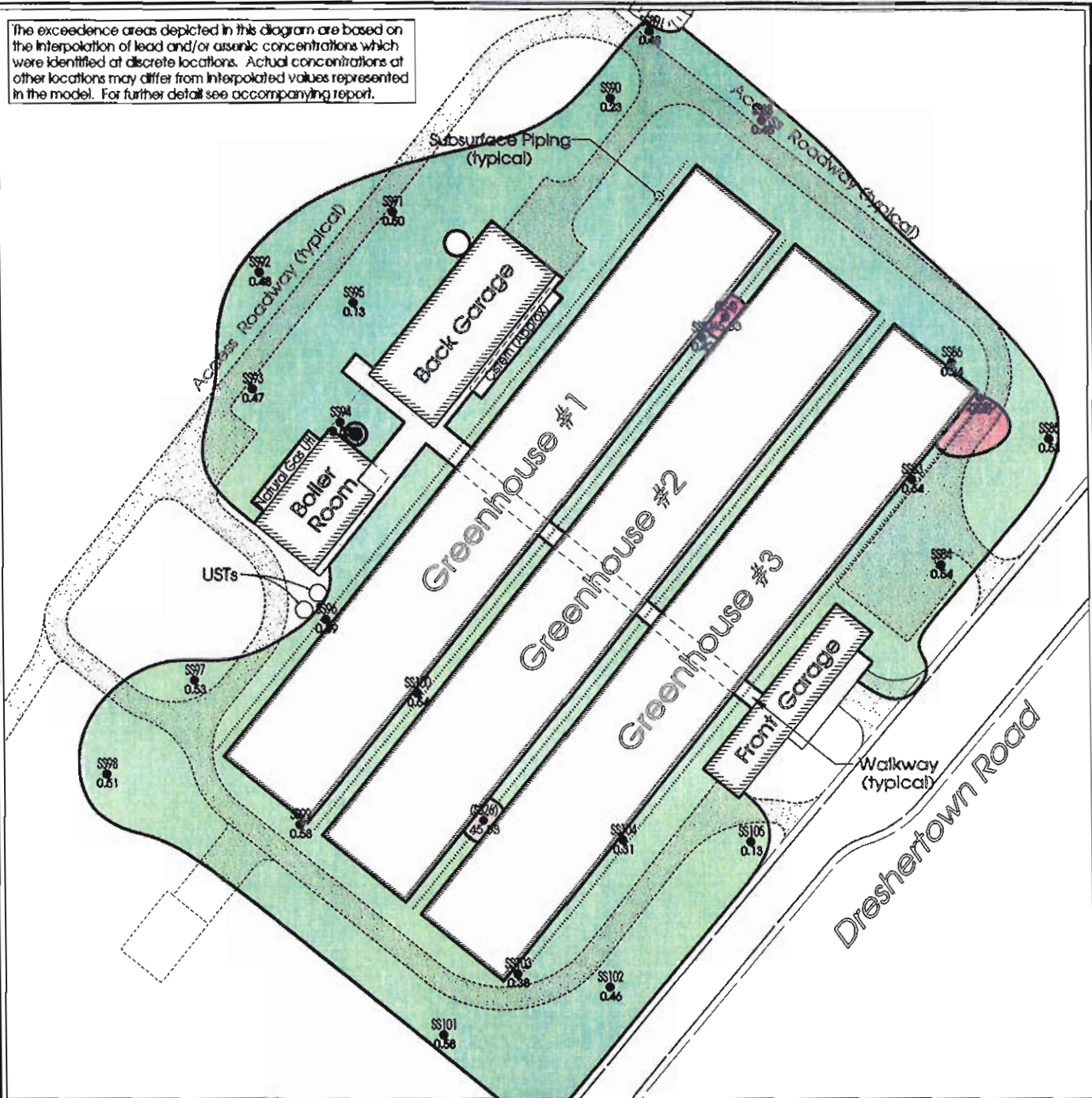

LEGEND

- SS100 - SOIL SAMPLE LOCATION & IDENTIFICATION (W/ EXCEEDENCE FACTOR VALUE) 2005-2006
- SS100 - SOIL SAMPLE LOCATION & IDENTIFICATION (W/ EXCEEDENCE FACTOR VALUE) 2007
- [Red shaded area] - AREAS EXCEEDING PADEP STANDARDS FOR LEAD AND/OR ARSENIC (SEE NOTE, TOP LEFT)
- [Green shaded area] - AREAS MEETING PADEP STANDARDS FOR LEAD AND/OR ARSENIC (SEE NOTE, TOP LEFT)

FIGURE 6: EXTERIOR SOIL SAMPLE AREAS IN EXCEEDENCE OF PADEP STANDARDS FOR LEAD AND/OR ARSENIC (18 - 24' DEPTH)

MADE FOR
**THE CUTLER GROUP
 ZEIGER PROPERTIES**

SITUATE IN
 UPPER DUBLIN TOWNSHIP
 MONTGOMERY COUNTY, PA
 DELVAL#: 06-611A

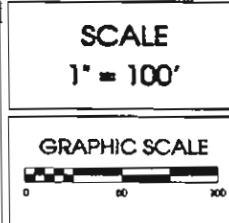
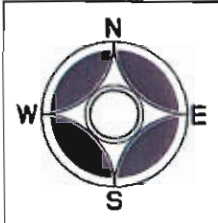

DelVal
 Soil & Val
 Environmental
 Consultants Inc.

Sky Run II • Suite A1 • 4050 Skyrun Drive • Doylestown, PA 18001
 Phone (215) 345-5545 Fax (215) 345-8138

11/12/03 Job File/2006 Job/105-6/101 DelVal/Design/FIGURES DM P51/2006/FIGURES DM.cpio - 11-03-07-A

The exceedence areas depicted in this diagram are based on the interpolation of lead and/or arsenic concentrations which were identified at discrete locations. Actual concentrations at other locations may differ from interpolated values represented in the model. For further detail see accompanying report.

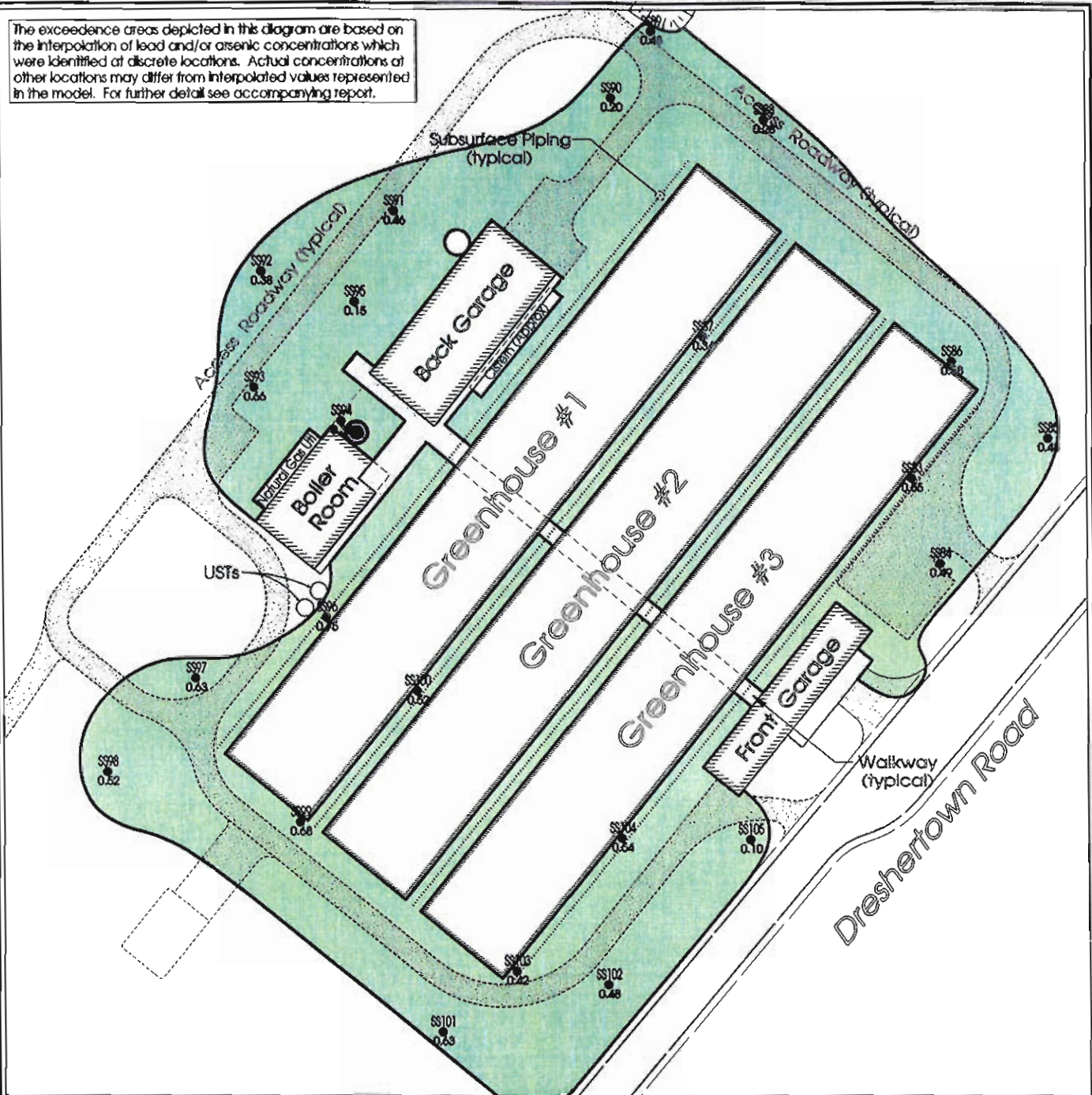

LEGEND

- SS00 1.00 - SOIL SAMPLE LOCATION & IDENTIFICATION (WITH EXCEEDENCE FACTOR VALUE) 2007
- AREAS EXCEEDING PADEP STANDARDS FOR LEAD AND/OR ARSENIC (SEE NOTE, TOP LEFT)
- AREAS MEETING PADEP STANDARDS FOR LEAD AND/OR ARSENIC (SEE NOTE, TOP LEFT)

FIGURE 7: EXTERIOR SOIL SAMPLE AREAS IN EXCEEDENCE OF PADEP STANDARDS FOR LEAD AND/OR ARSENIC (24 - 30" DEPTH)

MADE FOR
**THE CUTLER GROUP
ZEIGER PROPERTIES**

SITUATE IN
**UPPER DUBLIN TOWNSHIP
MONTGOMERY COUNTY, PA**
DELVAL#: 05-611A

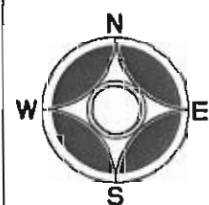

SCALE
1" = 100'



Sky Run II • Suite A1 • 4050 Skyrun Drive • Doylestown, PA 18901
Phone (215) 345-9545 Fax (215) 345-8136

The exceedence areas depicted in this diagram are based on the interpolation of lead and/or arsenic concentrations which were identified at discrete locations. Actual concentrations at other locations may differ from interpolated values represented in the model. For further detail see accompanying report.

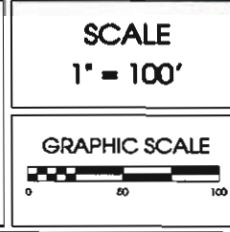
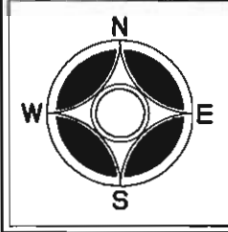
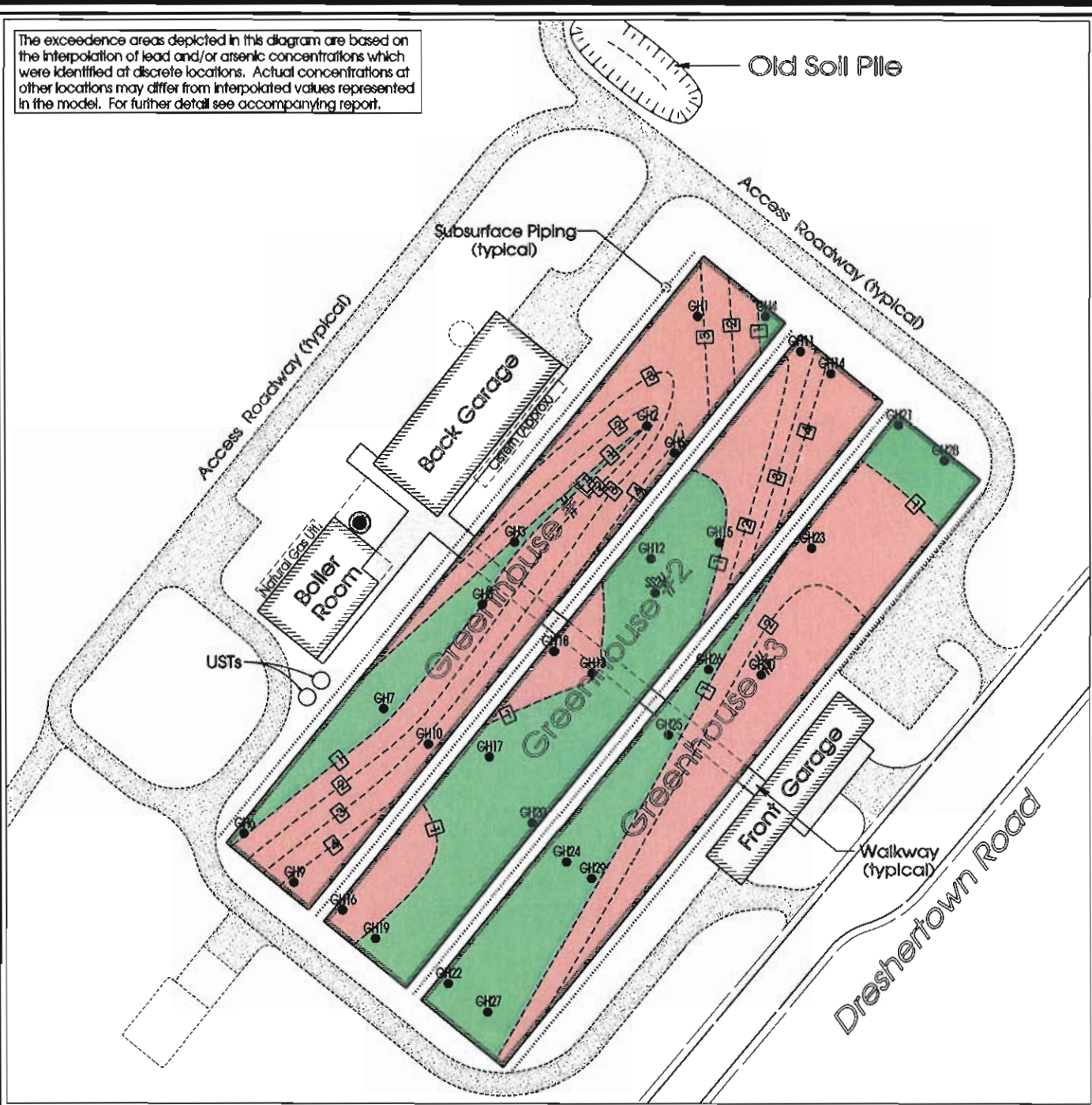

LEGEND

- - SOIL SAMPLE LOCATION & IDENTIFICATION
- - - EXCEEDENCE FACTOR "CONTOUR" (EX: "2" INDICATES TWICE THE STANDARD)
- - AREAS EXCEEDING PADEP STANDARDS FOR LEAD AND/OR ARSENIC (SEE NOTE, TOP LEFT)
- - AREAS MEETING PADEP STANDARDS FOR LEAD AND/OR ARSENIC (SEE NOTE, TOP LEFT)

Delval
Soil & Val
Environmental
Consultants Inc.

Sky Run II • Suite A1 • 4050 Skyron Drive • Doylestown, PA 18901
Phone (215) 345-5545 Fax (215) 345-8138

**FIGURE 5:
INTERPOLATED ARSENIC AND
LEAD CONCENTRATIONS
INSIDE GREENHOUSES (0-6')**

MADE FOR
**THE CUTLER GROUP
ZEIGER PROPERTIES**

SITUATE IN
**UPPER DUBLIN TOWNSHIP
MONTGOMERY COUNTY, PA**

DELVAL#: 05-611A

01/2000 Job File 12005 Job 05-611a 01.dwg/FIGURES DM PIV FIGURES DM.ppt - 11.05.012-A

The exceedence areas depicted in this diagram are based on the interpolation of lead and/or arsenic concentrations which were identified at discrete locations. Actual concentrations at other locations may differ from interpolated values represented in the model. For further detail see accompanying report.

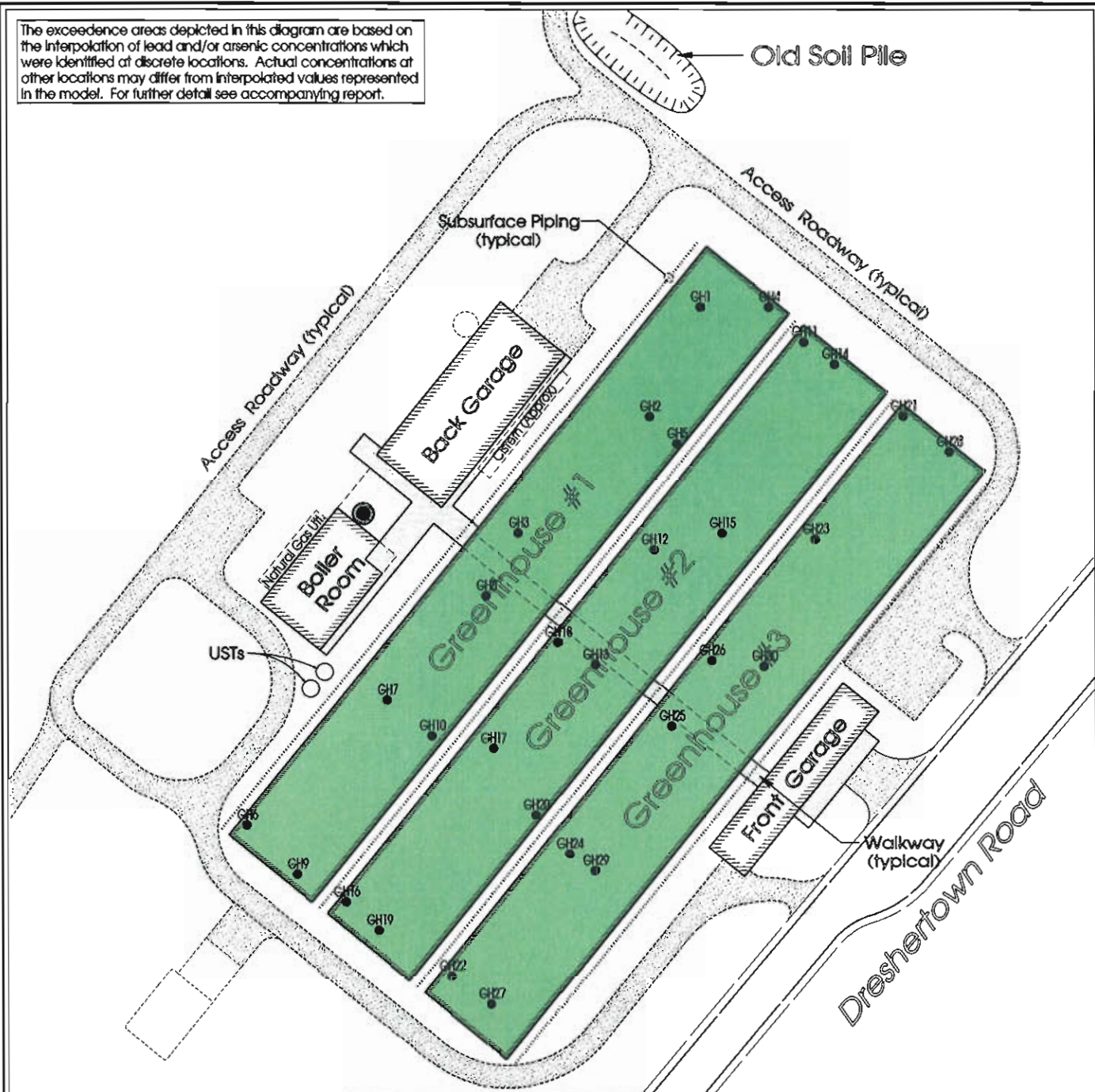

LEGEND

- SS00 - SOIL SAMPLE LOCATION & IDENTIFICATION
- - - EXCEEDENCE FACTOR "CONTOUR" (EX: "2" INDICATES TWICE THE STANDARD)
- - AREAS EXCEEDING PADEP STANDARDS FOR LEAD AND/OR ARSENIC (SEE NOTE, TOP LEFT)
- - AREAS MEETING PADEP STANDARDS FOR LEAD AND/OR ARSENIC (SEE NOTE, TOP LEFT)

**FIGURE 6:
INTERPOLATED ARSENIC AND
LEAD CONCENTRATIONS
INSIDE GREENHOUSES (6-12')**

MADE FOR
**THE CUTLER GROUP
ZEIGER PROPERTIES**

SITUATE IN
**UPPER DUBLIN TOWNSHIP
MONTGOMERY COUNTY, PA**

DELVAL#: 05-611A

U:\2000 Job Files\2005 Jobs\05-611a\Delval\FIGURE6.DWG\FIGURE6.DWG - 11-06-00 12:4

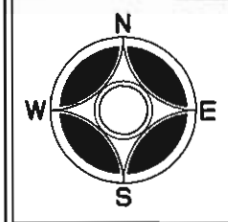

SCALE
1" = 100'

GRAPHIC SCALE

Delval
Soil & Val
Environmental
Consultants Inc.

Sky Run II • Suite A1 • 4030 Skyrun Drive • Doylestown, PA 18901
Phone (215) 345-3545 Fax (215) 345-8138

TABLE 1
Supplemental Delineation
Soil Characterization in Vicinity of Rose Nursery Buildings (Exterior)

1760 and 1756 Dreshertown Road, Dresher 19025
 Upper Dublin Township, Montgomery County, PA

Sample ID	Date Sampled	Approx Sample Depth (inches)	Analysis Name	Result (Dry)	Method Detection Limit	Units	PADEP Direct Contact MSC's (Res)	PADEP Soil to Groundwater MSC's (Res)
SS83A	12/17/2007	6	Metals					
			Arsenic	8.5	1.5	mg/kg	12	150
			Lead	1,970	2.3	mg/kg	500	450
SS83B	12/17/2007	12	Metals					
			Arsenic	7.9	1.3	mg/kg	12	150
			Lead	70.4	0.38	mg/kg	500	450
SS83C	12/17/2007	18	Metals					
			Arsenic	8.0	1.3	mg/kg	12	150
			Lead	27.8	0.38	mg/kg	500	450
SS83D	12/17/2007	24	Metals					
			Arsenic	7.7	1.3	mg/kg	12	150
			Lead	159	0.39	mg/kg	500	450
SS83E	12/17/2007	30	Metals					
			Arsenic	6.6	1.3	mg/kg	12	150
			Lead	31.5	0.38	mg/kg	500	450
SS84A	12/17/2007	6	Metals					
			Arsenic	8.6	1.4	mg/kg	12	150
			Lead	80.0	0.42	mg/kg	500	450
SS84B	12/17/2007	12	Metals					
			Arsenic	4.3	1.3	mg/kg	12	150
			Lead	17.3	0.39	mg/kg	500	450
SS84C	12/17/2007	18	Metals					
			Arsenic	6.5	1.3	mg/kg	12	150
			Lead	15.9	0.40	mg/kg	500	450
SS84D	12/17/2007	24	Metals					
			Arsenic	6.5	1.4	mg/kg	12	150
			Lead	16.5	0.41	mg/kg	500	450
SS84E	12/17/2007	30	Metals					
			Arsenic	5.9	1.3	mg/kg	12	150
			Lead	13.5	0.40	mg/kg	500	450

BOLD = above the standard

U = compound not detected at indicated conc.

ND = non detect

J = also found in lab blank

B = Est. result < RL

P = % diff >40%

TABLE 1
Supplemental Delineation
Soil Characterization in Vicinity of Rose Nursery Buildings (Exterior)

1760 and 1756 Dreshertown Road, Dresher 19025
Upper Dublin Township, Montgomery County, PA

Sample ID	Date Sampled	Approx Sample Depth (Inches)	Analysis Name	Result (Dry)	Method Detection Limit	Units	PADEP Direct Contact MSCs (Res)	PADEP Soil to Groundwater MSCs (Res)
SS85A	12/17/2007	6	Metals					
			Arsenic	5.3	1.4	mg/kg	12	150
			Lead	39.3	0.41	mg/kg	500	450
SS85B	12/17/2007	12	Metals					
			Arsenic	3.7	2.6	mg/kg	12	150
			Lead	11.4	0.78	mg/kg	500	450
SS85C	12/17/2007	18	Metals					
			Arsenic	3.4	1.3	mg/kg	12	150
			Lead	9.9	0.40	mg/kg	500	450
SS85D	12/17/2007	24	Metals					
			Arsenic	6.3	1.3	mg/kg	12	150
			Lead	10.5	0.38	mg/kg	500	450
SS85E	12/17/2007	30	Metals					
			Arsenic	5.8	1.3	mg/kg	12	150
			Lead	10	0.38	mg/kg	500	450
SS86A	12/17/2007	6	Metals					
			Arsenic	7.7	1.4	mg/kg	12	150
			Lead	1,380	2.1	mg/kg	500	450
SS86B	12/17/2007	12	Metals					
			Arsenic	4.9	1.2	mg/kg	12	150
			Lead	378	0.36	mg/kg	500	450
SS86C	12/17/2007	18	Metals					
			Arsenic	4.9	1.3	mg/kg	12	150
			Lead	20.0	0.38	mg/kg	500	450
SS86D	12/17/2007	24	Metals					
			Arsenic	2.9	1.2	mg/kg	12	150
			Lead	6.4	0.37	mg/kg	500	450
SS86E	12/17/2007	30	Metals					
			Arsenic	6.9	1.3	mg/kg	12	150
			Lead	9.1	0.38	mg/kg	500	450

BOLD = above the standard

U = compound not detected at indicated conc.

ND = non detect

J = also found in lab blank

B = Est. result < RL

P = % diff >40%

TABLE 1
Supplemental Delineation
Soil Characterization in Vicinity of Rose Nursery Buildings (Exterior)

1760 and 1756 Dreshertown Road, Dresher 19025
 Upper Dublin Township, Montgomery County, PA

Sample ID	Date Sampled	Approx. Sample Depth (inches)	Analysis Name	Result (Dry)	Method Detection Limit	Units	PADEP Direct-Contact MSCs (Res)	PADEP Soil to Groundwater MSCs (Res)	
SS87A	12/17/2007	6	Metals						
			Arsenic	13.2	1.5	mg/kg	12	150	
			Lead	10,900	11.4	mg/kg	500	450	
SS87B	12/17/2007	12	Metals						
			Arsenic	5.8	1.2	mg/kg	12	150	
			Lead	13.1	0.37	mg/kg	500	450	
SS87C	12/17/2007	18	Metals						
			Arsenic	7.6	1.2	mg/kg	12	150	
			Lead	9.3	0.36	mg/kg	500	450	
SS87D	12/17/2007	24	Metals						
			Arsenic	5.0	1.2	mg/kg	12	150	
			Lead	12.2	0.36	mg/kg	500	450	
SS87E	12/17/2007	30	Metals						
			Arsenic	4.1	1.2	mg/kg	12	150	
			Lead	25.6	0.36	mg/kg	500	450	
SS88A	12/17/2007	6	Metals						
			Arsenic	8.0	1.4	mg/kg	12	150	
			Lead	41.4	0.41	mg/kg	500	450	
SS88B	12/17/2007	12	Metals						
			Arsenic	6.4	1.2	mg/kg	12	150	
			Lead	20.9	0.37	mg/kg	500	450	
SS88C	12/17/2007	18	Metals						
			Arsenic	7.0	1.2	mg/kg	12	150	
			Lead	12.7	0.37	mg/kg	500	450	
SS88D	12/17/2007	24	Metals						
			Arsenic	5.8	1.3	mg/kg	12	150	
			Lead	10.1	0.38	mg/kg	500	450	
SS88E	12/17/2007	30	Metals						
			Arsenic	3.4	1.2	mg/kg	12	150	
			Lead	7.1	0.36	mg/kg	500	450	

BOLD = above the standard
 U = compound not detected at indicated conc.
 ND = non detect
 J = also found in lab blank
 B = Est. result < RL
 P = % diff >40%

TABLE 1
Supplemental Delineation
Soil Characterization in Vicinity of Rose Nursery Buildings (Exterior)

1760 and 1756 Dreshertown Road, Dresher 19025
Upper Dublin Township, Montgomery County, PA

Sample ID	Date Sampled	Approx. Sample Depth (Inches)	Analysis Name	Result (Dry)	Method Detection Limit	Units	PADEP Direct Contact MSCs (Res)	PADEP Soil to Groundwater MSCs (Res)
SS89A	12/17/2007	6	Metals					
			Arsenic	7.2	1.4	mg/kg	12	150
			Lead	267	0.42	mg/kg	500	450
SS89B	12/17/2007	12	Metals					
			Arsenic	7.4	1.2	mg/kg	12	150
			Lead	26.1	0.36	mg/kg	500	450
SS89C	12/17/2007	18	Metals					
			Arsenic	6.2	1.2	mg/kg	12	150
			Lead	14.1	0.37	mg/kg	500	450
SS89D	12/17/2007	24	Metals					
			Arsenic	5.8	1.2	mg/kg	12	150
			Lead	12.2	0.37	mg/kg	500	450
SS89E	12/17/2007	30	Metals					
			Arsenic	5.7	1.2	mg/kg	12	150
			Lead	9.2	0.37	mg/kg	500	450
SS90A	12/17/2007	6	Metals					
			Arsenic	19.3	1.3	mg/kg	12	150
			Lead	417	0.39	mg/kg	500	450
SS90B	12/17/2007	12	Metals					
			Arsenic	4.7	1.2	mg/kg	12	150
			Lead	13.1	0.36	mg/kg	500	450
SS90C	12/17/2007	18	Metals					
			Arsenic	6.4	1.2	mg/kg	12	150
			Lead	43.5	0.37	mg/kg	500	450
SS90D	12/17/2007	24	Metals					
			Arsenic	2.8	1.1	mg/kg	12	150
			Lead	13.3	0.34	mg/kg	500	450
SS90E	12/17/2007	30	Metals					
			Arsenic	2.4	1.1	mg/kg	12	150
			Lead	10.4	0.34	mg/kg	500	450

BOLD = above the standard

U = compound not detected at indicated conc.

ND = non detect

J = also found in lab blank

B = Est. result < RL

P = % diff >40%

TABLE 1
Supplemental Delineation
Soil Characterization in Vicinity of Rose Nursery Buildings (Exterior)

1760 and 1756 Dreshertown Road, Dresher 19025
 Upper Dublin Township, Montgomery County, PA

Sample ID	Date Sampled	Approx Sample Depth (inches)	Analysis Name	Result (Dry)	Method Detection Limit	Units	PADEP Direct Contact MSCs (Res)	PADEP Spill to Groundwater MSCs (Res)	
SS91A	12/17/2007	6	Metals						
			Arsenic	7.1	1.4	mg/kg	12	150	
			Lead	42.9	0.43	mg/kg	500	450	
SS91B	12/17/2007	12	Metals						
			Arsenic	5.9	1.2	mg/kg	12	150	
			Lead	19.4	0.36	mg/kg	500	450	
SS91C	12/17/2007	18	Metals						
			Arsenic	7.6	1.3	mg/kg	12	150	
			Lead	18.7	0.38	mg/kg	500	450	
SS91D	12/17/2007	24	Metals						
			Arsenic	6.0	1.2	mg/kg	12	150	
			Lead	9.8	0.37	mg/kg	500	450	
SS91E	12/17/2007	30	Metals						
			Arsenic	5.5	1.3	mg/kg	12	150	
			Lead	9.4	0.38	mg/kg	500	450	
SS92A	12/17/2007	6	Metals						
			Arsenic	5.7	1.4	mg/kg	12	150	
			Lead	39.6	0.42	mg/kg	500	450	
SS92B	12/17/2007	12	Metals						
			Arsenic	5.1	1.2	mg/kg	12	150	
			Lead	9.7	0.37	mg/kg	500	450	
SS92C	12/17/2007	18	Metals						
			Arsenic	7.1	1.3	mg/kg	12	150	
			Lead	11.8	0.38	mg/kg	500	450	
SS92D	12/17/2007	24	Metals						
			Arsenic	5.7	1.2	mg/kg	12	150	
			Lead	9.9	0.37	mg/kg	500	450	
SS92E	12/17/2007	30	Metals						
			Arsenic	4.5	1.2	mg/kg	12	150	
			Lead	8.9	0.36	mg/kg	500	450	

BOLD = above the standard
 U = compound not detected at indicated conc.
 ND = non detect
 J = also found in lab blank
 B = Est. result < RL
 P = % diff >40%

TABLE 1
Supplemental Delineation
Soil Characterization in Vicinity of Rose Nursery Buildings (Exterior)

1760 and 1756 Dreshertown Road, Dresher 19025
 Upper Dublin Township, Montgomery County, PA

Sample ID	Date Sampled	Approx. Sample Depth (inches)	Analysis Name	Result (Dry)	Method Detection Limit	Units	PADBP Direct Contact MSOs (Res)	PADBP Soil to Groundwater MSOs (Res)
SS93A	12/17/2007	6	Metals					
			Arsenic	7.6	1.5	mg/kg	12	150
			Lead	122	0.44	mg/kg	500	450
SS93B	12/17/2007	12	Metals					
			Arsenic	5.1	1.2	mg/kg	12	150
			Lead	20.8	0.36	mg/kg	500	450
SS93C	12/17/2007	18	Metals					
			Arsenic	6.7	1.2	mg/kg	12	150
			Lead	58.8	0.37	mg/kg	500	450
SS93D	12/17/2007	24	Metals					
			Arsenic	5.6	1.2	mg/kg	12	150
			Lead	37.7	0.37	mg/kg	500	450
SS93E	12/17/2007	30	Metals					
			Arsenic	7.9	1.2	mg/kg	12	150
			Lead	12.1	0.37	mg/kg	500	450
SS94A	12/17/2007	6	Metals					
			Arsenic	5.2	1.4	mg/kg	12	150
			Lead	221	0.41	mg/kg	500	450
SS94B	12/17/2007	12	Metals					
			Arsenic	5.7	1.2	mg/kg	12	150
			Lead	21.6	0.37	mg/kg	500	450
SS94C	12/17/2007	18	Metals					
			Arsenic	7.1	1.2	mg/kg	12	150
			Lead	11.5	0.37	mg/kg	500	450
SS94D	12/17/2007	24	Metals					
			Arsenic	6.3	1.3	mg/kg	12	150
			Lead	41.7	0.38	mg/kg	500	450
SS94E	12/17/2007	30	Metals					
			Arsenic	4.5	1.2	mg/kg	12	150
			Lead	16.8	0.36	mg/kg	500	450

BOLD = above the standard
 U = compound not detected at indicated conc.
 ND = non detect
 J = also found in lab blank
 B = Est. result < RL
 P = % diff >40%

TABLE 1
Supplemental Delineation
Soil Characterization in Vicinity of Rose Nursery Buildings (Exterior)

1760 and 1756 Dreshertown Road, Dresher 19025
 Upper Dublin Township, Montgomery County, PA

Sample ID	Date Sampled	Approx. Sample Depth (Inches)	Analysis Name	Result (Dry)	Method	Detection Limit	Units	PADEP Direct Contact MSGs (Res)	PADEP Soil to Groundwater MSGs (Res)
SS95A	12/17/2007	6	Metals						
			Arsenic	8.7	1.4	mg/kg	12	150	
			Lead	169	0.43	mg/kg	500	450	
SS95B	12/17/2007	12	Metals						
			Arsenic	5.5	1.2	mg/kg	12	150	
			Lead	8.9	0.37	mg/kg	500	450	
SS95C	12/17/2007	18	Metals						
			Arsenic	3.4	1.2	mg/kg	12	150	
			Lead	15.5	0.35	mg/kg	500	450	
SS95D	12/17/2007	24	Metals						
			Arsenic	1.5	1.2	mg/kg	12	150	
			Lead	19.2	0.35	mg/kg	500	450	
SS95E	12/17/2007	30	Metals						
			Arsenic	1.8	1.2	mg/kg	12	150	
			Lead	27.3	0.36	mg/kg	500	450	
SS96A	12/17/2007	6	Metals						
			Arsenic	10.9	1.2	mg/kg	12	150	
			Lead	12,000	9.3	mg/kg	500	450	
SS96B	12/17/2007	12	Metals						
			Arsenic	5.4	1.2	mg/kg	12	150	
			Lead	63.9	0.36	mg/kg	500	450	
SS96C	12/17/2007	18	Metals						
			Arsenic	6.0	1.2	mg/kg	12	150	
			Lead	86.1	0.37	mg/kg	500	450	
SS96D	12/17/2007	24	Metals						
			Arsenic	4.7	1.2	mg/kg	12	150	
			Lead	47.2	0.37	mg/kg	500	450	
SS96E	12/17/2007	30	Metals						
			Arsenic	4.2	1.2	mg/kg	12	150	
			Lead	337	0.37	mg/kg	500	450	

BOLD = above the standard

U = compound not detected at indicated conc.

ND = non detect

J = also found in lab blank

B = Est. result < RL

P = % diff >40%

TABLE 1
Supplemental Delineation
Soil Characterization in Vicinity of Rose Nursery Buildings (Exterior)

1760 and 1756 Dreshertown Road, Dresher 19025
Upper Dublin Township, Montgomery County, PA

Sample ID	Date Sampled	Approx. Sample Depth (inches)	Analysis Name	Result (Dry)	Method Detection Limit	Units	PADEP Direct Contact MSCs (Res)	PADEP Soil to Groundwater MSCs (Res)
SS97A	12/17/2007	6	Metals					
			Arsenic	12.1	1.3	mg/kg	12	150
			Lead	26.1	0.39	mg/kg	500	450
SS97B	12/17/2007	12	Metals					
			Arsenic	6.0	1.2	mg/kg	12	150
			Lead	35.2	0.36	mg/kg	500	450
SS97C	12/17/2007	18	Metals					
			Arsenic	10.2	1.3	mg/kg	12	150
			Lead	26.4	0.39	mg/kg	500	450
SS97D	12/17/2007	24	Metals					
			Arsenic	6.4	1.3	mg/kg	12	150
			Lead	10.7	0.38	mg/kg	500	450
SS97E	12/17/2007	30	Metals					
			Arsenic	7.6	1.3	mg/kg	12	150
			Lead	10.4	0.38	mg/kg	500	450
SS98A	12/18/2007	6	Metals					
			Arsenic	9.0	1.2	mg/kg	12	150
			Lead	53.7	0.36	mg/kg	500	450
SS98B	12/18/2007	12	Metals					
			Arsenic	7.1	1.2	mg/kg	12	150
			Lead	10.6	0.37	mg/kg	500	450
SS98C	12/18/2007	18	Metals					
			Arsenic	6.8	1.2	mg/kg	12	150
			Lead	11.4	0.37	mg/kg	500	450
SS98D	12/18/2007	24	Metals					
			Arsenic	6.1	1.2	mg/kg	12	150
			Lead	9.7	0.37	mg/kg	500	450
SS98E	12/18/2007	30	Metals					
			Arsenic	6.2	1.3	mg/kg	12	150
			Lead	8.9	0.38	mg/kg	500	450

BOLD = above the standard

U = compound not detected at indicated conc.

ND = non detect

J = also found in lab blank

B = Est. result < RL

P = % diff >40%

TABLE 1
Supplemental Delineation
Soil Characterization in Vicinity of Rose Nursery Buildings (Exterior)

1760 and 1756 Dreshertown Road, Dresher 19025
 Upper Dublin Township, Montgomery County, PA

Sample ID	Date Sampled	Approx. Sample Depth (inches)	Analysis Name	Result (Dry)	Method Detection Limit	Units	PADEP Direct Contact MSCs (Res)	PADEP Soil to Groundwater MSCs (Res)
SS99A	12/18/2007	6	Metals					
			Arsenic	14.2	1.3	mg/kg	12	150
			Lead	1,060	0.79	mg/kg	500	450
SS99B	12/18/2007	12	Metals					
			Arsenic	8.6	1.2	mg/kg	12	150
			Lead	69.4	0.37	mg/kg	500	450
SS99C	12/18/2007	18	Metals					
			Arsenic	7.5	1.2	mg/kg	12	150
			Lead	57.7	0.37	mg/kg	500	450
SS99D	12/18/2007	24	Metals					
			Arsenic	7.0	1.2	mg/kg	12	150
			Lead	15.2	0.37	mg/kg	500	450
SS99E	12/18/2007	30	Metals					
			Arsenic	8.2	1.2	mg/kg	12	150
			Lead	21.1	0.36	mg/kg	500	450
SS100A	12/18/2007	6	Metals					
			Arsenic	11.1	1.4	mg/kg	12	150
			Lead	3,230	4.1	mg/kg	500	450
SS100B	12/18/2007	12	Metals					
			Arsenic	4.8	1.2	mg/kg	12	150
			Lead	53.9	0.36	mg/kg	500	450
SS100C	12/18/2007	18	Metals					
			Arsenic	6.8	1.3	mg/kg	12	150
			Lead	21.2	0.38	mg/kg	500	450
SS100D	12/18/2007	24	Metals					
			Arsenic	6.5	1.3	mg/kg	12	150
			Lead	31.3	0.38	mg/kg	500	450
SS100E	12/18/2007	30	Metals					
			Arsenic	6.2	1.3	mg/kg	12	150
			Lead	13.1	0.38	mg/kg	500	450

BOLD = above the standard

U = compound not detected at indicated conc.

ND = non detect

J = also found in lab blank

B = Est. result < RL

P = % diff >40%

TABLE 1
Supplemental Delineation
Soil Characterization in Vicinity of Rose Nursery Buildings (Exterior)

1760 and 1756 Dreshertown Road, Dresher 19025
 Upper Dublin Township, Montgomery County, PA

Sample ID	Date Sampled	Approx. Sample Depth (Inches)	Analysis Name	Result (Dry)	Method Detection Limit	Units	PADEP Direct Contact MSCs (Res)	PADEP Soil to Groundwater MSCs (Res)	
SS101A	12/18/2007	6	Metals						
			Arsenic	10.8	1.3	mg/kg	12	150	
			Lead	184	0.40	mg/kg	500	450	
SS101B	12/18/2007	12	Metals						
			Arsenic	8.2	1.3	mg/kg	12	150	
			Lead	28.7	0.38	mg/kg	500	450	
SS101C	12/18/2007	18	Metals						
			Arsenic	4.6	1.2	mg/kg	12	150	
			Lead	13.1	0.37	mg/kg	500	450	
SS101D	12/18/2007	24	Metals						
			Arsenic	6.9	1.2	mg/kg	12	150	
			Lead	13.3	0.37	mg/kg	500	450	
SS101E	12/18/2007	30	Metals						
			Arsenic	7.6	1.3	mg/kg	12	150	
			Lead	12.8	0.38	mg/kg	500	450	
SS102A	12/18/2007	6	Metals						
			Arsenic	38.9	1.5	mg/kg	12	150	
			Lead	158	0.44	mg/kg	500	450	
SS102B	12/18/2007	12	Metals						
			Arsenic	7.4	1.3	mg/kg	12	150	
			Lead	10.9	0.38	mg/kg	500	450	
SS102C	12/18/2007	18	Metals						
			Arsenic	7.0	1.3	mg/kg	12	150	
			Lead	11.4	0.38	mg/kg	500	450	
SS102D	12/18/2007	24	Metals						
			Arsenic	5.5	1.3	mg/kg	12	150	
			Lead	12.3	0.38	mg/kg	500	450	
SS102E	12/18/2007	30	Metals						
			Arsenic	5.8	1.3	mg/kg	12	150	
			Lead	18.0	0.39	mg/kg	500	450	

BOLD = above the standard
 U = compound not detected at indicated conc.
 ND = non detect
 J = also found in lab blank
 B = Est. result < RL
 P = % diff >40%

TABLE 1
Supplemental Delineation
Soil Characterization in Vicinity of Rose Nursery Buildings (Exterior)

1760 and 1756 Dreshertown Road, Dresher 19025
 Upper Dublin Township, Montgomery County, PA

Sample ID	Date Sampled	Approx. Sample Depth (inches)	Analysis Name	Result (Dry)	Method Detection Limit	Units	PADEP Direct Contact MSCs (Res)	PADEP Soil to Groundwater MSCs (Res)
SS103A	12/18/2007	6	Metals					
			Arsenic	6.0	1.4	mg/kg	12	150
			Lead	2,350	2.0	mg/kg	500	450
SS103B	12/18/2007	12	Metals					
			Arsenic	3.1	1.2	mg/kg	12	150
			Lead	138	0.36	mg/kg	500	450
SS103C	12/18/2007	18	Metals					
			Arsenic	4.5	1.2	mg/kg	12	150
			Lead	152	0.37	mg/kg	500	450
SS103D	12/18/2007	24	Metals					
			Arsenic	4.6	1.2	mg/kg	12	150
			Lead	56.2	0.37	mg/kg	500	450
SS103E	12/18/2007	30	Metals					
			Arsenic	5.0	1.2	mg/kg	12	150
			Lead	50.6	0.37	mg/kg	500	450
SS104A	12/18/2007	6	Metals					
			Arsenic	5.5	1.3	mg/kg	12	150
			Lead	1,030	0.81	mg/kg	500	450
SS104B	12/18/2007	12	Metals					
			Arsenic	4.6	1.2	mg/kg	12	150
			Lead	25.3	0.37	mg/kg	500	450
SS104C	12/18/2007	18	Metals					
			Arsenic	4.7	1.3	mg/kg	12	150
			Lead	18.7	0.38	mg/kg	500	450
SS104D	12/18/2007	24	Metals					
			Arsenic	3.7	1.3	mg/kg	12	150
			Lead	11.1	0.38	mg/kg	500	450
SS104E	12/18/2007	30	Metals					
			Arsenic	6.5	1.3	mg/kg	12	150
			Lead	53.4	0.40	mg/kg	500	450

BOLD = above the standard

U = compound not detected at indicated conc.

ND = non detect

J = also found in lab blank

B = Est. result < RL

P = % diff >40%

TABLE 1
Supplemental Delineation
Soil Characterization in Vicinity of Rose Nursery Buildings (Exterior)

1760 and 1756 Dreshertown Road, Dresher 19025
 Upper Dublin Township, Montgomery County, PA

Sample ID	Date Sampled	Approx. Sample Depth (inches)	Analysis Name	Result (Dry)	Method/Detection Limit	Units	PADEP Direct Contact MSCs (Res)	PADEP Soil to Groundwater MSCs (Res)	
SS105A	12/18/2007	6	Metals						
			Arsenic	23.5	1.3	mg/kg	12	150	
			Lead	285	0.40	mg/kg	500	450	
SS105B	12/18/2007	12	Metals						
			Arsenic	3.4	1.2	mg/kg	12	150	
			Lead	7.7	0.36	mg/kg	500	450	
SS105C	12/18/2007	18	Metals						
			Arsenic	1.8	1.2	mg/kg	12	150	
			Lead	4.1	0.35	mg/kg	500	450	
SS105D	12/18/2007	24	Metals						
			Arsenic	1.6	1.1	mg/kg	12	150	
			Lead	3.3	0.34	mg/kg	500	450	
SS105E	12/18/2007	30	Metals						
			Arsenic	1.2	1.1	mg/kg	12	150	
			Lead	6.0	0.33	mg/kg	500	450	

BOLD = above the standard

U = compound not detected at indicated conc.

ND = non detect

J = also found in lab blank

B = Est. result < RL

P = % diff >40%

TABLE 1
Soil Characterization Greenhouses (Interior)

1760 and 1756 Dreshertown Road, Dresher 19025
Upper Dublin Township, Montgomery County, PA

Sample ID	Date Sampled	Approx. Sample Depth (Inches)	Analysis Name	Result (Dry)	Method Detection Limit	Units	PADEP Direct/Contact MSCs (Residential)	PADEP Soil to Groundwater MSCs (Residential)		
SS14	11/14/2005	0-6	Metals							
			Arsenic	5.8	1.0	mg/kg	12	150		
			Lead	1,540	0.58	mg/kg	500	450		
			Pesticides / PCBs							
			Endosulfan II	200	36	µg/kg	1,300,000	130,000		
			Endosulfansulfate	1,000	36	µg/kg	1,300,000	70,000		
			Herbicides							
			2,4-D	18 U	18	µg/kg	2,200,000	7,000		
			2,4,5-TP (Silvex)	18 U	18	µg/kg	1,800,000	5,000		
			2,4,5-T	18 U	18	µg/kg	2,200,000	7,000		
SS15	11/14/2005	0-6	Metals							
			Arsenic	5.0	0.98	mg/kg	12	150		
			Lead	593	0.57	mg/kg	500	450		
			Pesticides / PCBs							
			Endosulfan I	400	140	µg/kg	1,300,000	110,000		
			Endosulfan II	1,300	140	µg/kg	1,300,000	130,000		
			Endosulfansulfate	3,400	140	µg/kg	1,300,000	70,000		
			Herbicides							
			2,4-D	17 U	17	µg/kg	2,200,000	7,000		
			2,4,5-TP (Silvex)	17 U	17	µg/kg	1,800,000	5,000		
2,4,5-T	17 U	17	µg/kg	2,200,000	7,000					
SS16	11/14/2005	0-6	Metals							
			Arsenic	5.1	1.1	mg/kg	12	150		
			Lead	1,140	0.61	mg/kg	500	450		
			Pesticides / PCBs							
			Endosulfan I	17 P	15	µg/kg	1,300,000	110,000		
			Endosulfan II	200	15	µg/kg	1,300,000	130,000		
			Endosulfansulfate	740	15	µg/kg	1,300,000	70,000		
			Herbicides							
			2,4-D	19 U	19	µg/kg	2,200,000	7,000		
			2,4,5-TP (Silvex)	19 U	19	µg/kg	1,800,000	5,000		
2,4,5-T	19 U	19	µg/kg	2,200,000	7,000					

BOLD = above applicable standard
 U = compound not detected at indicated conc
 ND = non detect
 J = also found in lab blank
 P = % diff >40%

TABLE 1
Soil Characterization Greenhouses (Interior)

1760 and 1756 Dreshertown Road, Dresher 19025
Upper Dublin Township, Montgomery County, PA

Sample ID	Date Sampled	Approx Sample Depth (inches)	Analysts Name	Result (Dry)	Method Detection Limit	Units	PADEP Direct Contact MSCs (Residential)	PADEP Soil to Groundwater MSCs (Residential)		
SS23	11/14/2005	0-6	Metals							
			Arsenic	4.8	2.5	mg/kg	12	150		
			Lead	5,140	1.4	mg/kg	500	450		
			Pesticides / PCBs							
			Endosulfan II	37	7.2	µg/kg	1,300,000	130,000		
			Endosulfansulfate	150	7.2	µg/kg	1,300,000	70,000		
			Methoxychlor	7.5 P	7.2	µg/kg	1,100,000	630,000		
			Herbicides							
			2,4-D	18 U	18	µg/kg	2,200,000	7,000		
			2,4,5-TP (Silvex)	18 U	18	µg/kg	1,800,000	5,000		
2,4,5-T	18 U	18	µg/kg	2,200,000	7,000					
SS24	11/14/2005	0-6	Metals							
			Arsenic	ND	1.3	mg/kg	12	150		
			Lead	126	0.75	mg/kg	500	450		
			Pesticides / PCBs							
			Endosulfan I	2,200	190	µg/kg	1,300,000	110,000		
			Endosulfansulfate	5,200	190	µg/kg	1,300,000	70,000		
			Herbicides							
			2,4-D	23 U	23	µg/kg	2,200,000	7,000		
			2,4,5-TP (Silvex)	23 U	23	µg/kg	1,800,000	5,000		
			2,4,5-T	23 U	23	µg/kg	2,200,000	7,000		
SS25	11/14/2005	0-6	Metals							
			Arsenic	U		mg/kg	12	150		
			Lead	298		mg/kg	500	450		
			Pesticides / PCBs							
			Endosulfan I	110	78	µg/kg	1,300,000	110,000		
			Endosulfan II	92	78	µg/kg	1,300,000	130,000		
			Endosulfansulfate	2,600	78	µg/kg	1,300,000	70,000		
			Herbicides							
			2,4-D	39 U	39	µg/kg	2,200,000	7,000		
			2,4,5-TP (Silvex)	39 U	39	µg/kg	1,800,000	5,000		
2,4,5-T	39 U	39	µg/kg	2,200,000	7,000					
GH1A	7/10/06	0-6	Metals							
			Arsenic	30.8	1.1	mg/kg	12	150		
			Lead	1450	1.6	mg/kg	500	450		
GH1B	7/10/06	6-12	Metals							
			Arsenic	5.6	1.1	mg/kg	12	150		
			Lead	448 J	0.32	mg/kg	500	450		
GH1C	7/10/06	12-18	Metals							
			Arsenic	4.2	1.1	mg/kg	12	150		
			Lead	71.8 J	0.32	mg/kg	500	450		

BOLD = above applicable standard
 U = compound not detected at indicated conc
 ND = non detect
 J = also found in lab blank
 P = % diff >40%

TABLE 1
Soil Characterization Greenhouses (Interior)

1760 and 1756 Dreshertown Road, Dresher 19025
Upper Dublin Township, Montgomery County, PA

Sample ID	Date Sampled	Approx Sample Depth (inches)	Analysis Name	Result (Dry)	Method Detection Limit	Units	PADEP Direct Contact MSCs (Residential)	PADEP Soil to Groundwater MSCs (Residential)
GH2A	7/10/06	0-6	Metals					
			Arsenic	4.8	1.1	mg/kg	12	150
			Lead	331 J	0.32	mg/kg	500	450
GH2B	7/10/06	6-12	Metals					
			Arsenic	4.0	1.2	mg/kg	12	150
			Lead	13.7 J	0.36	mg/kg	500	450
GH2C	7/10/06	12-18	Metals					
			Arsenic	2.9	1.1	mg/kg	12	150
			Lead	5.5 J	0.34	mg/kg	500	450
GH3A	7/10/06	0-6	Metals					
			Arsenic	10.5	1.1	mg/kg	12	150
			Lead	54.3 J	0.34	mg/kg	500	450
GH3B	7/10/06	6-12	Metals					
			Arsenic	5.4	1.2	mg/kg	12	150
			Lead	12.8 J	0.36	mg/kg	500	450
GH3C	7/10/06	12-18	Metals					
			Arsenic	5.4	1.2	mg/kg	12	150
			Lead	23.1 J	0.36	mg/kg	500	450
GH4A	7/10/06	0-6	Metals					
			Arsenic	8.8	1.1	mg/kg	12	150
			Lead	86.1 J	0.33	mg/kg	500	450
GH4B	7/10/06	6-12	Metals					
			Arsenic	5.0	1.1	mg/kg	12	150
			Lead	9.4 J	0.33	mg/kg	500	450
GH4C	7/10/06	12-18	Metals					
			Arsenic	2.2	1.1	mg/kg	12	150
			Lead	8.3 J	0.32	mg/kg	500	450
GH5A	7/10/06	0-6	Metals					
			Arsenic	5.4	1.2	mg/kg	12	150
			Lead	1,960 J	1.7	mg/kg	500	450
GH5B	7/10/06	6-12	Metals					
			Arsenic	4.9	1.2	mg/kg	12	150
			Lead	10.7 J	0.37	mg/kg	500	450
GH5C	7/10/06	12-18	Metals					
			Arsenic	5.8	1.2	mg/kg	12	150
			Lead	11.8 J	0.36	mg/kg	500	450
GH6A	7/11/06	0-6	Metals					
			Arsenic	10.7	5.7	mg/kg	12	150
			Lead	163	1.7	mg/kg	500	450

BOLD = above applicable standard
 U = compound not detected at indicated conc
 ND = non detect
 J = also found in lab blank
 P = % diff >40%

TABLE 1
Soil Characterization Greenhouses (Interior)

1760 and 1756 Dreshertown Road, Dresher 19025
Upper Dublin Township, Montgomery County, PA

Sample ID	Date Sampled	Approx Sample Depth (inches)	Analysis Name	Result (Dry)	Method Detection Limit	Units	PADEP Direct Contact MSCs (Residential)	PADEP Soil to Groundwater MSCs (Residential)	
GH6B	7/11/06	6-12	Metals						
			Arsenic	6.8	1.2	mg/kg	12	150	
			Lead	15.5	0.37	mg/kg	500	450	
GH6C	7/11/06	12-18	Metals						
			Arsenic	8.7	1.2	mg/kg	12	150	
			Lead	34.3	0.36	mg/kg	500	450	
GH7A	7/11/06	0-6	Metals						
			Arsenic	4.6	1.2	mg/kg	12	150	
			Lead	21.3	0.35	mg/kg	500	450	
GH7B	7/11/06	6-12	Metals						
			Arsenic	7.5	1.2	mg/kg	12	150	
			Lead	10.5	0.36	mg/kg	500	450	
GH7C	7/11/06	12-18	Metals						
			Arsenic	9.1	1.2	mg/kg	12	150	
			Lead	28.1	0.37	mg/kg	500	450	
GH8A	7/11/06	0-6	Metals						
			Arsenic	8.4	1.1	mg/kg	12	150	
			Lead	446	0.33	mg/kg	500	450	
GH8B	7/11/06	6-12	Metals						
			Arsenic	3.8	1.2	mg/kg	12	150	
			Lead	16.4	0.35	mg/kg	500	450	
GH8C	7/11/06	12-18	Metals						
			Arsenic	4.7	1.2	mg/kg	12	150	
			Lead	8.6	0.35	mg/kg	500	450	
GH9A	7/11/06	0-6	Metals						
			Arsenic	51.6	1.1	mg/kg	12	150	
			Lead	663	0.65	mg/kg	500	450	
GH9B	7/11/06	6-12	Metals						
			Arsenic	6.0	1.2	mg/kg	12	150	
			Lead	13.5	0.35	mg/kg	500	450	
GH9C	7/11/06	12-18	Metals						
			Arsenic	7.7	1.2	mg/kg	12	150	
			Lead	12.7	0.37	mg/kg	500	450	
GH10A	7/11/06	0-6	Metals						
			Arsenic	13.9	1.1	mg/kg	12	150	
			Lead	1290	1.7	mg/kg	500	450	
GH10B	7/11/06	6-12	Metals						
			Arsenic	4.5	1.2	mg/kg	12	150	
			Lead	47.0	0.35	mg/kg	500	450	

BOLD = above applicable standard
 U = compound not detected at indicated conc
 ND = non detect
 J = also found in lab blank
 P = % diff >40%

TABLE 1
Soil Characterization Greenhouses (Interior)

1760 and 1756 Dreshertown Road, Dresher 19025
Upper Dublin Township, Montgomery County, PA

Sample ID	Date Sampled	Approx Sample Depth (inches)	Analysis Name	Result (Dry)	Method Detection Limit	Units	PADEP Direct Contact MSCs (Residential)	PADEP Soil to Groundwater MSCs (Residential)	
GH10C	7/11/06	12-18	Metals						
			Arsenic	3.7	1.3	mg/kg	12	150	
			Lead	19.7 J	0.38	mg/kg	500	450	
GH11A	7/12/06	0-6	Metals						
			Arsenic	24.3	1.1	mg/kg	12	150	
			Lead	930	0.64	mg/kg	500	450	
GH11B	7/12/06	6-12	Metals						
			Arsenic	2.3	1.1	mg/kg	12	150	
			Lead	46.1	0.33	mg/kg	500	450	
GH11C	7/12/06	12-18	Metals						
			Arsenic	4.3	1.1	mg/kg	12	150	
			Lead	132	0.33	mg/kg	500	450	
GH12A	7/12/06	0-6	Metals						
			Arsenic	1.4	1.1	mg/kg	12	150	
			Lead	134	0.34	mg/kg	500	450	
GH12B	7/12/06	6-12	Metals						
			Arsenic	3.7	1.1	mg/kg	12	150	
			Lead	6.3	0.34	mg/kg	500	450	
GH12C	7/12/06	12-18	Metals						
			Arsenic	3.5	1.1	mg/kg	12	150	
			Lead	15.7	0.34	mg/kg	500	450	
GH13A	7/12/06	0-6	Metals						
			Arsenic	12.8	1.1	mg/kg	12	150	
			Lead	335	0.34	mg/kg	500	450	
GH13B	7/12/06	6-12	Metals						
			Arsenic	5.2	1.2	mg/kg	12	150	
			Lead	8.8	0.35	mg/kg	500	450	
GH13C	7/12/06	12-18	Metals						
			Arsenic	6.7	1.2	mg/kg	12	150	
			Lead	9.4	0.36	mg/kg	500	450	
GH14A	7/12/06	0-6	Metals						
			Arsenic	22.3	1.1	mg/kg	12	150	
			Lead	1990	1.7	mg/kg	500	450	
GH14B	7/12/06	6-12	Metals						
			Arsenic	2.4	1.1	mg/kg	12	150	
			Lead	7.2	0.34	mg/kg	500	450	
GH14C	7/12/06	12-18	Metals						
			Arsenic	1.2	1.1	mg/kg	12	150	
			Lead	2.2	0.34	mg/kg	500	450	

BOLD = above applicable standard
 U = compound not detected at indicated conc
 ND = non detect
 J = also found in lab blank
 P = % diff >40%

TABLE 1
Soil Characterization Greenhouses (Interior)

1760 and 1756 Dreshertown Road, Dresher 19025
Upper Dublin Township, Montgomery County, PA

Sample ID	Date Sampled	Approx Sample Depth (inches)	Analysis Name	Result (Dry)	Method Detection Limit	Units	PADEP Direct Contact MSCs (Residential)	PADEP Soil to Groundwater MSCs (Residential)	
GH15A	7/12/06	0-6	Metals						
			Arsenic	0.65 B	1.1	mg/kg	12	150	
			Lead	262	0.34	mg/kg	500	450	
GH15B	7/12/06	6-12	Metals						
			Arsenic	4.3	1.2	mg/kg	12	150	
			Lead	8.5	0.36	mg/kg	500	450	
GH15C	7/12/06	12-18	Metals						
			Arsenic	6.0	1.2	mg/kg	12	150	
			Lead	44.0	0.36	mg/kg	500	450	
GH16A	7/12/06	0-6	Metals						
			Arsenic	5.7	1.1	mg/kg	12	150	
			Lead	848	0.65	mg/kg	500	450	
GH16B	7/12/06	6-12	Metals						
			Arsenic	11.1	1.2	mg/kg	12	150	
			Lead	16.5	0.37	mg/kg	500	450	
GH16C	7/12/06	12-18	Metals						
			Arsenic	7.8	1.3	mg/kg	12	150	
			Lead	19.3	0.38	mg/kg	500	450	
GH17A	7/12/06	0-6	Metals						
			Arsenic	5.0	1.1	mg/kg	12	150	
			Lead	36.9	0.34	mg/kg	500	450	
GH17B	7/12/06	6-12	Metals						
			Arsenic	4.9	1.2	mg/kg	12	150	
			Lead	9.3	0.36	mg/kg	500	450	
GH17C	7/12/06	12-18	Metals						
			Arsenic	7.5	1.2	mg/kg	12	150	
			Lead	18.2	0.37	mg/kg	500	450	
GH18A	7/12/06	0-6	Metals						
			Arsenic	20.3	1.1	mg/kg	12	150	
			Lead	782	0.69	mg/kg	500	450	
GH18B	7/12/06	6-12	Metals						
			Arsenic	3.9	1.2	mg/kg	12	150	
			Lead	297	0.36	mg/kg	500	450	
GH18C	7/12/06	12-18	Metals						
			Arsenic	3.8	1.2	mg/kg	12	150	
			Lead	20.9	0.36	mg/kg	500	450	
GH19A	7/12/06	0-6	Metals						
			Arsenic	3.4	1.0	mg/kg	12	150	
			Lead	344	0.31	mg/kg	500	450	

BOLD = above applicable standard

U = compound not detected at indicated conc

ND = non detect

J = also found in lab blank

P = % diff >40%

TABLE 1
Soil Characterization Greenhouses (Interior)

1760 and 1756 Dreshertown Road, Dresher 19025
Upper Dublin Township, Montgomery County, PA

Sample ID	Date Sampled	Approx. Sample Depth (inches)	Analysis Name	Result (Dry)	Method Detection Limit	Units	PADEP Direct Contact MSCs (Residential)	PADEP Soil to Groundwater MSCs (Residential)	
GH19B	7/12/06	6-12	Metals						
			Arsenic	7.6	1.2	mg/kg	12	150	
			Lead	13.1	0.37	mg/kg	500	450	
GH19C	7/12/06	12-18	Metals						
			Arsenic	6.6	1.2	mg/kg	12	150	
			Lead	13.2	0.37	mg/kg	500	450	
GH20A	7/12/06	0-6	Metals						
			Arsenic	4.7	1.2	mg/kg	12	150	
			Lead	27.2	0.36	mg/kg	500	450	
GH20B	7/12/06	6-12	Metals						
			Arsenic	6.6	1.2	mg/kg	12	150	
			Lead	12.0	0.37	mg/kg	500	450	
GH20C	7/12/06	12-18	Metals						
			Arsenic	3.7	1.2	mg/kg	12	150	
			Lead	15.4	0.37	mg/kg	500	450	
GH21A	7/11/06	0-6	Metals						
			Arsenic	6.5	1.2	mg/kg	12	150	
			Lead	15.2 J	0.35	mg/kg	500	450	
GH21B	7/13/06	6-12	Metals						
			Arsenic	6.9	1.2	mg/kg	12	150	
			Lead	7.7 J	0.36	mg/kg	500	450	
GH21C	7/13/06	12-18	Metals						
			Arsenic	5.1	1.2	mg/kg	12	150	
			Lead	7.9 J	0.36	mg/kg	500	450	
GH22A	7/13/06	0-6	Metals						
			Arsenic	5.4	1.3	mg/kg	12	150	
			Lead	17.6 J	0.38	mg/kg	500	450	
GH22B	7/13/06	6-12	Metals						
			Arsenic	4.9	1.3	mg/kg	12	150	
			Lead	18.4 J	0.38	mg/kg	500	450	
GH22C	7/13/06	12-18	Metals						
			Arsenic	5.4	1.2	mg/kg	12	150	
			Lead	19.3 J	0.37	mg/kg	500	450	
GH23A	7/13/06	0-6	Metals						
			Arsenic	6.0	1.0	mg/kg	12	150	
			Lead	866 J	0.62	mg/kg	500	450	
GH23B	7/13/06	6-12	Metals						
			Arsenic	6.4	1.2	mg/kg	12	150	
			Lead	16.9 J	0.37	mg/kg	500	450	

BOLD = above applicable standard
 U = compound not detected at indicated conc
 ND = non detect
 J = also found in lab blank
 P = % diff >10%

TABLE 1
Soil Characterization Greenhouses (Interior)

1760 and 1756 Dreshertown Road, Dresher 19025
Upper Dublin Township, Montgomery County, PA

Sample ID	Date Sampled	Approx. Sample Depth (inches)	Analysis Name	Result (Dry)	Method Detection Limit	Units	PADEP Direct Contact MSCs (Residential)	PADEP Soil to Groundwater MSCs (Residential)
GH23C	7/13/06	12-18	Metals					
			Arsenic	7.1	1.3	mg/kg	12	150
			Lead	10.2 J	0.38	mg/kg	500	450
GH24A	7/13/06	0-6	Metals					
			Arsenic	9.1	7.6	mg/kg	12	150
			Lead	305 J	2.3	mg/kg	500	450
GH24B	7/13/06	6-12	Metals					
			Arsenic	4.9	1.2	mg/kg	12	150
			Lead	50.7 J	0.37	mg/kg	500	450
GH24C	7/13/06	12-18	Metals					
			Arsenic	4.1	1.3	mg/kg	12	150
			Lead	15.6 J	0.38	mg/kg	500	450
GH25A	7/13/06	0-6	Metals					
			Arsenic	4.3	1.2	mg/kg	12	150
			Lead	16.3 J	0.37	mg/kg	500	450
GH25B	7/13/06	6-12	Metals					
			Arsenic	5.3	1.2	mg/kg	12	150
			Lead	9.1 J	0.36	mg/kg	500	450
GH25C	7/13/06	12-18	Metals					
			Arsenic	6.1	1.3	mg/kg	12	150
			Lead	13.3 J	0.38	mg/kg	500	450
GH26A	7/13/06	0-6	Metals					
			Arsenic	8.6	1.2	mg/kg	12	150
			Lead	250 J	0.36	mg/kg	500	450
GH26B	7/13/06	6-12	Metals					
			Arsenic	4.9	1.2	mg/kg	12	150
			Lead	24.8 J	0.36	mg/kg	500	450
GH26C	7/13/06	12-18	Metals					
			Arsenic	4.0	1.3	mg/kg	12	150
			Lead	33.0 J	0.38	mg/kg	500	450
GH27A	7/13/06	0-6	Metals					
			Arsenic	ND	3.7	mg/kg	12	150
			Lead	74.4 J	1.1	mg/kg	500	450
GH27B	7/13/06	6-12	Metals					
			Arsenic	4.7	1.2	mg/kg	12	150
			Lead	19.8 J	0.37	mg/kg	500	450
GH27C	7/13/06	12-18	Metals					
			Arsenic	4.7	1.3	mg/kg	12	150
			Lead	15.7	0.38	mg/kg	500	450

BOLD = above applicable standard
 U = compound not detected at indicated conc
 ND = non detect
 J = also found in lab blank
 P = % diff >40%

TABLE 1
Soil Characterization Greenhouses (Interior)

1760 and 1756 Dreshertown Road, Dresher 19025
Upper Dublin Township, Montgomery County, PA

Sample ID	Date Sampled	Approx. Sample Depth (inches)	Analysis Name	Result (Dry)	Method Detection Limit	Units	PADEP Direct Contact MSGs (Residential)	PADEP Soil to Groundwater MSCs (Residential)	
GH28A	7/13/06	0-6	Metals						
			Arsenic	6.7	1.1	mg/kg	12	150	
			Lead	26.5	0.34	mg/kg	500	450	
GH28B	7/13/06	6-12	Metals						
			Arsenic	6.1	1.1	mg/kg	12	150	
			Lead	12.1	0.33	mg/kg	500	450	
GH28C	7/13/06	12-18	Metals						
			Arsenic	7.1	1.1	mg/kg	12	150	
			Lead	11.6	0.34	mg/kg	500	450	
GH29A	7/13/06	0-6	Metals						
			Arsenic	7.2	1.2	mg/kg	12	150	
			Lead	14.8	0.37	mg/kg	500	450	
GH29B	7/13/06	6-12	Metals						
			Arsenic	9.4	1.2	mg/kg	12	150	
			Lead	15.2	0.37	mg/kg	500	450	
GH29C	7/13/06	12-18	Metals						
			Arsenic	4.4	1.2	mg/kg	12	150	
			Lead	15.5	0.37	mg/kg	500	450	
GH30A	7/13/06	0-6	Metals						
			Arsenic	4.7	1.3	mg/kg	12	150	
			Lead	1350	1.9	mg/kg	500	450	
GH30B	7/13/06	6-12	Metals						
			Arsenic	6.5	1.2	mg/kg	12	150	
			Lead	9.2	0.37	mg/kg	500	450	
GH30C	7/13/06	12-18	Metals						
			Arsenic	7.4	1.3	mg/kg	12	150	
			Lead	12.3	0.38	mg/kg	500	450	

BOLD = above applicable standard
 U = compound not detected at indicated conc
 ND = non detect
 J = also found in lab blank
 P = % diff >40%

TABLE 1
TCLP - Preliminary Soil Disposal Characterization

1760 and 1756 Dreshertown Road, Dresher 19025
 Upper Dublin Township, Montgomery County, PA

Sample ID	Date Sampled	Approx. Sample Depth (inches)	Analysis Name	Result	Method Detection Limit	Units	PADEP Direct Contact MSCs (Res/Non-Res)	PADEP Soil to Groundwater MSCs (Res/Non-Res)	PADEP Groundwater MSCs (Res)	Chinn Brothers Maximum Value
SS63A	7/12/06	0-6	TCLP Metals							
			Arsenic	0.21 B	0.50	mg/L	-	-	0.010	5
			Lead	0.11 B	0.50	mg/L	-	-	0.005	5
SS68A	7/12/06	0-6	TCLP Metals							
			Arsenic	0.23 B	0.50	mg/L	--	--	0.010	5
			Lead	2.4	0.50	mg/L	--	--	0.005	5
SS76A	7/14/06	0-6	TCLP Metals							
			Arsenic	0.22 B	0.50	mg/L	--	--	0.010	5
			Lead	12.2	0.50	mg/L	-	-	0.005	5
SS79A	7/14/06	0-6	TCLP Metals							
			Arsenic	0.19B	0.50	mg/L	--	--	0.010	5
			Lead	0.028 B	0.50	mg/L	-	-	0.005	5

BOLD = above State standard
 MSCs = medium specific conc.
 mg/kg = milligram per kilogram
 mg/L = milligram per Liter

ND = non detect
 B = est. result; < than RL
 NR = no standard

DelVal Job # 05-611A
 Cutler / Zeiger Roses

TABLE 2
Form U - Preliminary Soil Disposal Characterization

1760 and 1756 Dreshertown Road, Dresher 19025
Upper Dublin Township, Montgomery County, PA

Sample ID	Date Sampled	Analysis Name	Result	Method Detection Limit	Units	Chrin Brothers Maximum Value
Form U	07/12/06	GC/MS Volatiles				
		Benzene	ND	6.5	mg/kg	2,000
		Ethylbenzene	ND	6.5	mg/kg	2,000
		Toluene	ND	6.5	mg/kg	2,000
		Xylenes (total)	ND	19	mg/kg	2,000
		TCLP GC/MS Volatiles				
		Benzene	ND	0.050	mg/L	0.5
		2-butanone	ND	0.050	mg/L	100
		Carbon tetrachloride	ND	0.050	mg/L	0.5
		Chlorobenzene	ND	0.050	mg/L	50
		Chloroform	ND	0.050	mg/L	6
		1,2-dichloroethane	ND	0.050	mg/L	0.5
		1,1-dichloroethene	ND	0.050	mg/L	0.7
		Tetrachlorethene	ND	0.050	mg/L	0.7
		Trichlorethene	ND	0.050	mg/L	0.5
		Vinyl Chloride	ND	0.050	mg/L	0.2
		TCLP GC/MS Semi-Volatiles				
		1,4-dichlorobenzene	ND	0.050	mg/L	7.5
		2,4-dinitrotoluene	ND	0.050	mg/L	0.13
		Hexachlorobenzene	ND	0.050	mg/L	0.13
		Hexachlorobutadiene	ND	0.050	mg/L	0.5
		Hexachloroethane	ND	0.050	mg/L	3
		Nitrobenzene	ND	0.050	mg/L	2
		Pentachlorophenol	ND	0.25	mg/L	50.0
		Pyridine	ND	0.10	mg/L	0.10
		2,4,5-Trichlorophenol	ND	0.050	mg/L	50.0
		2,4,6-Trichlorophenol	ND	0.050	mg/L	2.0
		Cresols (total)	ND	0.050	mg/L	200
		TCLP GC Semi-Volatiles (Herbicides/Pesticides)				
		Chlordane	ND	0.050	mg/L	0.03
		Endrin	ND	0.00050	mg/L	0.021
		Heptachlor	ND	0.00050	mg/L	0.008
		Methoxychlor	ND	0.0010	mg/L	10
		Heptachlor epoxide	ND	0.00050	mg/L	NR
		Lindane	ND	0.00050	mg/L	0.4
		Toxaphene	ND	0.020	mg/L	0.5
		2,4 - D	ND	0.040	mg/L	10
		2,4,5-TP (silvex)	ND	0.010	mg/L	1

BOLD = above Chrin standard
NR = no standard
mg/kg=miligrams/kilogram
mg/L=miligrams/liter

ND=nondetect
B=also found in lab blank
CFS=contains free liquid
CNF=contains no free liquid

DelVal Job 05-611A
Cutler/Zeiger

TABLE 2
Form U - Preliminary Soil Disposal Characterization

1760 and 1756 Dreshertown Road, Dresher 19025
 Upper Dublin Township, Montgomery County, PA

Sample ID	Date Sampled	Analysis Name	Result	Method Detection Limit	Units	Chrin Brothers Maximum Value	
Form U	07/12/06	TCLP Metals					
		Arsenic	0.17B	0.50	mg/L	5	
		Barium	0.64 B,J	10.0	mg/L	10	
		Cadmium	0.0092 B	0.10	mg/L	1	
		Chromium	ND	0.50	mg/L	5	
		Copper	0.0062 B	0.025	mg/L	45	
		Lead	11.7	0.50	mg/L	5	
		Mercury	ND	0.00020	mg/L	0.2	
		Nickel	0.0082 B	0.040	mg/L	90	
		Selenium	ND	0.25	mg/L	1	
		Silver	ND	0.50	mg/L	5	
		Zinc	1.7	0.020	mg/L	95	
		Ignitability					Flash Point >140 F
		Corrosivity					
		pH (initial)					4.3< pH<12.5
		pH (TCLP)					4.3< pH<12.5
		Reactivity					
		Sulfide					<500 mg/kg
		Cyanide					<250 mg/kg
		ASTM Leaching Procedure					
		Chemical Oxygen Demand (COD)					10,000
		Ammonium-Nitrogen					NR
		Oil & Grease					15,000
		Oil & Grease (HEM)					-
		Total petroleum hydrocarbons					5,000
		Paint Filler Test					pass

BOLD = above Chrin standard
 NR = no standard
 mg/kg=miligrams/kilogram
 mg/L=miligrams/liter

ND=nondetect
 B=also found in lab blank
 CFS=contains free liquid
 CNF=contains no free liquid

DeVal Job 05-611A
 Cutler/Zeiger

TABLE 2
Soil Characterization in Vicinity of Rose Nursery Buildings (Exterior)

1760 and 1756 Dreshertown Road, Dresher 19025
Upper Dublin Township, Montgomery County, PA

Sample ID	Date Sampled	Approx Sample Depth (Inches)	Analysis Name	Result (Dry)	Method Detection Limit	Units	PADEP Direct Contact MSCs (Res)	PADEP Soil to Groundwater MSCs (Res)		
SS1	11/14/2005	0-3	Metals							
			Arsenic	4.4	1.2	mg/kg	12	150		
			Lead	314	0.69	mg/kg	500	450		
			Pesticides / PCBs							
				ND	--	µg/kg	--	--		
			Herbicides							
			2,4-D	21 U	21	µg/kg	2,200,000	7,000		
			2,4,5-TP (Silvex)	21 U	21	µg/kg	1,800,000	5,000		
2,4,5-T	21 U	21	µg/kg	2,200,000	7,000					
SS2	11/14/2005	24	Metals							
			Arsenic	12.1	3.5	mg/kg	12	150		
			Lead	10,300	2.0	mg/kg	500	450		
			Pesticides / PCBs							
			4,4'-DDE	110	10	µg/kg	53,000	41,000		
			4,4'-DDT	70	10	µg/kg	53,000	110,000		
			Endosulfansulfate	17	10	µg/kg	1,300,000	70,000		
			Herbicides							
2,4-D	25 U	25	µg/kg	2,200,000	7,000					
2,4,5-TP (Silvex)	25 U	25	µg/kg	1,800,000	5,000					
2,4,5-T	25 U	25	µg/kg	2,200,000	7,000					
SS4	11/14/2005	24	Metals							
			Arsenic	74.8	4.6	mg/kg	12	150		
			Lead	20,400	26.2	mg/kg	500	450		
			Pesticides / PCBs							
			4,4'-DDE	1,400	65	µg/kg	53,000	41,000		
			4,4'-DDT	1,500	65	µg/kg	53,000	110,000		
			Endosulfansulfate	220	65	µg/kg	1,300,000	70,000		
			Herbicides							
2,4-D	32 U	32	µg/kg	2,200,000	7,000					
2,4,5-TP (Silvex)	32 U	32	µg/kg	1,800,000	5,000					
2,4,5-T	32 U	32	µg/kg	2,200,000	7,000					
SS9	11/14/2005	0-3	Metals							
			Arsenic	141	1.2	mg/kg	12	150		
			Lead	90.3	0.71	mg/kg	500	450		
			Pesticides / PCBs							
				ND	--	µg/kg	--	--		
			Herbicides							
			2,4-D	22 U	22	µg/kg	2,200,000	7,000		
			2,4,5-TP (Silvex)	22 U	22	µg/kg	1,800,000	5,000		
2,4,5-T	22 U	22	µg/kg	2,200,000	7,000					

BOLD = above the standard
 U = compound not detected at indicated conc.
 ND = non detect
 J = also found in lab blank
 B = Est. result < RL
 P = % diff >40%

TABLE 2
Soil Characterization in Vicinity of Rose Nursery Buildings (Exterior)

1760 and 1756 Dreshertown Road, Dresher 19025
Upper Dublin Township, Montgomery County, PA

Sample ID	Date Sampled	Approx. Sample Depth (inches)	Analysis Name	Result (Dry)	Method Detection Limit	Units	PADEP Direct Contact MSCs (Res)	PADEP Soil to Groundwater MSCs (Res)		
SS11	11/14/2005	0-6	Metals							
			Arsenic	6.5	1.2	mg/kg	12	150		
			Lead	80.9	0.72	mg/kg	500	450		
			Pesticides / PCBs							
				ND	--	µg/kg	--	--		
			Herbicides							
			2,4-D	22 U	22	µg/kg	2,200,000	7,000		
			2,4,5-TP (Silvex)	22 U	22	µg/kg	1,800,000	5,000		
2,4,5-T	22 U	22	µg/kg	2,200,000	7,000					
SS13	11/14/2005	3	Metals							
			Arsenic	26.0	7.8	mg/kg	12	150		
			Lead	26,000	4.5	mg/kg	500	450		
			Pesticides / PCBs							
			4,4'-DDE	810	22	µg/kg	53,000	41,000		
			4,4'-DDT	560	22	µg/kg	53,000	110,000		
			Endosulfansulfate	26 P	22	µg/kg	1,300,000	70,000		
			Endrin	48 P	22	µg/kg	66,000	5,500		
			Methoxychlor	320 P	22	µg/kg	1,100,000	630,000		
			Herbicides							
			2,4-D	28 U	28	µg/kg	2,200,000	7,000		
			2,4,5-TP (Silvex)	28 U	28	µg/kg	1,800,000	5,000		
2,4,5-T	28 U	28	µg/kg	2,200,000	7,000					
SS26	11/14/2005	24	Metals							
			Arsenic	10.8		mg/kg	12	150		
			Lead	20,400		mg/kg	500	450		
			Pesticides / PCBs							
			4,4'-DDE	41	8.4	µg/kg	53,000	41,000		
			4,4'-DDT	33	8.4	µg/kg	53,000	110,000		
			Endosulfansulfate	28	8.4	µg/kg	1,300,000	70,000		
			Herbicides							
2,4-D	21 U	21	µg/kg	2,200,000	7,000					
2,4,5-TP (Silvex)	21 U	21	µg/kg	1,800,000	5,000					
2,4,5-T	21 U	21	µg/kg	2,200,000	7,000					

BOLD = above the standard
 U = compound not detected at indicated conc.
 ND = non detect
 J = also found in lab blank
 B = Est. result < RL
 P = % diff >40%

TABLE 2
Soil Characterization in Vicinity of Rose Nursery Buildings (Exterior)

1760 and 1756 Dreshertown Road, Dresher 19025
Upper Dublin Township, Montgomery County, PA

Sample ID	Date Sampled	Approx. Sample Depth (inches)	Analysis Name	Result (Dry)	Method Detection Limit	Units	PADEP Direct Contact MSCs (Res)	PADEP Soil to Groundwater MSCs (Res)	
SS27A	7/10/06	0-6	Metals						
			Arsenic	8.1	1.2	mg/kg	12	150	
			Lead	834 J	0.74	mg/kg	500	450	
SS27B	7/10/06	6-12	Metals						
			Arsenic	8.1	1.2	mg/kg	12	150	
			Lead	447 J	0.36	mg/kg	500	450	
SS27C	7/10/06	12-18	Metals						
			Arsenic	8.4	1.2	mg/kg	12	150	
			Lead	500 J	0.37	mg/kg	500	450	
SS28A	7/10/06	0-6	Metals						
			Arsenic	8.0	1.3	mg/kg	12	150	
			Lead	107 J	0.38	mg/kg	500	450	
SS28B	7/10/06	6-12	Metals						
			Arsenic	8.4	1.2	mg/kg	12	150	
			Lead	63.7 J	0.38	mg/kg	500	450	
SS28C	7/10/06	12-18	Metals						
			Arsenic	6.8	1.2	mg/kg	12	150	
			Lead	52.6 J	0.36	mg/kg	500	450	
SS29A	7/10/06	0-6	Metals						
			Arsenic	9.3	1.3	mg/kg	12	150	
			Lead	131 J	0.38	mg/kg	500	450	
SS29B	7/10/06	6-12	Metals						
			Arsenic	11.5	1.2	mg/kg	12	150	
			Lead	66.8 J	0.37	mg/kg	500	450	
SS29C	7/10/06	12-18	Metals						
			Arsenic	8.9	1.2	mg/kg	12	150	
			Lead	94.4 J	0.37	mg/kg	500	450	
SS30A	7/10/06	0-6	Metals						
			Arsenic	24.9	1.2	mg/kg	12	150	
			Lead	2,410 J	1.8	mg/kg	500	450	
SS30B	7/10/06	6-12	Metals						
			Arsenic	21.5	1.2	mg/kg	12	150	
			Lead	2,120 J	1.8	mg/kg	500	450	
SS30C	7/10/06	12-18	Metals						
			Arsenic	20.7	1.2	mg/kg	12	150	
			Lead	1,780 J	1.8	mg/kg	500	450	
SS31A	7/10/06	0-6	Metals						
			Arsenic	8.1	1.4	mg/kg	12	150	
			Lead	1,910 J	2.1	mg/kg	500	450	

BOLD = above the standard
 U = compound not detected at indicated conc.
 ND = non detect
 J = also found in lab blank
 B = Est. result < RL
 P = % diff >40%

TABLE 2
Soil Characterization in Vicinity of Rose Nursery Buildings (Exterior)

1760 and 1756 Dreshertown Road, Dresher 19025
Upper Dublin Township, Montgomery County, PA

Sample ID	Date Sampled	Approx. Sample Depth (inches)	Analysis Name	Result (Dry)	Method Detection Limit	Units	PADEP Direct Contact MSCs (Res)	PADEP Soil to Groundwater MSCs (Res)	
SS31B	7/10/06	6-12	Metals						
			Arsenic	6.6	1.2	mg/kg	12	150	
			Lead	280 J	0.37	mg/kg	500	450	
SS31C	7/10/06	12-18	Metals						
			Arsenic	4.7	1.3	mg/kg	12	150	
			Lead	192 J	0.38	mg/kg	500	450	
SS32A	7/10/06	0-6	Metals						
			Arsenic	5.4	1.2	mg/kg	12	150	
			Lead	776 J	0.73	mg/kg	500	450	
SS32B	7/10/06	6-12	Metals						
			Arsenic	5.6	1.2	mg/kg	12	150	
			Lead	991 J	0.74	mg/kg	500	450	
SS32C	7/10/06	12-18	Metals						
			Arsenic	6.0	1.2	mg/kg	12	150	
			Lead	1,410 J	1.9	mg/kg	500	450	
SS33A	7/10/06	0-6	Metals						
			Arsenic	9.5	1.3	mg/kg	12	150	
			Lead	2,500 J	2.0	mg/kg	500	450	
SS33B	7/10/06	6-12	Metals						
			Arsenic	7.5	1.2	mg/kg	12	150	
			Lead	1,490 J	1.8	mg/kg	500	450	
SS33C	7/10/06	12-18	Metals						
			Arsenic	5.8	1.2	mg/kg	12	150	
			Lead	681 J	0.72	mg/kg	500	450	
SS34A	7/10/06	0-6	Metals						
			Arsenic	4.9	1.2	mg/kg	12	150	
			Lead	92.5 J	0.37	mg/kg	500	450	
SS34B	7/10/06	6-12	Metals						
			Arsenic	5.2	1.2	mg/kg	12	150	
			Lead	127 J	0.37	mg/kg	500	450	
SS34C	7/10/06	12-18	Metals						
			Arsenic	5.2	1.2	mg/kg	12	150	
			Lead	251 J	0.37	mg/kg	500	450	
SS35A	7/10/06	0-6	Metals						
			Arsenic	14.5	1.4	mg/kg	12	150	
			Lead	3,300 J	4.2	mg/kg	500	450	
SS35B	7/10/06	6-12	Metals						
			Arsenic	7.5	1.2	mg/kg	12	150	
			Lead	347 J	0.37	mg/kg	500	450	

BOLD = above the standard

U = compound not detected at indicated conc.

ND = non detect

J = also found in lab blank

B = Est. result < RL

P = % diff >40%

TABLE 2
Soil Characterization in Vicinity of Rose Nursery Buildings (Exterior)

1760 and 1756 Dreshertown Road, Dresher 19025
Upper Dublin Township, Montgomery County, PA

Sample ID	Date Sampled	Approx Sample Depth (inches)	Analysis Name	Result (Dry)	Method Detection Limit	Units	PADEP Direct Contact MSCs (Res)	PADEP Soil to Groundwater MSCs (Res)
SS35C	7/10/06	12-18	Metals					
			Arsenic	8.2	1.2	mg/kg	12	150
			Lead	406 J	0.37	mg/kg	500	450
SS36A	7/10/06	0-6	Metals					
			Arsenic	6.9	1.4	mg/kg	12	150
			Lead	300 J	0.42	mg/kg	500	450
SS36B	7/10/06	6-12	Metals					
			Arsenic	4.9	1.3	mg/kg	12	150
			Lead	83.1 J	0.38	mg/kg	500	450
SS36C	7/10/06	12-18	Metals					
			Arsenic	4.4	1.2	mg/kg	12	150
			Lead	77.5 J	0.36	mg/kg	500	450
SS37A	7/10/06	0-6	Metals					
			Arsenic	12.7	1.3	mg/kg	12	150
			Lead	1,770 J	1.9	mg/kg	500	450
SS37B	7/10/06	6-12	Metals					
			Arsenic	7.9	1.2	mg/kg	12	150
			Lead	389 J	0.37	mg/kg	500	450
SS37C	7/10/06	12-18	Metals					
			Arsenic	7.7	1.3	mg/kg	12	150
			Lead	471 J	0.39	mg/kg	500	450
SS38A	7/10/06	0-6	Metals					
			Arsenic	12.7	1.3	mg/kg	12	150
			Lead	1,530 J	1.9	mg/kg	500	450
SS38B	7/10/06	6-12	Metals					
			Arsenic	7.7	1.2	mg/kg	12	150
			Lead	562 J	0.37	mg/kg	500	450
SS38C	7/10/06	12-18	Metals					
			Arsenic	8.6	1.3	mg/kg	12	150
			Lead	639 J	0.39	mg/kg	500	450
SS39A	7/10/06	0-6	Metals					
			Arsenic	7.8	1.3	mg/kg	12	150
			Lead	2,990 J	4.0	mg/kg	500	450
SS39B	7/10/06	6-12	Metals					
			Arsenic	5.6	1.3	mg/kg	12	150
			Lead	353 J	0.38	mg/kg	500	450
SS39C	7/10/06	12-18	Metals					
			Arsenic	6.0	1.4	mg/kg	12	150
			Lead	935 J	0.83	mg/kg	500	450

BOLD = above the standard

U = compound not detected at indicated conc.

ND = non detect

J = also found in lab blank

B = Est. result < RL

P = % diff >40%

TABLE 2
Soil Characterization in Vicinity of Rose Nursery Buildings (Exterior)

1760 and 1756 Dreshertown Road, Dresher 19025
Upper Dublin Township, Montgomery County, PA

Sample ID	Date Sampled	Approx Sample Depth (inches)	Analysis Name	Result (Dry)	Method Detection Limit	Units	PADEP Direct Contact MSCs (Res)	PADEP Soil to Groundwater MSCs (Res)	
SS40A	7/10/06	0-6	Metals						
			Arsenic	9.0	1.5	mg/kg	12	150	
			Lead	2,690 J	2.2	mg/kg	500	450	
SS40B	7/10/06	6-12	Metals						
			Arsenic	4.7	1.3	mg/kg	12	150	
			Lead	201 J	0.38	mg/kg	500	450	
SS40C	7/10/06	12-18	Metals						
			Arsenic	4.6	1.3	mg/kg	12	150	
			Lead	209 J	0.38	mg/kg	500	450	
SS41A	7/10/06	0-6	Metals						
			Arsenic	6.1	1.4	mg/kg	12	150	
			Lead	189 J	0.42	mg/kg	500	450	
SS41B	7/10/06	6-12	Metals						
			Arsenic	6.1	1.3	mg/kg	12	150	
			Lead	127 J	0.38	mg/kg	500	450	
SS41C	7/10/06	12-18	Metals						
			Arsenic	5.3	1.3	mg/kg	12	150	
			Lead	314 J	0.38	mg/kg	500	450	
SS42A	7/10/06	0-6	Metals						
			Arsenic	7.1	1.8	mg/kg	12	150	
			Lead	2,780	2.8	mg/kg	500	450	
SS42B	7/10/06	6-12	Metals						
			Arsenic	5.0	1.2	mg/kg	12	150	
			Lead	371	0.36	mg/kg	500	450	
SS42C	7/10/06	12-18	Metals						
			Arsenic	5.7	1.2	mg/kg	12	150	
			Lead	357	0.37	mg/kg	500	450	
SS43A	7/10/06	0-6	Metals						
			Arsenic	5.7	1.2	mg/kg	12	150	
			Lead	52.9	0.37	mg/kg	500	450	
SS43B	7/10/06	6-12	Metals						
			Arsenic	5.8	1.3	mg/kg	12	150	
			Lead	47.2	0.38	mg/kg	500	450	
SS43C	7/10/06	12-18	Metals						
			Arsenic	4.1	1.4	mg/kg	12	150	
			Lead	24.4	0.43	mg/kg	500	450	
SS44A	7/10/06	0-6	Metals						
			Arsenic	4.5	1.3	mg/kg	12	150	
			Lead	763	0.77	mg/kg	500	450	

BOLD = above the standard
 U = compound not detected at indicated conc.
 ND = non detect
 J = also found in lab blank
 B = Est. result < RL
 P = % diff >40%

TABLE 2
Soil Characterization in Vicinity of Rose Nursery Buildings (Exterior)

1760 and 1756 Dreshertown Road, Dresher 19025
Upper Dublin Township, Montgomery County, PA

Sample ID	Date Sampled	Approx. Sample Depth (inches)	Analysis Name	Result (Dry)	Method Detection Limit	Units	PADEP Direct Contact MSCs (Res)	PADEP Soil to Groundwater MSCs (Res)	
SS44B	7/10/06	6-12	Metals						
			Arsenic	2.9	1.2	mg/kg	12	150	
			Lead	360	0.37	mg/kg	500	450	
SS44C	7/10/06	12-18	Metals						
			Arsenic	3.7	1.2	mg/kg	12	150	
			Lead	574	0.37	mg/kg	500	450	
SS45A	7/10/06	0-6	Metals						
			Arsenic	33.2	1.5	mg/kg	12	150	
			Lead	179	0.45	mg/kg	500	450	
SS45B	7/10/06	6-12	Metals						
			Arsenic	35.5	1.3	mg/kg	12	150	
			Lead	96.9	0.38	mg/kg	500	450	
SS45C	7/10/06	12-18	Metals						
			Arsenic	31.9	1.3	mg/kg	12	150	
			Lead	127	0.38	mg/kg	500	450	
SS46A	7/10/06	0-6	Metals						
			Arsenic	15.1	1.2	mg/kg	12	150	
			Lead	38.8	0.37	mg/kg	500	450	
SS46B	7/10/06	6-12	Metals						
			Arsenic	15.3	1.2	mg/kg	12	150	
			Lead	29.2	0.36	mg/kg	500	450	
SS46C	7/10/06	12-18	Metals						
			Arsenic	11.6	1.2	mg/kg	12	150	
			Lead	22.6	0.36	mg/kg	500	450	
SS47A	7/10/06	0-6	Metals						
			Arsenic	4.8	1.3	mg/kg	12	150	
			Lead	1,860	2.0	mg/kg	500	450	
SS47B	7/10/06	6-12	Metals						
			Arsenic	5.5	1.2	mg/kg	12	150	
			Lead	545	0.37	mg/kg	500	450	
SS47C	7/10/06	12-18	Metals						
			Arsenic	4.7	1.2	mg/kg	12	150	
			Lead	550	0.36	mg/kg	500	450	
SS48A	7/10/06	0-6	Metals						
			Arsenic	10.1	1.2	mg/kg	12	150	
			Lead	3,330	3.7	mg/kg	500	450	
SS48B	7/10/06	6-12	Metals						
			Arsenic	6.6	1.3	mg/kg	12	150	
			Lead	481	0.38	mg/kg	500	450	

BOLD = above the standard

U = compound not detected at indicated conc.

ND = non detect

J = also found in lab blank

B = Est. result < RL

P = % diff >40%

TABLE 2
Soil Characterization in Vicinity of Rose Nursery Buildings (Exterior)

1760 and 1756 Dreshertown Road, Dresher 19025
Upper Dublin Township, Montgomery County, PA

Sample ID	Date Sampled	Approx. Sample Depth (inches)	Analysis Name	Result (Dry)	Method Detection Limit	Units	PADEP Direct Contact MSCs (Res)	PADEP Soil to Groundwater MSCs (Res)	
SS48C	07/10/06	12-18	Metals						
			Arsenic	5.6	1.3	mg/kg	12	150	
			Lead	594	0.38	mg/kg	500	450	
SS49A	7/10/06	0-6	Metals						
			Arsenic	13.0	1.2	mg/kg	12	150	
			Lead	140	0.37	mg/kg	500	450	
SS49B	7/10/06	6-12	Metals						
			Arsenic	6.9	1.2	mg/kg	12	150	
			Lead	58.1	0.37	mg/kg	500	450	
SS49C	7/10/06	12-18	Metals						
			Arsenic	8.4	1.2	mg/kg	12	150	
			Lead	51.2	0.36	mg/kg	500	450	
SS50A	7/11/06	0-6	Metals						
			Arsenic	7.3	1.3	mg/kg	12	150	
			Lead	193 J	0.38	mg/kg	500	450	
SS50B	7/11/06	6-12	Metals						
			Arsenic	5.8	1.3	mg/kg	12	150	
			Lead	67.1 J	0.38	mg/kg	500	450	
SS50C	7/11/06	12-18	Metals						
			Arsenic	6.2	1.3	mg/kg	12	150	
			Lead	28.2 J	0.40	mg/kg	500	450	
SS51A	7/11/06	0-6	Metals						
			Arsenic	11.4	1.2	mg/kg	12	150	
			Lead	439 J	0.37	mg/kg	500	450	
SS51B	7/11/06	6-12	Metals						
			Arsenic	9.6	1.3	mg/kg	12	150	
			Lead	219 J	0.38	mg/kg	500	450	
SS51C	7/11/06	12-18	Metals						
			Arsenic	5.4	1.5	mg/kg	12	150	
			Lead	55.1 J	0.44	mg/kg	500	450	
SS52A	7/11/06	0-6	Metals						
			Arsenic	6.1	1.2	mg/kg	12	150	
			Lead	1,020 J	0.73	mg/kg	500	450	
SS52B	7/11/06	6-12	Metals						
			Arsenic	6.3	1.2	mg/kg	12	150	
			Lead	435 J	0.37	mg/kg	500	450	
SS52C	7/11/06	12-18	Metals						
			Arsenic	6.6	1.2	mg/kg	12	150	
			Lead	993 J	1.8	mg/kg	500	450	

BOLD = above the standard
 U = compound not detected at indicated conc.
 ND = non detect
 J = also found in lab blank
 B = Est. result < RL
 P = % diff >40%

TABLE 2
Soil Characterization in Vicinity of Rose Nursery Buildings (Exterior)

1760 and 1756 Dreshertown Road, Dresher 19025
Upper Dublin Township, Montgomery County, PA

Sample ID	Date Sampled	Approx. Sample Depth (inches)	Analysis Name	Result (Dry)	Method Detection Limit	Units	PADEP Direct Contact MSCs (Res)	PADEP Soil to Groundwater MSCs (Res)	
SS53A	7/11/06	0-6	Metals						
			Arsenic	7.4	1.2	mg/kg	12	150	
			Lead	62.8 J	0.36	mg/kg	500	450	
SS53B	7/11/06	6-12	Metals						
			Arsenic	6.9	1.2	mg/kg	12	150	
			Lead	58.3 J	0.36	mg/kg	500	450	
SS53C	7/11/06	12-18	Metals						
			Arsenic	5.2	1.1	mg/kg	12	150	
			Lead	23.7 J	0.33	mg/kg	500	450	
SS54A	7/11/06	0-6	Metals						
			Arsenic	5.1	1.2	mg/kg	12	150	
			Lead	99.6 J	0.35	mg/kg	500	450	
SS54B	7/11/06	6-12	Metals						
			Arsenic	4.8	1.2	mg/kg	12	150	
			Lead	59.7 J	0.35	mg/kg	500	450	
SS54C	7/11/06	12-18	Metals						
			Arsenic	4.7	1.1	mg/kg	12	150	
			Lead	74.0 J	0.33	mg/kg	500	450	
SS55A	7/11/06	0-6	Metals						
			Arsenic	12.4	1.2	mg/kg	12	150	
			Lead	209 J	0.35	mg/kg	500	450	
SS55B	7/11/06	6-12	Metals						
			Arsenic	13.2	1.2	mg/kg	12	150	
			Lead	153 J	0.36	mg/kg	500	450	
SS55C	7/11/06	12-18	Metals						
			Arsenic	11.1	1.1	mg/kg	12	150	
			Lead	220 J	0.33	mg/kg	500	450	
SS56A	7/11/06	0-6	Metals						
			Arsenic	5.6	1.2	mg/kg	12	150	
			Lead	132 J	0.35	mg/kg	500	450	
SS56B	7/11/06	6-12	Metals						
			Arsenic	4.3	1.2	mg/kg	12	150	
			Lead	28.4	0.37	mg/kg	500	450	
SS56C	7/11/06	12-18	Metals						
			Arsenic	4.4	1.2	mg/kg	12	150	
			Lead	24.6	0.37	mg/kg	500	450	
SS57A	7/11/06	0-6	Metals						
			Arsenic	8.8	1.4	mg/kg	12	150	
			Lead	1,840	2.1	mg/kg	500	450	

BOLD = above the standard

U = compound not detected at indicated conc.

ND = non detect

J = also found in lab blank

B = Est. result < RL

P = % diff >40%

TABLE 2
Soil Characterization in Vicinity of Rose Nursery Buildings (Exterior)

1760 and 1756 Dreshertown Road, Dresher 19025
Upper Dublin Township, Montgomery County, PA

Sample ID	Date Sampled	Approx. Sample Depth (Inches)	Analysis Name	Result (Dry)	Method Detection Limit	Units	PADEP Direct Contact MSCs (Res)	PADEP Soil to Groundwater MSCs (Res)	
SS57B	7/11/06	6-12	Metals						
			Arsenic	8.0	1.3	mg/kg	12	150	
			Lead	1,210	0.77	mg/kg	500	450	
SS57C	7/11/06	12-18	Metals						
			Arsenic	6.9	1.3	mg/kg	12	150	
			Lead	901	0.76	mg/kg	500	450	
SS58A	7/11/06	0-6	Metals						
			Arsenic	14.7	1.1	mg/kg	12	150	
			Lead	351	0.32	mg/kg	500	450	
SS58B	7/11/06	6-12	Metals						
			Arsenic	10.9	1.2	mg/kg	12	150	
			Lead	27.0	0.35	mg/kg	500	450	
SS58C	7/11/06	12-18	Metals						
			Arsenic	15.9	1.1	mg/kg	12	150	
			Lead	40.2	0.34	mg/kg	500	450	
SS59A	7/11/06	0-6	Metals						
			Arsenic	11.9	1.3	mg/kg	12	150	
			Lead	6,620	9.7	mg/kg	500	450	
SS59B	7/11/06	6-12	Metals						
			Arsenic	7.4	1.2	mg/kg	12	150	
			Lead	522	0.37	mg/kg	500	450	
SS59C	7/11/06	12-18	Metals						
			Arsenic	10.4	1.2	mg/kg	12	150	
			Lead	3,390	3.6	mg/kg	500	450	
SS60A	7/11/06	0-6	Metals						
			Arsenic	8.0	1.3	mg/kg	12	150	
			Lead	81.2	0.39	mg/kg	500	450	
SS60B	7/11/06	6-12	Metals						
			Arsenic	5.0	1.2	mg/kg	12	150	
			Lead	18.5	0.37	mg/kg	500	450	
SS60C	7/11/06	12-18	Metals						
			Arsenic	4.4	1.2	mg/kg	12	150	
			Lead	13.4	0.36	mg/kg	500	450	
SS61A	7/11/06	0-6	Metals						
			Arsenic	5.9	1.2	mg/kg	12	150	
			Lead	369	0.36	mg/kg	500	450	
SS61B	7/11/06	6-12	Metals						
			Arsenic	6.3	1.2	mg/kg	12	150	
			Lead	57.0	0.37	mg/kg	500	450	

BOLD = above the standard

U = compound not detected at indicated conc.

ND = non detect

J = also found in lab blank

B = Est. result < RL

P = % diff >40%

TABLE 2
Soil Characterization in Vicinity of Rose Nursery Buildings (Exterior)

1760 and 1756 Dreshertown Road, Dresher 19025
Upper Dublin Township, Montgomery County, PA

Sample ID	Date Sampled	Approx. Sample Depth (inches)	Analysis Name	Result (Dry)	Method Detection Limit	Units	PADEP Direct Contact MSCs (Res)	PADEP Soil to Groundwater MSCs (Res)	
SS61C	7/11/06	12-18	Metals						
			Arsenic	7.0	1.2	mg/kg	12	150	
			Lead	253	0.36	mg/kg	500	450	
SS62A	7/12/06	0-6	Metals						
			Arsenic	18.0	1.2	mg/kg	12	150	
			Lead	2,050	1.8	mg/kg	500	450	
SS62B	7/12/06	6-12	Metals						
			Arsenic	6.3	1.2	mg/kg	12	150	
			Lead	201	0.36	mg/kg	500	450	
SS62C	7/12/06	12-18	Metals						
			Arsenic	7.3	1.2	mg/kg	12	150	
			Lead	165	0.37	mg/kg	500	450	
SS63A	7/12/06	0-6	Metals						
			Arsenic	9.2	1.2	mg/kg	12	150	
			Lead	134	0.36	mg/kg	500	450	
SS63B	7/12/06	6-12	Metals						
			Arsenic	8.0	1.2	mg/kg	12	150	
			Lead	51.5	0.37	mg/kg	500	450	
SS63C	7/12/06	12-18	Metals						
			Arsenic	6.3	1.2	mg/kg	12	150	
			Lead	24.0	0.37	mg/kg	500	450	
SS64A	7/12/06	0-6	Metals						
			Arsenic	11.5	1.2	mg/kg	12	150	
			Lead	4,170	3.8	mg/kg	500	450	
SS64B	7/12/06	6-12	Metals						
			Arsenic	5.3	1.2	mg/kg	12	150	
			Lead	56.1	0.37	mg/kg	500	450	
SS64C	7/12/06	12-18	Metals						
			Arsenic	2.7	1.2	mg/kg	12	150	
			Lead	48.0	0.36	mg/kg	500	450	
SS65A	7/12/06	0-6	Metals						
			Arsenic	13.2	1.2	mg/kg	12	150	
			Lead	8,530	9.2	mg/kg	500	450	
SS65B	7/12/06	6-12	Metals						
			Arsenic	3.2	1.2	mg/kg	12	150	
			Lead	114	0.36	mg/kg	500	450	
SS65C	7/12/06	12-18	Metals						
			Arsenic	3.3	1.2	mg/kg	12	150	
			Lead	69.0	0.36	mg/kg	500	450	

BOLD = above the standard

U = compound not detected at indicated conc.

ND = non detect

J = also found in lab blank

B = Est. result < RL

P = % diff >40%

TABLE 2
Soil Characterization in Vicinity of Rose Nursery Buildings (Exterior)

1760 and 1756 Dreshertown Road, Dresher 19025
Upper Dublin Township, Montgomery County, PA

Sample ID	Date Sampled	Approx. Sample Depth (inches)	Analysis Name	Result (Dry)	Method Detection Limit	Units	PADEP Direct Contact MSCs (Res)	PADEP Soil to Groundwater MSCs (Res)
SS66A	7/12/06	0-6	Metals					
			Arsenic	8.6	1.2	mg/kg	12	150
			Lead	43.3	0.37	mg/kg	500	450
SS66B	7/12/06	6-12	Metals					
			Arsenic	7.0	1.2	mg/kg	12	150
			Lead	26.5	0.37	mg/kg	500	450
SS66C	7/12/06	12-18	Metals					
			Arsenic	10.7	1.2	mg/kg	12	150
			Lead	73.0	0.36	mg/kg	500	450
SS67A	7/12/06	0-6	Metals					
			Arsenic	4.9	1.2	mg/kg	12	150
			Lead	257	0.37	mg/kg	500	450
SS67B	7/12/06	6-12	Metals					
			Arsenic	2.8	1.2	mg/kg	12	150
			Lead	155	0.37	mg/kg	500	450
SS67C	7/12/06	12-18	Metals					
			Arsenic	2.1	1.2	mg/kg	12	150
			Lead	17.3	0.37	mg/kg	500	450
SS68A	7/12/06	0-6	Metals					
			Arsenic	12.7	1.3	mg/kg	12	150
			Lead	1,130	0.77	mg/kg	500	450
SS68B	7/12/06	6-12	Metals					
			Arsenic	7.6	1.3	mg/kg	12	150
			Lead	971	0.77	mg/kg	500	450
SS68C	7/12/06	12-18	Metals					
			Arsenic	6.9	1.3	mg/kg	12	150
			Lead	367	0.38	mg/kg	500	450
SS69A	7/12/06	0-6	Metals					
			Arsenic	6.8	1.5	mg/kg	12	150
			Lead	329	0.45	mg/kg	500	450
SS69B	7/12/06	6-12	Metals					
			Arsenic	7.5	1.3	mg/kg	12	150
			Lead	20.1	0.39	mg/kg	500	450
SS69C	7/12/06	12-18	Metals					
			Arsenic	5.9	1.3	mg/kg	12	150
			Lead	18.2	0.40	mg/kg	500	450
SS70A	7/12/06	0-6	Metals					
			Arsenic	8.5	1.3	mg/kg	12	150
			Lead	4,410	4.0	mg/kg	500	450

BOLD = above the standard

U = compound not detected at indicated conc.

ND = non detect

J = also found in lab blank

B = Est. result < RL

P = % diff >40%

TABLE 2
Soil Characterization in Vicinity of Rose Nursery Buildings (Exterior)

1760 and 1756 Dreshertown Road, Dresher 19025
Upper Dublin Township, Montgomery County, PA

Sample ID	Date Sampled	Approx Sample Depth (inches)	Analysis Name	Result (Dry)	Method Detection Limit	Units	PADEP Direct Contact MSCs (Res)	PADEP Soil to Groundwater MSCs (Res)	
SS70B	7/12/06	6-12	Metals						
			Arsenic	6.0	1.2	mg/kg	12	150	
			Lead	596	0.37	mg/kg	500	450	
SS70C	7/12/06	12-18	Metals						
			Arsenic	7.0	1.3	mg/kg	12	150	
			Lead	3,420	3.8	mg/kg	500	450	
SS71A	7/12/06	0-6	Metals						
			Arsenic	12.4	1.5	mg/kg	12	150	
			Lead	7,830	10.9	mg/kg	500	450	
SS71B	7/12/06	6-12	Metals						
			Arsenic	4.4	1.3	mg/kg	12	150	
			Lead	298	0.40	mg/kg	500	450	
SS71C	7/12/06	12-18	Metals						
			Arsenic	4.8	1.3	mg/kg	12	150	
			Lead	226	0.40	mg/kg	500	450	
SS72A	7/12/06	0-6	Metals						
			Arsenic	26.0	1.3	mg/kg	12	150	
			Lead	75.5	0.39	mg/kg	500	450	
SS72B	7/12/06	6-12	Metals						
			Arsenic	8.5	1.3	mg/kg	12	150	
			Lead	25.3	0.38	mg/kg	500	450	
SS72C	7/12/06	12-18	Metals						
			Arsenic	7.6	1.3	mg/kg	12	150	
			Lead	18.4	0.38	mg/kg	500	450	
SS73A	7/12/06	0-6	Metals						
			Arsenic	3.5	1.4	mg/kg	12	150	
			Lead	697	0.81	mg/kg	500	450	
SS73B	7/12/06	6-12	Metals						
			Arsenic	1.2	1.2	mg/kg	12	150	
			Lead	17.1	0.37	mg/kg	500	450	
SS73C	7/12/06	12-18	Metals						
			Arsenic	0.79 B	1.3	mg/kg	12	150	
			Lead	31.3	0.38	mg/kg	500	450	
SS74A	7/14/06	0-6	Metals						
			Arsenic	5.8	1.4	mg/kg	12	150	
			Lead	235	0.41	mg/kg	500	450	
SS74B	7/14/06	6-12	Metals						
			Arsenic	3.7	1.1	mg/kg	12	150	
			Lead	32.1	0.34	mg/kg	500	450	

BOLD = above the standard

U = compound not detected at indicated conc.

ND = non detect

J = also found in lab blank

B = Est. result < RL

P = % diff >40%

TABLE 2
Soil Characterization in Vicinity of Rose Nursery Buildings (Exterior)

1760 and 1756 Dreshertown Road, Dresher 19025
Upper Dublin Township, Montgomery County, PA

Sample ID	Date Sampled	Approx. Sample Depth (inches)	Analysis Name	Result (Dry)	Method Detection Limit	Units	PADEP Direct Contact MSCs (Res)	PADEP Soil to Groundwater MSCs (Res)	
SS74C	7/14/06	12-18	Metals						
			Arsenic	2.0	1.1	mg/kg	12	150	
			Lead	17.2	0.34	mg/kg	500	450	
SS75A	7/14/06	0-6	Metals						
			Arsenic	4.7	1.2	mg/kg	12	150	
			Lead	52.4	0.37	mg/kg	500	450	
SS75B	7/14/06	6-12	Metals						
			Arsenic	3.7	1.2	mg/kg	12	150	
			Lead	54.3	0.36	mg/kg	500	450	
SS75C	7/14/06	12-18	Metals						
			Arsenic	3.4	1.2	mg/kg	12	150	
			Lead	43.0	0.36	mg/kg	500	450	
SS76A	7/14/06	0-6	Metals						
			Arsenic	5.3	1.2	mg/kg	12	150	
			Lead	708	0.73	mg/kg	500	450	
SS76B	7/14/06	6-12	Metals						
			Arsenic	5.7	1.2	mg/kg	12	150	
			Lead	152	0.37	mg/kg	500	450	
SS76C	7/14/06	12-18	Metals						
			Arsenic	5.1	1.3	mg/kg	12	150	
			Lead	22.6	0.38	mg/kg	500	450	
SS77A	7/14/06	0-6	Metals						
			Arsenic	6.0	1.3	mg/kg	12	150	
			Lead	2,260	1.9	mg/kg	500	450	
SS77B	7/14/06	6-12	Metals						
			Arsenic	5.5	1.2	mg/kg	12	150	
			Lead	1,510	1.9	mg/kg	500	450	
SS77C	7/14/06	12-18	Metals						
			Arsenic	6.7	1.2	mg/kg	12	150	
			Lead	355 J	0.37	mg/kg	500	450	
SS78A	7/14/06	0-6	Metals						
			Arsenic	46.2	1.2	mg/kg	12	150	
			Lead	362 J	0.37	mg/kg	500	450	
SS78B	7/14/06	6-12	Metals						
			Arsenic	1.8	1.2	mg/kg	12	150	
			Lead	3.2 J	0.37	mg/kg	500	450	
SS78C	7/14/06	12-18	Metals						
			Arsenic	3.2	1.1	mg/kg	12	150	
			Lead	11.0 J	0.34	mg/kg	500	450	

BOLD = above the standard

U = compound not detected at indicated conc.

ND = non detect

J = also found in lab blank

B = Est. result < RL

P = % diff >40%

TABLE 2
Soil Characterization in Vicinity of Rose Nursery Buildings (Exterior)

1760 and 1756 Dreshertown Road, Dresher 19025
Upper Dublin Township, Montgomery County, PA

Sample ID	Date Sampled	Approx. Sample Depth (Inches)	Analysis Name	Result (Dry)	Method Detection Limit	Units	PADEP Direct Contact MSCs (Res)	PADEP Soil to Groundwater MSCs (Res)	
SS79A	7/14/06	0-6	Metals						
			Arsenic	7.8	1.3	mg/kg	12	150	
			Lead	98.2 J	0.40	mg/kg	500	450	
SS79B	7/14/06	6-12	Metals						
			Arsenic	5.7	1.3	mg/kg	12	150	
			Lead	9.3 J	0.38	mg/kg	500	450	
SS79C	7/14/06	12-18	Metals						
			Arsenic	5.6	1.3	mg/kg	12	150	
			Lead	9.9 J	0.38	mg/kg	500	450	
SS80A	7/14/06	0-6	Metals						
			Arsenic	157	1.2	mg/kg	12	150	
			Lead	955 J	0.71	mg/kg	500	450	
SS80B	7/14/06	6-12	Metals						
			Arsenic	64.7	1.2	mg/kg	12	150	
			Lead	535 J	0.37	mg/kg	500	450	
SS80C	7/14/06	12-18	Metals						
			Arsenic	66.3	1.2	mg/kg	12	150	
			Lead	267 J	0.37	mg/kg	500	450	
SS81A	7/14/06	0-6	Metals						
			Arsenic	8.3	1.4	mg/kg	12	150	
			Lead	46.2 J	0.43	mg/kg	500	450	
SS81B	7/14/06	6-12	Metals						
			Arsenic	5.8	1.3	mg/kg	12	150	
			Lead	12.2 J	0.38	mg/kg	500	450	
SS81C	7/14/06	12-18	Metals						
			Arsenic	7.2	1.3	mg/kg	12	150	
			Lead	12.5 J	0.38	mg/kg	500	450	
SS82A	7/14/06	0-6	Metals						
			Arsenic	7.4	1.4	mg/kg	12	150	
			Lead	96.1 J	0.42	mg/kg	500	450	
SS82B	7/14/06	6-12	Metals						
			Arsenic	6.6	1.4	mg/kg	12	150	
			Lead	28.3 J	0.41	mg/kg	500	450	
SS82C	7/14/06	12-18	Metals						
			Arsenic	7.0	1.4	mg/kg	12	150	
			Lead	33.1 J	0.42	mg/kg	500	450	

BOLD = above the standard

U = compound not detected at indicated conc.

ND = non detect

J = also found in lab blank

B = Est. result < RL

P = % diff >40%

TABLE 3
Soil Characterization for Vicinity of "Old" Soil Pile
1760 and 1756 Dreshertown Road, Dresher 19025
Upper Dublin Township, Montgomery County, PA

Sample ID	Date Sampled	Approx. Sample Depth (inches)	Analysis Name	Result (Dry)	Method Detection Limit	Units	PADEP Direct Contact MSCs (Res/Non-Res)	PADEP Soil to Groundwater MSCs (Res/Non-Res)		
SS5	11/14/05	0-6	Total Metals							
			Arsenic	6.9	1.2	mg/kg	12	150		
			Lead	180	0.72	mg/kg	500	450		
			Pesticides / PCBs							
			Endosulfansulfate	14	8.9	µg/kg	1,300,000	70,000		
			Herbicides							
			2,4-D	22 U	22	µg/kg	2,200,000	7,000		
			2,4,5-TP (Silvex)	22 U	22	µg/kg	1,800,000	5,000		
2,4,5-T	22 U	22	µg/kg	2,200,000	7,000					
SS6	11/14/05	0-6	Total Metals							
			Arsenic	12.2	1.4	mg/kg	12	150		
			Lead	516	0.79	mg/kg	500	450		
			Pesticides / PCBs							
			4,4'-DDT	13	9.8	µg/kg	53,000	110,000		
			Methoxychlor	13 P*	9.8	µg/kg	1,100,000	630,000		
			Herbicides							
			2,4,5-T	24 U	24	µg/kg	2,200,000	7,000		
2,4,5-TP (Silvex)	24 U	24	µg/kg	1,800,000	5,000					
2,4-D	24 U	24	µg/kg	2,200,000	7,000					
SS7	11/14/05	0-6	Metals							
			Arsenic	5.3	1.3	mg/kg	12	150		
			Lead	722	0.76	mg/kg	500	450		
			Pesticides / PCBs							
			Methoxychlor	9.7 P*	9.4	µg/kg	1,100,000	630,000		
			Herbicides							
			2,4,5-T	23 U	23	µg/kg	2,200,000	7,000		
			2,4,5-TP (Silvex)	23 U	23	µg/kg	1,800,000	5,000		
2,4-D	23 U	23	µg/kg	2,200,000	7,000					
SS8	11/14/05	0-6	Metals							
			Arsenic	6.1	0.75	mg/kg	12	150		
			Lead	1,080	1.3	mg/kg	500	450		
			Pesticides / PCBs							
				ND	--	µg/kg	--	--		
			Herbicides							
			2,4-D	23 U	23	µg/kg	2,200,000	7,000		
2,4,5-TP (Silvex)	23 U	23	µg/kg	1,800,000	5,000					
2,4,5-T	23 U	23	µg/kg	2,200,000	7,000					

BOLD = above the Standard
 U = compound not detected at indicated conc.
 ND = nondetect
 J = also found in lab blank
 P = % diff >40%

TABLE 3
Soil Characterization for Vicinity of "Old" Soil Pile

1760 and 1756 Dreshertown Road, Dresher 19025
Upper Dublin Township, Montgomery County, PA

Sample ID	Date Sampled	Approx. Sample Depth (inches)	Analysis Name	Result (Dry)	Method Detection Limit	Units	PADEP Direct Contact MSCs (Res/Non-Res)	PADEP Soil to Groundwater MSCs (Res/Non-Res)	
OSP1A	7/14/06	0-6	Total Metals						
			Arsenic	9.3	1.2	mg/kg	12	150	
			Lead	292 J	0.35	mg/kg	500	450	
OSP1B	7/14/06	6-12	Total Metals						
			Arsenic	12.0	1.2	mg/kg	12	150	
			Lead	120 J	0.35	mg/kg	500	450	
OSP1C	7/14/06	12-18	Total Metals						
			Arsenic	9.4	1.2	mg/kg	12	150	
			Lead	108 J	0.36	mg/kg	500	450	
OSP2A	7/14/06	0-6	Total Metals						
			Arsenic	7.0	1.1	mg/kg	12	150	
			Lead	466 J	0.34	mg/kg	500	450	
OSP2B	7/14/06	6-12	Total Metals						
			Arsenic	5.6	1.2	mg/kg	12	150	
			Lead	717 J	0.74	mg/kg	500	450	
OSP2C	7/14/06	12-18	Total Metals						
			Arsenic	6.8	1.2	mg/kg	12	150	
			Lead	1,610 J	1.7	mg/kg	500	450	
OSP3A	7/14/06	0-6	Total Metals						
			Arsenic	6.3	1.3	mg/kg	12	150	
			Lead	4,610 J	3.8	mg/kg	500	450	
OSP3B	7/14/06	6-12	Total Metals						
			Arsenic	7.8	1.4	mg/kg	12	150	
			Lead	829 J	0.82	mg/kg	500	450	
OSP3C	7/14/06	12-18	Total Metals						
			Arsenic	0.87	0.15	mg/kg	12	150	
			Lead	54.2 J	0.046	mg/kg	500	450	

BOLD = above the Standard

U = compound not detected at indicated conc.

ND = nondetect

J = also found in lab blank

P = % diff >40%