

# Know Your Home Fire Sprinkler System

The water main coming into your home supplies the water for the fire sprinkler and the domestic (plumbing) systems.

A main water control valve (1) is on the pipe that supplies water to the sprinkler system. You may also have a control valve on your domestic (3) and sprinkler (4) pipes. The water flows through a check valve (5), or if required by plumbing code, a backflow valve.

## WARNING

Turning off the water to your home will also turn off the water to your fire sprinkler system. Contact your fire sprinkler contractor if you have questions.

Contractor /Fire Department  
Contact Information



If your riser is installed in your garage, you may have a panel like this.

The water meter may be located on the domestic system pipe only or outside of the home.

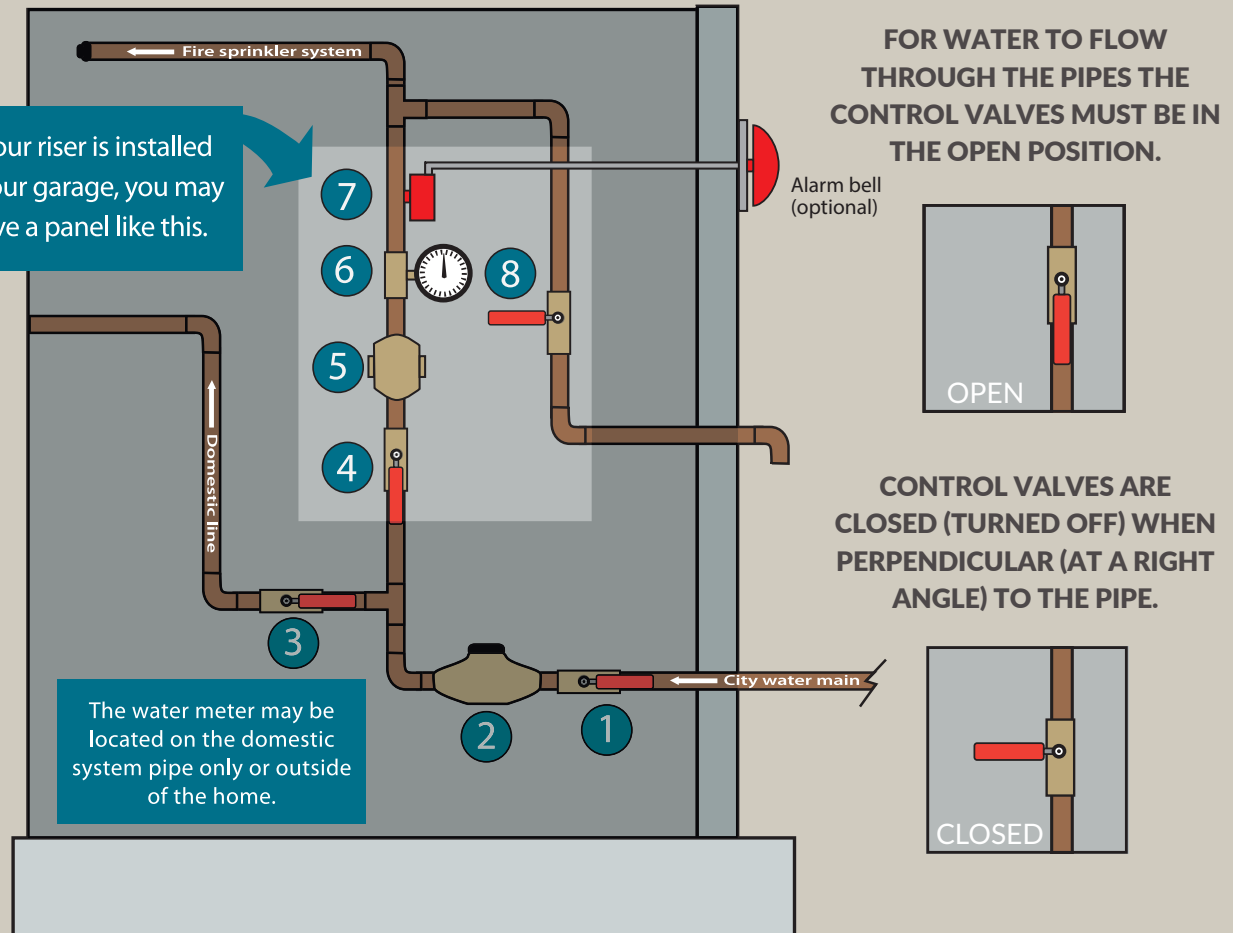

FOR WATER TO FLOW THROUGH THE PIPES THE CONTROL VALVES MUST BE IN THE OPEN POSITION.

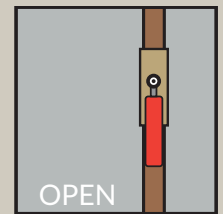

CONTROL VALVES ARE CLOSED (TURNED OFF) WHEN PERPENDICULAR (AT A RIGHT ANGLE) TO THE PIPE.

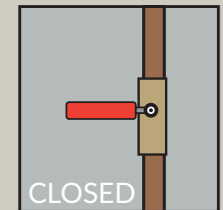

1. Main Control Valve
2. Water Meter
3. Domestic Control Valve
4. Sprinkler Control Valve

5. Check Valve or Backflow Valve
6. Pressure Gauge
7. Flow Switch for Alarm
8. Flow Test Control Valve (Inspector Test Valve)

# Keep Your Fire Sprinklers Working To Protect Your Family and Home

**DO NOT HANG** anything on fire sprinklers or pipes. Even lightweight items can damage sprinklers.

**PROTECT FIRE SPRINKLERS FROM BUMPS.** Be careful when carrying ladders and other large or tall items. Don't bump fire sprinklers or exposed pipes.

**DO NOT PAINT** the fire sprinkler or the cover. While doing messy work, such as painting, cover the sprinklers with plastic. Remove the plastic as soon as you are finished painting.

**DO NOT BLOCK** your fire sprinklers. Keep pictures and large/tall furniture away from sprinklers on the walls. Hang lamps and plants away from ceiling fire sprinklers.

**CONSIDER LOCATION OF PIPES BEHIND THE WALL.** Avoid using nails or screws to hang pictures on the wall near the sprinkler pipe.

**TEACH CHILDREN** not to touch or play with sprinklers or exposed pipes.

Your home has a built-in fire sprinkler system. If you have a fire, the high heat will activate the sprinkler closest to it. Water will control it or put it out so you can escape.

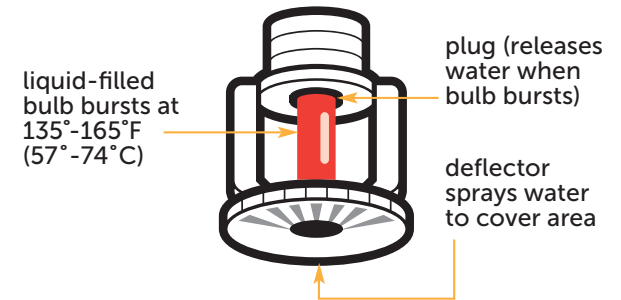

## HOW TO DO A FLOW TEST\*

1. Find your flow test control valve. It may be labeled main drain, inspector test or test and drain. The valve is located on the sprinkler drain and test connection.
2. If your sprinklers are connected to a central alarm, inform the alarm monitoring company or fire department that you are going to do a test.
3. Slowly turn the flow test control valve to the "on" position (bring the valve in line with the pipe). This will start the water running. Let the water run for about 90 seconds. If your system has an alarm, you will hear it as the water is running.
4. You may see a drop in water pressure upon opening the valve. The pressure should stabilize for the 90 seconds it is left open. The stream should be steady and not choppy with air pockets after the initial opening. Water should look relatively clear.
5. Slowly turn the flow test control valve to the "off" position (the valve handle will be perpendicular to or make a right angle to the pipe).
6. Write down the date you tested your system.

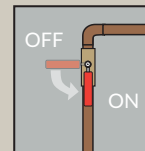

The flow test control valve is on when it is in line with the pipe. It is off when it is perpendicular to the pipe.

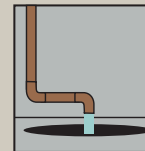

Water may run into a sump pump in the basement.

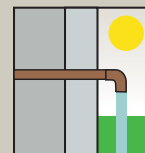

Water may run outside the home.

Write down the date of each test here:

-----

-----

-----

-----

-----

-----

-----

-----



\*NFPA 13D recommends conducting a flow test two times a year.