

In accordance with the vehicle code, the Secretary of Transportation hereby approves the installation and operation of a traffic signal at the intersection of **Virginia Drive and Camp Hill Road in the Township of Upper Dublin, County of Montgomery.**

This permit is issued to, and accepted by the **Township of Upper Dublin** hereinafter known as the Permittee, as follows:

This installation shall be in accordance with the Vehicle Code and the Regulations for the traffic signs, signals and markings of the Department of Transportation, and shall conform to the requirements and those contained on the attached sheets.

Type of Controller: **Fully actuated with emergency pre-emption.**

Type of Signal Mounting: **Overhead.**

Hours of Operation as "Stop" and "Go": **As indicated on the attached diagram.**

Hours of Operation as "FLASHING": **As indicated on the attached diagram.**

Controller Operation: **Controller to provide the phasing, timing and signal display as indicated on the attached diagram.**

All work performed by the Permittee in the installation of the traffic signal shall be under and subject to the direction of the Secretary of Transportation or his representatives. The said Permittee shall use due diligence in the execution of the work authorized under this permit and shall not obstruct or endanger travel along said road. All operations must be conducted so as to permit safe and reasonable free travel at all times over the road within the limits of the work herein permitted.

The Permittee covenants and agree to fully indemnify and save harmless the Department of Transportation and assumes all liability for damages or injury, occurring to any person, persons or property through or in consequences of any act or omission of anyone working on the construction, or from faulty maintenance or operation of such traffic signal.

The Secretary of Transportation, by law, reserves the right to revoke and annul this permit if the Permittee shall at any time willfully or negligently fail to comply with the conditions contained in this permit, or, upon changes in traffic conditions, fail to make any changes in the construction or operation of this signal, or to remove it, when so ordered by the Secretary of Transportation: or if this installation is not in operation within twenty-four (24) months of the receipt of this permit. The Permittee shall maintain the signal in a safe condition at all times. The Permittee shall not make any change in the construction or operation of this traffic signal without prior written approval of the Secretary of Transportation.

This permit cancels and supersedes all previous permits issued for this location upon completion of the installation specified herein.

Issued: January 11, 2022

Approved **Yassmin Gramian, P.E.**
Secretary of Transportation

Paul M. Lutz Digitally signed by Paul M. Lutz
Date: 2022.01.13 14:31:39 -05'00'

By **Louis R. Belmonte, P.E.**
Acting District Executive 6-0

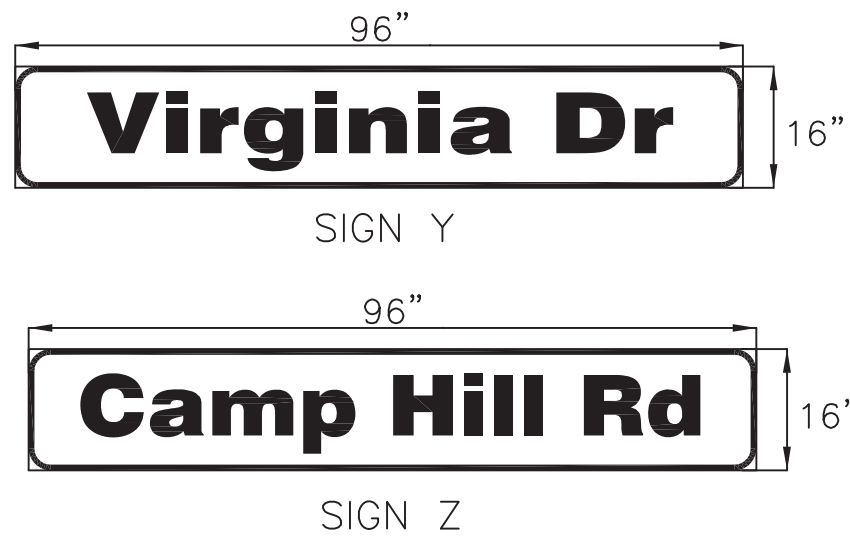

OVERHEAD STREET NAME SIGNS:
 BACKGROUND: REFLECTORIZED WHITE
 BORDER & LEGEND: BLACK
 TEXT: CLEARVIEW BOLD
 8" UPPER CASE
 6" LOWER CASE

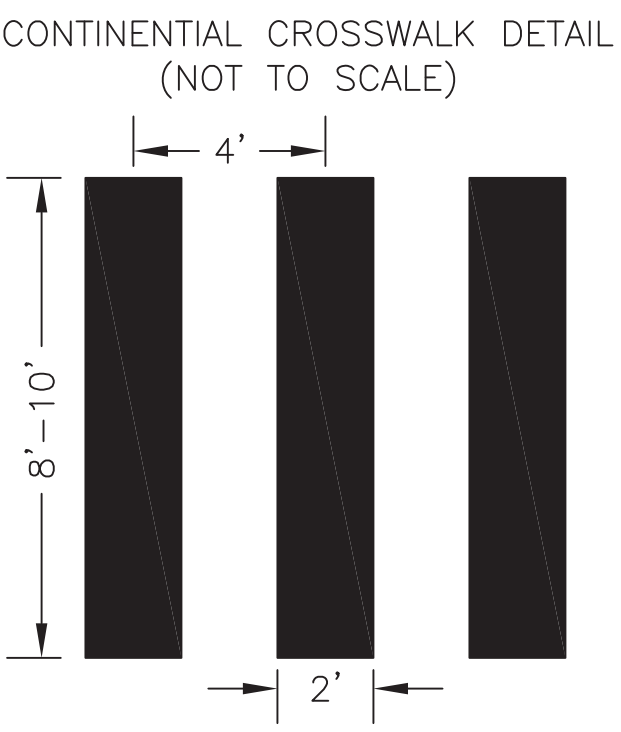

PLAN SYMBOL	SERIES NUMBER	SIZE	REMARKS
(A)	R3-2	30"x30"	NO LEFT TURN
(B)	R3-2	24"x24"	NO LEFT TURN
(C)	R9-3	18"x18"	NO PEDESTRIAN CROSSING
(D)	R10-3E(L)	9"x15"	EDUCATIONAL PUSH BUTTON FOR WALK SIGNAL W/COUNTDOWN TIMER ←
(E)	R10-11	24"x30"	NO TURN ON RED
(F)	R10-20AP	30"x24"	MON-FRI / 7AM-9AM
(G)	R10-20AP	24"x18"	MON-FRI / 7AM-9AM
(H)	W3-3	36"x36"	SIGNAL AHEAD
(I)	W14-7	36"x36"	WATCH FOR STOPPED VEHICLES
(J)	D3-4	96"x16"	Virginia Dr
(K)	D3-4	96"x16"	Camp Hill Rd

GENERAL NOTES

NO MODIFICATIONS OF THIS INSTALLATION ARE PERMITTED UNLESS PRIOR APPROVAL IS GRANTED IN WRITING BY A REPRESENTATIVE OF THE DEPARTMENT OF TRANSPORTATION.

ALL MAINTENANCE WORK INCLUDING TRIMMING OF TREES, NECESSARY FOR PROPER VISIBILITY OF THE SIGNALS IS THE RESPONSIBILITY OF THE PERMITEE.

ALL SIGNS AND PAVEMENT MARKINGS INDICATED ON THIS DRAWING ARE CONSIDERED PART OF THE PERMIT AND SHALL BE INSTALLED AND MAINTAINED IN ACCORDANCE WITH PUBLICATION NO. 212.

POST MOUNTED SIGNALS SHALL BE INSTALLED WITH THE SIGNAL HEADS A MINIMUM OF 2 FEET BEHIND THE FACE OF CURB OR THE EDGE OF THE SHOULDER. SUPPORT POLES FOR OVERHEAD SIGNALS SHALL ALSO HAVE A MINIMUM CLEARANCE HORIZONTALLY OF 2 FEET.

SIGNALS ERECTED OVER THE ROADWAY SHALL HAVE A MINIMUM VERTICAL CLEARANCE OF 16 FT. ABOVE THE ROADWAY. POST MOUNTED SIGNALS SHALL BE A MINIMUM OF 8 FT. ABOVE THE SIDEWALK OR PAVEMENT.

ALL OVERHEAD SIGNALS MUST BE RIGIDLY MOUNTED, TOP AND BOTTOM, AND EQUIPPED WITH BACKPLATES.

THE MINIMUM HORIZONTAL DISTANCE BETWEEN SIGNALS MEASURED AT RIGHT ANGLES TO THE APPROACH SHALL BE 8 FEET.

EXACT LOCATION OF DETECTORS SHALL BE DETERMINED PRIOR TO INSTALLATION BY A REPRESENTATIVE OF PENNDOT.

CURBING TO BE INSTALLED BY MUNICIPALITY AND WHERE NOTED, SHALL BE PLAIN CEMENT CONCRETE CURB OR GRANITE CURB, INSTALLED IN ACCORDANCE WITH DEPARTMENT SPECIFICATIONS FORM 408.

PRIOR TO INSTALLATION THE CONTRACTOR SHALL CONSULT WITH THE LOCAL OFFICIALS AND UTILITY COMPANIES TO RESOLVE ANY PROBLEMS WHICH MAY BE CREATED DUE TO THE LOCATION OF UTILITIES.

THIS DRAWING CANNOT BE USED AS A CONSTRUCTION DRAWING UNLESS THE PERMITEE COMPLIES WITH THE PROVISIONS OF ACT 287, PREVENTION OF DAMAGE TO UNDERGROUND UTILITIES, EFFECTIVE DATE DECEMBER 20, 1974.

WHEN LIQUID FUELS MONEY IS USED, SIGNAL INSTALLATION MUST CONFORM TO FORM 408 AND A COPY OF THE PROPOSED SPECIFICATIONS MUST BE SUBMITTED TO THE DISTRICT TRAFFIC UNIT, FOR REVIEW, PRIOR TO BIDDING.

PERMITEE SHALL OBTAIN A HIGHWAY OCCUPANCY PERMIT FOR ANY CHANGES IN INTERSECTION GEOMETRY REGARDING EXCAVATION.

CONDUIT INSTALLED IN BITUMINOUS ROADWAY LESS THAN 5 YEARS OLD, OR CONCRETE ROADWAY REGARDLESS OF AGE, MUST BE BORED OR JACKED UNDER THE ROADWAY. INSTALL IN ACCORDANCE WITH TRAFFIC SIGNAL STANDARDS TC-8800 SERIES.

MOVEMENT, SEQUENCE, AND TIMING DIAGRAM

PHASE	2+6				4+8				FLASH
	1	2	3	4	5	6	7	8	
1,2	G	G	Y	R	R	R	R	R	Y
3,4,5	G	G	Y	R	R	R	R	R	Y
6,7,8	R	R	R	G	G	G	Y	R	R
9,10,11	R	R	R	R	G	G	Y	R	R
12,13	M	FH	H	H	H	H	H	H	OFF
14,15	M	FH	H	H	H	H	H	H	OFF
16,17	H	H	H	H	M	FH	H	H	OFF

FIXED TIME	4	2	4	3
MINIMUM	15		7	
PASSAGE	3		3	
MAX 1	28		19	
MAX 2	28		19	
PEDESTRIAN*	7	12	7	12
MEMORY	SVR		NL	

OPERATION NOTES

* UPON PEDESTRIAN ACTUATION ONLY. OTHERWISE "H" ALL OTHER TIMES.
 MAX 1 TO OPERATE FROM 6:00 AM TO 9:00 AM MONDAY THROUGH FRIDAY.
 MAX 2 TO OPERATE ALL OTHER TIMES.

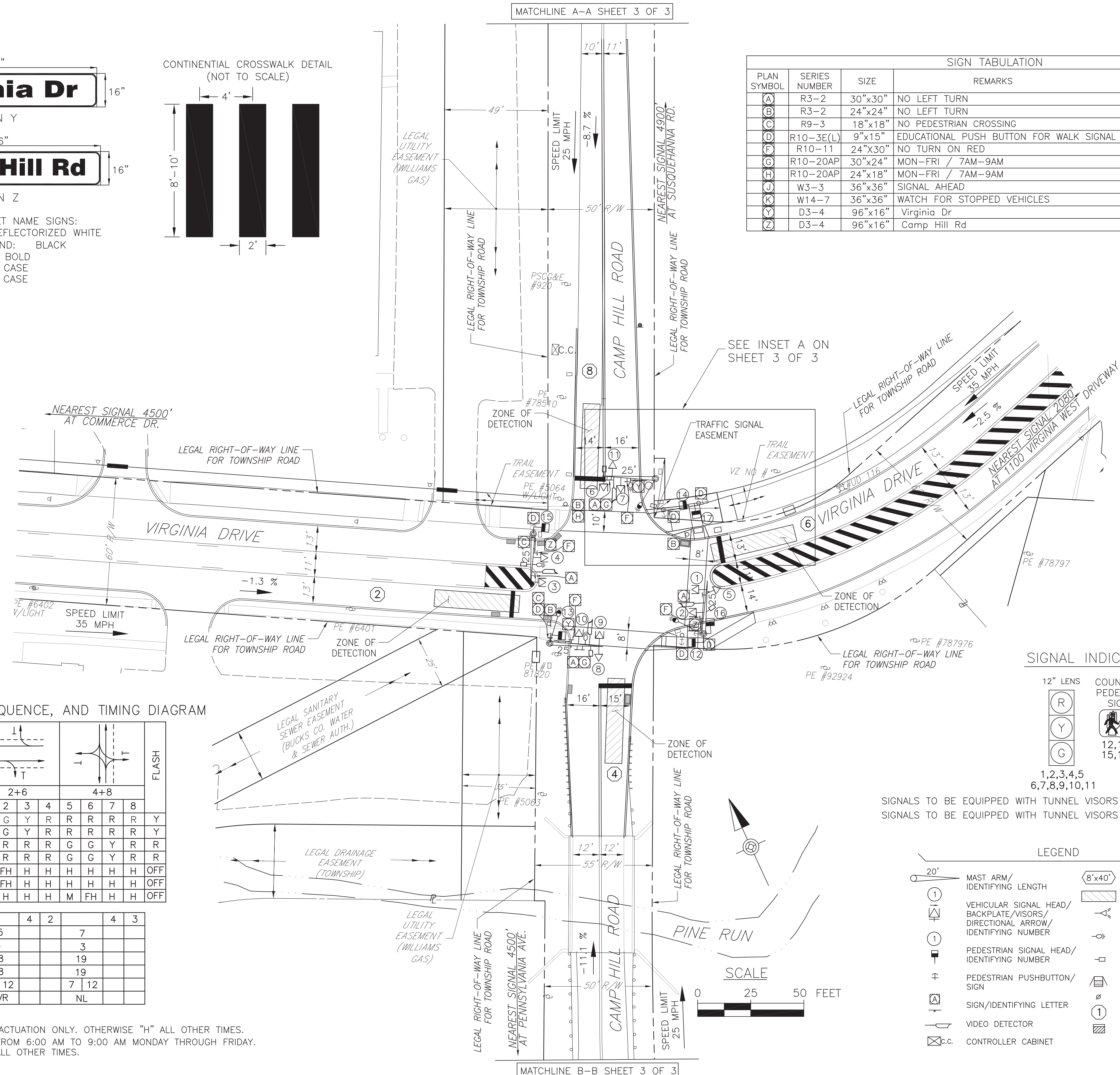

SIGNAL INDICATIONS

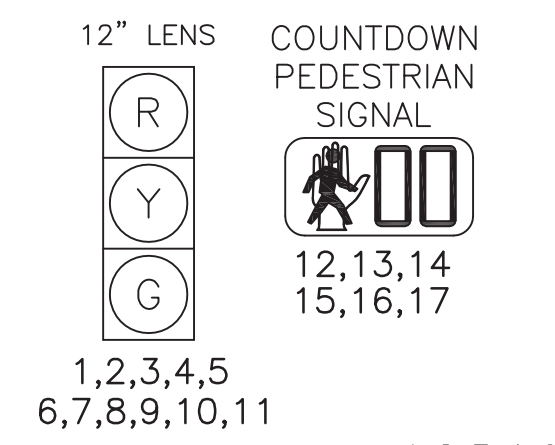

SIGNALS TO BE EQUIPPED WITH TUNNEL VISORS 1,2,3,4,6,7,9,10
 SIGNALS TO BE EQUIPPED WITH TUNNEL VISORS & LOUVERS

LEGEND

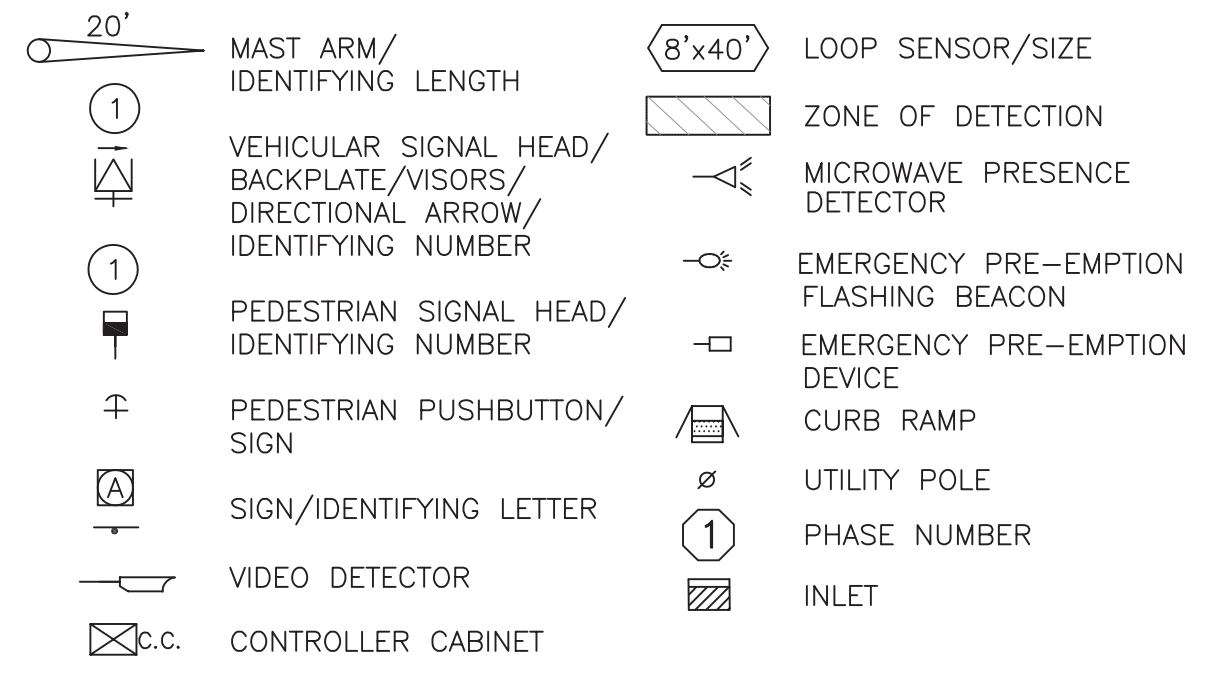

SCALE



PENNSYLVANIA DEPARTMENT OF TRANSPORTATION
 ENGINEERING DISTRICT 6-0
 COUNTY: MONTGOMERY
 MUNICIPALITY: UPPER DUBLIN TOWNSHIP
 INTERSECTION: VIRGINIA DRIVE & CAMP HILL ROAD

Kevin P. Lewis DATE 12/6/21
 MUNICIPAL OFFICIAL
 RECOMMENDED: Kevin P. Lewis, P.E. Digitally signed by Kevin P. Lewis, P.E. Date: 2022.01.14 10:50:02 -0500
 Paul M. Lutz Digitally signed by Paul M. Lutz Date: 2022.01.25 11:13:11 -0500
 DISTRICT TRAFFIC ENGINEER

NO.	REVISION	DES./REVW.	DATE	REVW.	DATE	RECOM.	DATE
1							
2							
3							
4							
5							
6							
7							
8							

EMERGENCY PRE-EMPTION PHASING

PHASE	2			6			4			8		
SIGNALS	9	10	11	12	13	14	15	16	17	18	19	20
1,2	G	Y	R	R	R	R	R	R	R	R	R	R
3,4,5	R	R	R	G	Y	R	R	R	R	R	R	R
6,7,8	R	R	R	R	R	R	G	Y	R	R	R	R
9,10,11	R	R	R	R	R	R	R	R	R	G	Y	R
12,13	H	H	H	H	H	H	H	H	H	H	H	H
14,15	H	H	H	H	H	H	H	H	H	H	H	H
16,17	H	H	H	H	H	H	H	H	H	H	H	H
FIXED TIME	**	4	2	**	4	2	**	4	3	**	4	3

** FOR DURATION OF PRE-EMPTION

NOTE: IF PRE-EMPTION EQUIPMENT HAS ENCODING CAPABILITIES FOR VEHICLE IDENTIFICATION, IT IS RECOMMENDED TO HAVE THE ZERO "00" FEATURE ON TO GIVE UNCODED EMITTERS THE ABILITY TO ACTIVATE THE EMERGENCY PRE-EMPTION.

Ⓞ SIGNAL TO INDICATE G WHEN RETURNING TO NORMAL OPERATION
EMERGENCY PRE-EMPTION NOTES:

CONTROLLER TO BE EQUIPPED WITH EMERGENCY PRE-EMPTION FOR ALL FOUR APPROACHES TO THE INTERSECTION WITH A FAIL SAFE DEVICE FOR EACH DIRECTION OF OPERATION.

THIS EMERGENCY BEACON SHALL CONSIST OF A FLASHING WHITE FLOOD LIGHT, AND SHALL FLASH WHEN THE EMERGENCY VEHICLE HAS CONTROL OF THE INTERSECTION FOR THE APPROPRIATE APPROACH.

THE SIGNALS, WHEN ACTIVATED BY AN EMERGENCY VEHICLE, SHALL TERMINATE ALL GREEN INDICATIONS IMMEDIATELY, FOLLOWED BY THE COMPLETE YELLOW AND RED CLEARANCE INTERVALS. ONLY THE PHASE NOT POSING A YELLOW TRAP CONDITION MAY REMAIN GREEN (PHASE 2+6) WHEN GOVERNED BY APPROACHING EMERGENCY VEHICLE.

THE SIGNALS, WHEN ACTIVATED BY AN EMERGENCY VEHICLE, SHALL TIME OUT ALL YELLOW AND RED INDICATIONS, FOLLOWED BY THE GREEN INTERVAL OF THE PRE-EMPTION PHASE GOVERNED BY THE THE APPROACHING EMERGENCY VEHICLE.

IF THE SIGNAL HAS BEEN ACTUATED BY A PEDESTRIAN PUSHBUTTON, AND THE SIGNAL IS PRE-EMPTED DURING THE "MAN" INTERVAL, THE "MAN" INTERVAL SHALL TERMINATE IMMEDIATELY, FOLLOWED BY THE "FLASHING HAND" INDICATION IN ITS ENTIRETY, FOLLOWED BY THE APPROPRIATE SELECTIVE CLEARANCES BEFORE PROCEEDING TO THE PRE-EMPTION PHASE.

IF THE SIGNALS, WHEN ACTIVATED BY AN EMERGENCY VEHICLE, ARE FLASHING ALL SIGNALS SHALL REMAIN FLASHING.

IF ADDITIONAL PRE-EMPTION PHASES ARE ACTIVATED WHILE IN PRE-EMPTION, THE ORIGINAL PRE-EMPTION PHASE SHALL TIME OUT BEFORE PROCEEDING TO THE NEXT PRE-EMPTION PHASE.

UPON COMPLETION OF PRE-EMPTION PHASE 2, 6, 4, OR 8, IN RETURNING TO NORMAL OPERATION, PHASE 2+6 INTERVAL 1 SHALL FOLLOW.

IN EMERGENCY PRE-EMPTION, NO PRIORITY SHALL BE ESTABLISHED, PRE-EMPTION SHALL BE A "FIRST COME, FIRST SERVE" OPERATION.

LOCATION OF EMERGENCY VEHICLE DETECTORS ARE TO BE FIELD ADJUSTED TO ACHIEVE MAXIMUM OPERATION.

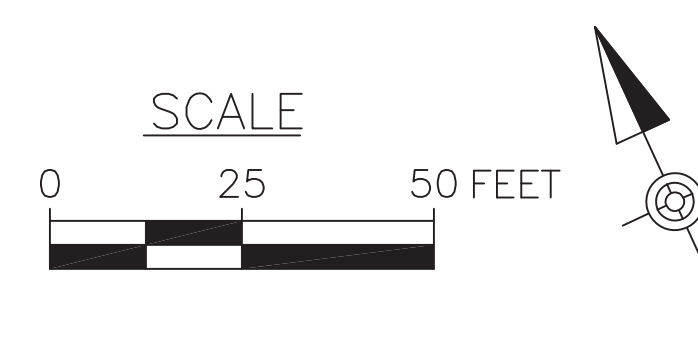
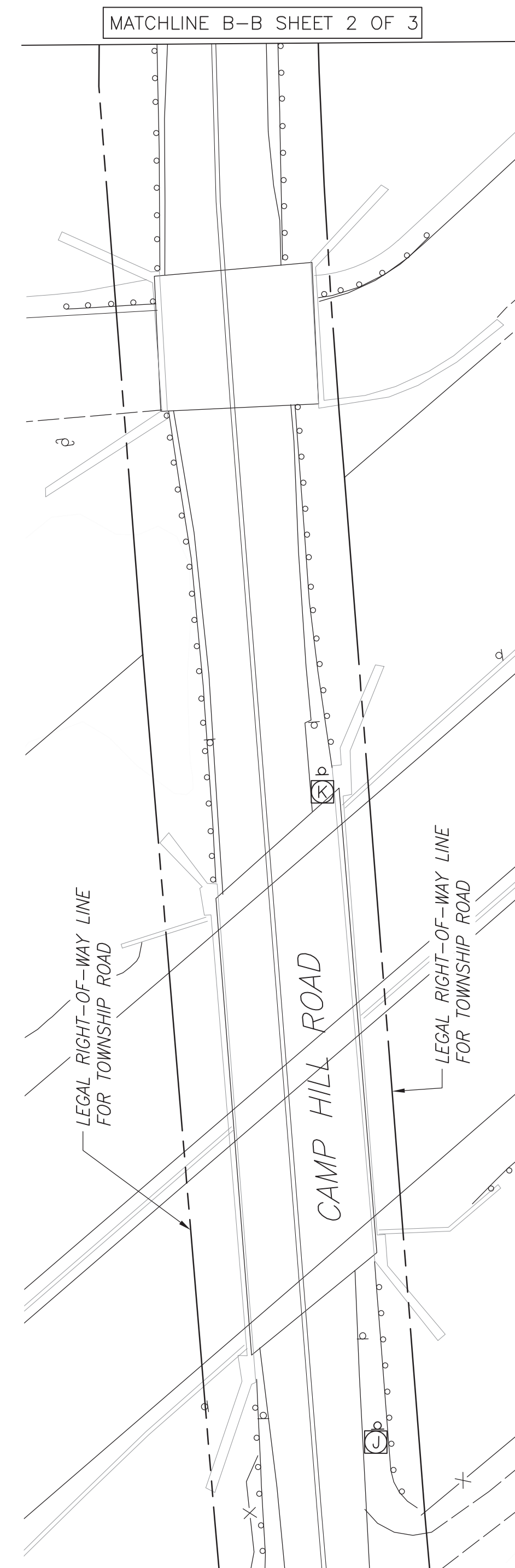
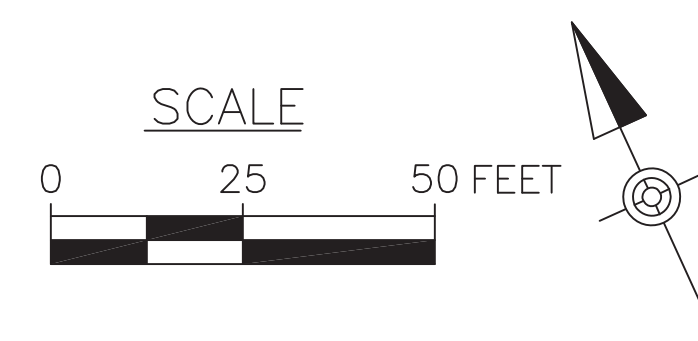
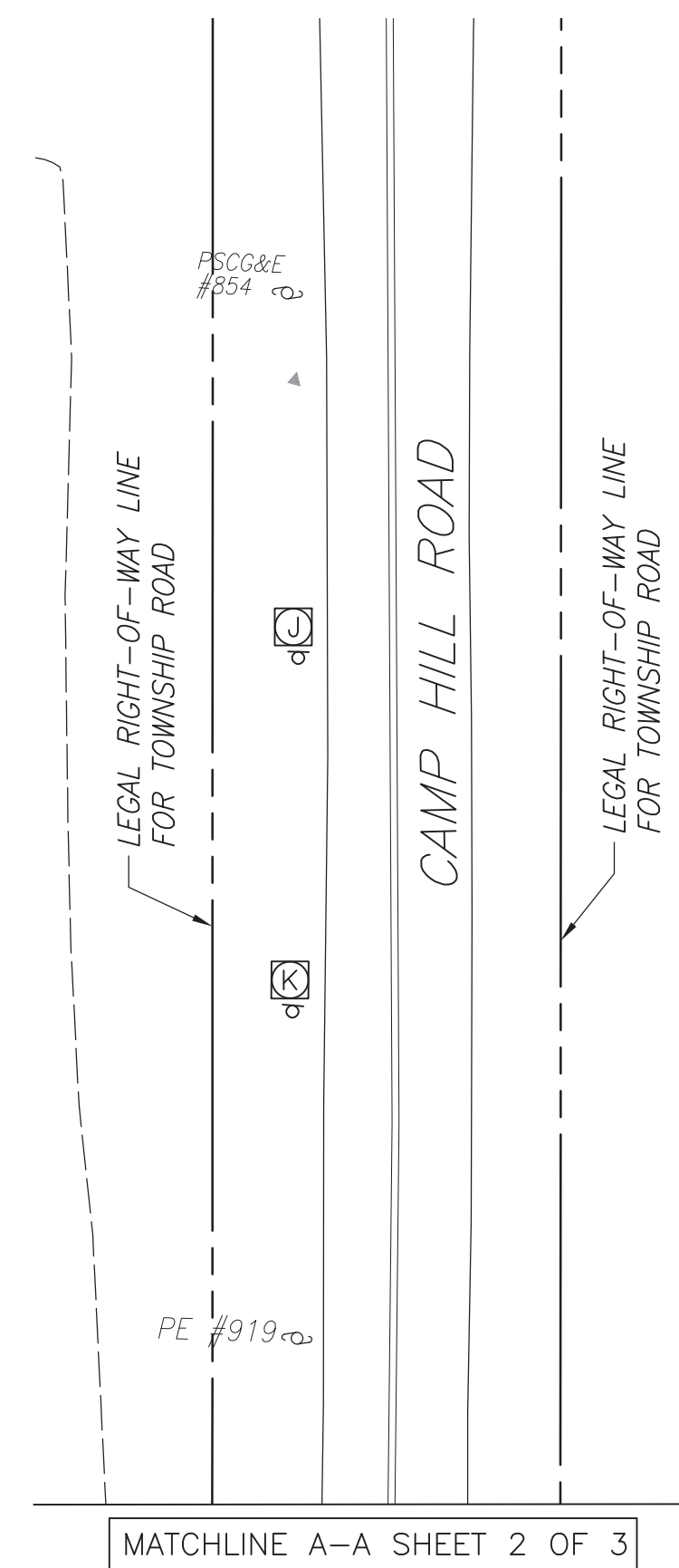
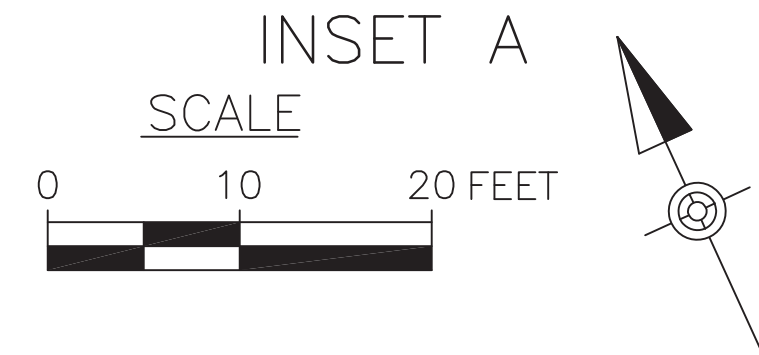
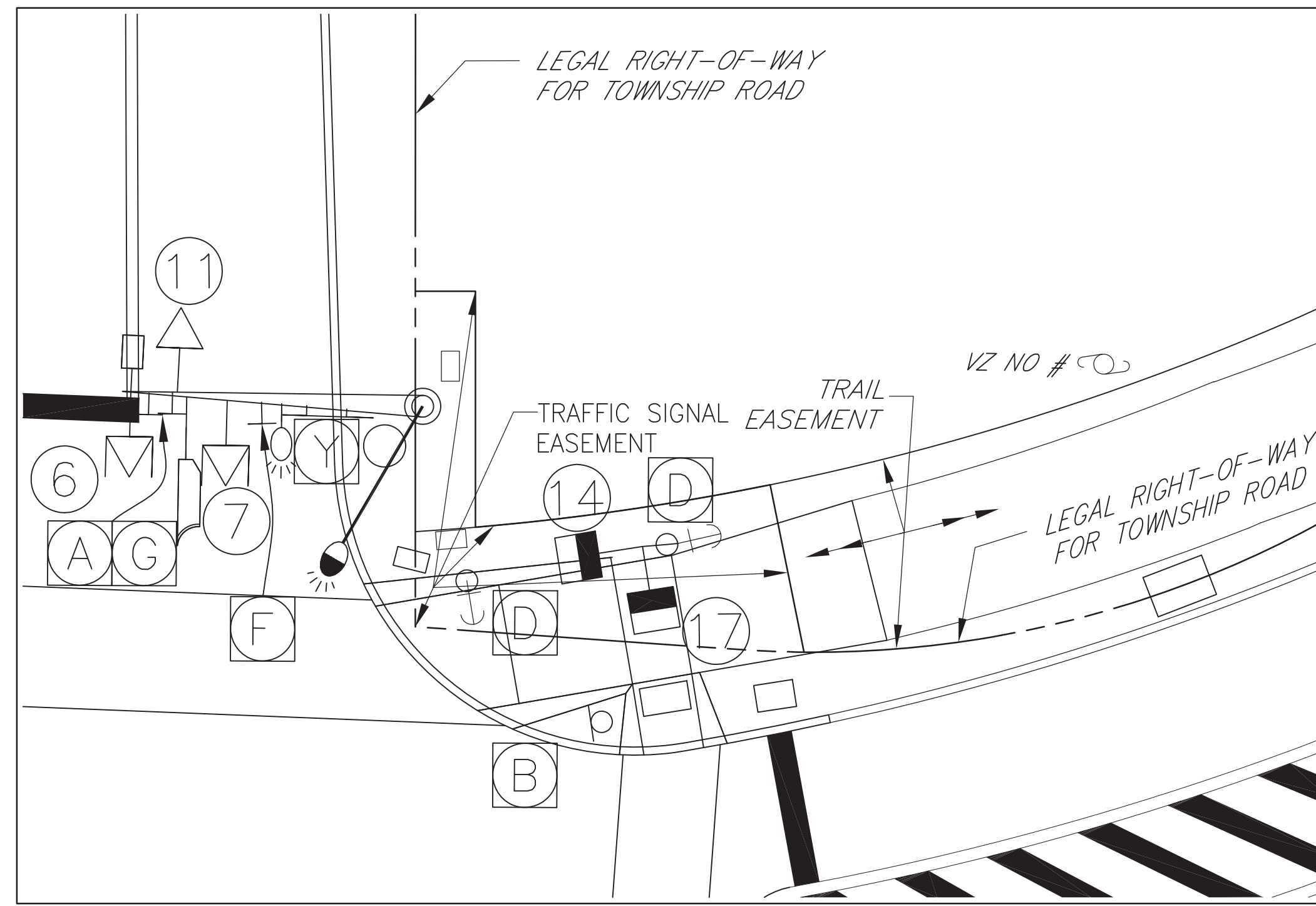

GENERAL NOTES

NO MODIFICATIONS OF THIS INSTALLATION ARE PERMITTED UNLESS PRIOR APPROVAL IS GRANTED IN WRITING BY A REPRESENTATIVE OF THE DEPARTMENT OF TRANSPORTATION.

ALL MAINTENANCE WORK INCLUDING TRIMMING OF TREES, NECESSARY FOR PROPER VISIBILITY OF THE SIGNALS IS THE RESPONSIBILITY OF THE PERMITTEE.

ALL SIGNS AND PAVEMENT MARKINGS INDICATED ON THIS DRAWING ARE CONSIDERED PART OF THE PERMIT AND SHALL BE INSTALLED AND MAINTAINED IN ACCORDANCE WITH PUBLICATION NO. 212.

POST MOUNTED SIGNALS SHALL BE INSTALLED WITH THE SIGNAL HEADS A MINIMUM OF 2 FEET BEHIND THE FACE OF CURB OR THE EDGE OF THE SHOULDER. SUPPORT POLES FOR OVERHEAD SIGNALS SHALL ALSO HAVE A MINIMUM CLEARANCE HORIZONTALLY OF 2 FEET.

SIGNALS ERECTED OVER THE ROADWAY SHALL HAVE A MINIMUM VERTICAL CLEARANCE OF 16 FT. ABOVE THE ROADWAY. POST MOUNTED SIGNALS SHALL BE A MINIMUM OF 8 FT. ABOVE THE SIDEWALK OR PAVEMENT.

ALL OVERHEAD SIGNALS MUST BE RIGIDLY MOUNTED, TOP AND BOTTOM, AND EQUIPPED WITH BACKPLATES.

THE MINIMUM HORIZONTAL DISTANCE BETWEEN SIGNALS MEASURED AT RIGHT ANGLES TO THE APPROACH SHALL BE 8 FEET.

EXACT LOCATION OF DETECTORS SHALL BE DETERMINED PRIOR TO INSTALLATION BY A REPRESENTATIVE OF PENNDOT.

CURBING TO BE INSTALLED BY MUNICIPALITY AND WHERE NOTED, SHALL BE PLAIN CEMENT CONCRETE CURB OR GRANITE CURB, INSTALLED IN ACCORDANCE WITH DEPARTMENT SPECIFICATIONS FORM 408.

PRIOR TO INSTALLATION THE CONTRACTOR SHALL CONSULT WITH THE LOCAL OFFICIALS AND UTILITY COMPANIES TO RESOLVE ANY PROBLEMS WHICH MAY BE CREATED DUE TO THE LOCATION OF UTILITIES.

THIS DRAWING CANNOT BE USED AS A CONSTRUCTION DRAWING UNLESS THE PERMITTEE COMPLIES WITH THE PROVISIONS OF ACT 287, PREVENTION OF DAMAGE TO UNDERGROUND UTILITIES, EFFECTIVE DATE DECEMBER 20, 1974.

WHEN LIQUID FUELS MONEY IS USED, SIGNAL INSTALLATION MUST CONFORM TO FORM 408 AND A COPY OF THE PROPOSED SPECIFICATIONS MUST BE SUBMITTED TO THE DISTRICT TRAFFIC UNIT, FOR REVIEW, PRIOR TO BIDDING.

PERMITTEE SHALL OBTAIN A HIGHWAY OCCUPANCY PERMIT FOR ANY CHANGES IN INTERSECTION GEOMETRY REGARDING EXCAVATION.

CONDUIT INSTALLED IN BITUMINOUS ROADWAY LESS THAN 5 YEARS OLD, OR CONCRETE ROADWAY REGARDLESS OF AGE, MUST BE BORED OR JACKED UNDER THE ROADWAY. INSTALL IN ACCORDANCE WITH TRAFFIC SIGNAL STANDARDS TC-8800 SERIES.

PENNSYLVANIA DEPARTMENT OF TRANSPORTATION
ENGINEERING DISTRICT 6-0

COUNTY: MONTGOMERY

MUNICIPALITY: UPPER DUBLIN TOWNSHIP

INTERSECTION: VIRGINIA DRIVE &
CAMP HILL ROAD

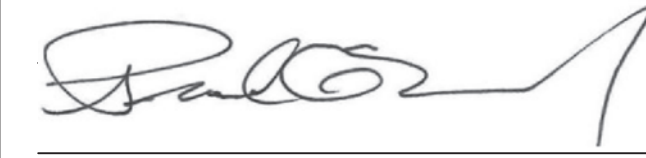
 DATE 12/6/21
MUNICIPAL OFFICIAL DATE

RECOMMENDED: Kevin P. Lewis, P.E. Digitally signed by Kevin P. Lewis, P.E. Date: 2022.01.25 16:38:29 -05'00'

Paul M. Lutz Digitally signed by Paul M. Lutz Date: 2022.01.25 11:13:37 -05'00'

DISTRICT TRAFFIC ENGINEER DATE

NO.	REVISION	DES./REVW.	DATE	REVW.	DATE	RECOM.	DATE
1							
2							
3							
4							
5							
6							
7							
8							

SHEET 3 OF 3 PERMIT # 64-1577 FILE # 1577

TRACED BY _____ FINAL BY _____